

Parts List					Parts List				
Item	Part Code	QTY.	Part No./File Name	Description	Item	Part Code	QTY.	Part No./File Name	Description
1	76652	1	9-4001	Wire Anvil	69	72069	2	McMaster Carr #98407A118	#8 E-Style Retaining Ring
2	76651	1	9A-4001	Insulation Anvil	70	71013	1	LC-014A-1-M	Compression Spring
3	76655	1	13-4001	Wire Rolling Tool	71	72315	1	LC-022A-4	Compression Spring
4	76654	1	14-4003	Insulation Rolling Tool (Overlap)	72	78681	2	LC-029B-3-M	Compression Spring
5	73888	2	GS-125	Guard Spacer	73	74611	1	LE-037CD-6	Extension Spring
6	71494	1	MX2A-S-1	Mounting Frame	74	70739	2	McMaster-Carr #3126A53	Spring Plunger
7	71030	1	MX2B-S	Plunger Frame	75	74447	1	McMaster-Carr #98296A109	Expansion Pin (1/16 x 1/2")
8	74343	1	MX3	Ram	76	72352	3	Pisco PL250-N1U	Ø1/4" x 1/8-NPT Elbow Fitting, White
9	74438	1	MX5-S	Cam Rack	77	63200	2	Truarc #5555-12	Retaining Ring
10	74346	1	MX6-1	Gear Arm	78	63201	2	Vlier #PH-51-P	Spring Plunger
11	74347	1	MX7	Cam Pin	79	63202	2	4lw	#4 Lock Washer
12	74350	1	MX8	Cam Roller	80	63203	2	4-40_.13bh	#4-40 x 1/8" Button Hd Cap Screw
13	74351	2	MX10-S	Rack Pad	81	63204	2	4-40_.16sh	#4-40 x 5/32" Socket Hd Cap Screw
14	74352	2	MX11	Gib	82	63205	1	1.8_.38rp	Ø 1/8" x 3/8" Roll Pin
15	74356	1	MX12	Feed Finger Pivot Pin	83	63053	2	1.8_.63rp	1/8" x 5/8" Roll Pin
16	74360	1	MX13	Adjusting Bar	84	62040	1	1.8_1.00rp	1/8" x 1" Roll Pin
17	76868	1	MX14-1-S	Feed Finger Arm	85	63206	2	5-40_.19ssf	#5-40 x 3/16" Socket Set Screw
18	76874	1	MX15-1-S	Feed Finger Guide	86	63207	5	6-32_.25sh	#6-32 x 1/4" Socket Hd Cap Screw
19	74364	1	MX16	Retainer	87	63208	1	6-32_.25ssf	#6-32 x 1/4" Socket Hd Set Screw
20	71495	1	MX18-S-1	Swing Arm	88	63209	4	6-32_.38sh	#6-32 x 3/8" Socket Hd Cap Screw
21	74376	1	MX25	Stroke Adjustment Screw	89	63057	2	6-32_.50fh	#6-32 x 1/2" Flat Hd Cap Screw
22	74407	1	MX33	Mounting Post	90	63210	2	8fw	#8 Flatwasher
23	74409	1	MX35	Insulation Dial	91	63211	2	8-32_.13ssf	#8-32 x 1/8" Socket Hd Set Screw
24	74411	1	MX36	Dial Spacer	92	63212	1	8-32_.25bh	#8-32 x 1/4" Button Hd Cap Screw
25	74412	1	MX44	Locating Dowel	93	63052	2	8-32_.50fh	#8-32 x 1/2" Flat Hd Cap Screw
26	74415	1	MX45-S	Feed Finger Spring	94	63164	2	8-32_.50sh	#8-32 x 1/2" Socket Hd Cap Screw
27	74419	3	MX50	Safety Pivot Pin	95	63162	2	8-32_.63sh	#8-32 x 5/8" Socket Hd Cap Screw
28	71493	2	MX52-S-1	Pivot Pin	96	63213	1	8-32_1.00sh	#8-32 x 1" Socket Hd Cap Screw
29	74614	1	MX90-S	Spring Bracket	97	63158	4	3.16_.50dp	Ø 3/16" x 1/2" Dowel Pin
30	72310	1	MX104	Wave Disc Spring	98	63470	12	3.16_.75dp	Ø 3/16" x 3/4" Dowel Pin
31	71678	1	MX105-S	Pivot Pin Plate	99	78517	2	10lw	#10 Lockwasher
32	70606	1	MX301-11-ITD-S	Latching Gate	100	63531	2	10-24_.38bh	#10-24 x 3/8" Button Hd Cap Screw
33	72261	1	MX302-1-ITD-S	Base Plate	101	78687	2	10-32_.25bh	#10-32 x 1/4" Button Hd Cap Screw
34	76563	2	MX304-ITD-S	Hinge Pin	102	78327	1	10-32_.13bh	#10-32 x 1/8" Button Hd Cap Screw
35	76564	2	MX305-ITD-S	Pin	103	63054	2	10-32_.25ss	#10-32 x 1/4" Socket Hd Set Screw
36	78613	1	MX306-2-ITD-S	Insulation Pusher	104	78993	8	10-32_.38bh	#10-32 x 3/8" Button Hd Cap Screw
37	76566	1	MX307-ITD-S	Stock Chute	105	70110	1	10-32_.38sh	#10-32 x 3/8" Socket Hd Cap Screw
38	76567	1	MX308-ITD-S	Latch Pivot Pin	106	63056	4	10-32_.38ssf	#10-32 x 3/8" Socket Hd Set Screw
39	78936	1	MX309-4-ITD-S	Cut-off Keeper	107	63056	2	10-32_.50sh	#10-32 x 1/2" Socket Hd Cap Screw
40	72257	1	MX310-1-ITD-S	Die Holder	108	76501	4	10-32_.50bh	#10-32 x 1/2" Button Hd Cap Screw
41	76571	1	MX312-ITD-S	Left Feed Shim (3/16" Terminal)	109	70293	1	10-32_.63sh	#10-32 x 5/8" Socket Hd Cap Screw
42	76573	1	MX314-ITD-S	Catch	110	63532	2	10-32_.75sh	#10-32 x 3/4" Socket Hd Cap Screw
43	76574	1	MX315-ITD-S	Insulation Tool Spacer	111	63827	2	1.4_.50dp	Ø 1/4" x 1/2" Dowel Pin
44	76575	2	MX316-ITD-S	Latch Spring	112	63632	3	1.4-20_.50bh	1/4-20 x 1/2" Button Hd Cap Screw
45	76576	1	MX317-ITD-S	Base Plate Spacer	113	63055	1	5.16-18_1.00bh	5/16-18 x 1" Button Hd Cap Screw
46	76578	1	MX319-ITD-S	Knock off	114	71086	1	5.16-24_.75ssf	5/16-24 x 3/4" Socket Hd Set Screw
47	76579	1	MX320-ITD-S	Brake	115	61956	1	MX34-H-1	Wire Crimp Dial
48	76580	1	MX321-ITD-S	Brake Actuator	116	72350	1	LC-047D-11-M	Compression Spring
49	76583	1	MX324-ITD-S	Cut-off Pad Pusher	117	73222	1	Pisco PC250-N1U	1/4" x 1/8" NPT Straight
50	71014	1	MX326-8-ITD-S	Cut-off Pad	118	61993	1	MX358-2-ITD-S	Valve Mounting Plate
51	76586	1	MX327-ITD-S	Left Feed Rail	119	1.2isw	1	1.2isw	1/2" Internal Star Washer
52	76587	1	MX328-ITD-S	Hold Down Spring	120	72318	1	Clippard MJV-3	3-Way Valve
53	76588	1	MX329-ITD-S	Right Feed Rail	121	15.32_32 hex nut	1	15.32_32 hex nut	Hex Nut
54	78938	1	MX330-1-ITD-S	Feed Plate	122	72317	1	Clippard #12296	Cam Follower
55	76590	1	MX331-ITD-S	Latch (Automatic)					
56	76591	1	MX332-ITD-S	Support					
57	76593	1	MX334-ITD-S	Latch/Wire Stop					
58	76608	1	MX335-ITD-S	Cam					
59	76661	1	MX337-ITD-S	Feed Finger					
60	72233	1	MX338-1-ITD-S	Arm Switch Cam (1 1/8" Stroke)					
61	70745	1	MX339-ITD-S	Guard					
62	72260	1	MX344-1-ITD-S	Leaf Spring					
63	72099	1	MX348-ITD-S	.550 Strike Slide Cylinder					
64	72893	1	MX357-ITD-S	Bracket					
65	78733	1	MX358-1-ITD-S	Valve Mounting Plate					
66	78835	1	MX360-ITD-S	Scrap Retainer					
67	78568	1	MX361-13-ITD-S	Pivot Gate (Ø.055-Ø.075 Insulation)					
68	71008	1	MX362-ITD-S	Pivot Gate Pin					

NOTE: ITEMS MARKED IN BOLD TEXT ARE HIGH WEAR ITEMS

- NOTE:**
- (1) Items marked in bold text are high wear items.
 - (2) Use OEM replacement tooling only.
 - (3) Recommended machine speed for automatic equipment is a maximum of 3500 parts per hour.

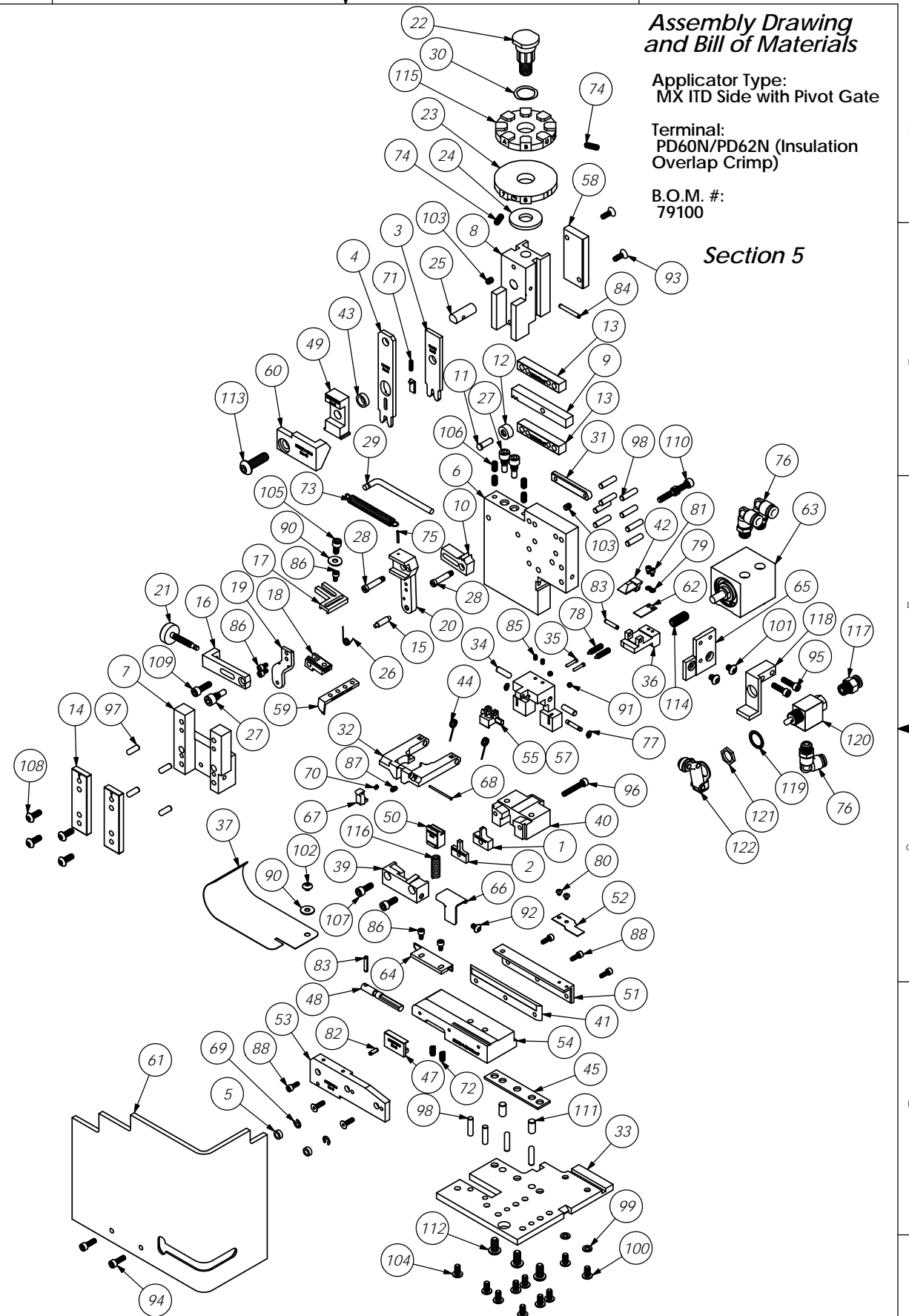

Assembly Drawing and Bill of Materials

Applicator Type:
MX ITD Side with Pivot Gate

Terminal:
PD60N/PD62N (Insulation Overlap Crimp)

B.O.M. #:
79100

Section 5

ITEM NO.	PART NO.	DESCRIPTION	MATERIAL SPECIFICATION	QTY.	REVISION
		DO NOT SCALE DRAWINGS UNLESS OTHERWISE SPECIFIED DIMENSIONS ARE IN INCHES. DECIMALS ARE ANGLES FRACTIONS: DECIMALS ANGLES 1/64 .001 1/32 .002 1/16 .003 3/32 .005 1/8 .008 1/4 .015 3/8 .023 1/2 .031 5/8 .039 3/4 .047 7/8 .055 1 .063 1 1/8 .071 1 1/4 .079 1 1/2 .087 1 3/4 .095 2 .103 2 1/4 .111 2 1/2 .119 2 3/4 .127 3 .135 3 1/4 .143 3 1/2 .151 3 3/4 .159 4 .167 4 1/4 .175 4 1/2 .183 4 3/4 .191 5 .199 5 1/4 .207 5 1/2 .215 5 3/4 .223 6 .231 6 1/4 .239 6 1/2 .247 6 3/4 .255 7 .263 7 1/4 .271 7 1/2 .279 7 3/4 .287 8 .295 8 1/4 .303 8 1/2 .311 8 3/4 .319 9 .327 9 1/4 .335 9 1/2 .343 9 3/4 .351 10 .359 10 1/4 .367 10 1/2 .375 10 3/4 .383 11 .391 11 1/4 .399 11 1/2 .407 11 3/4 .415 12 .423 12 1/4 .431 12 1/2 .439 12 3/4 .447 13 .455 13 1/4 .463 13 1/2 .471 13 3/4 .479 14 .487 14 1/4 .495 14 1/2 .503 14 3/4 .511 15 .519 15 1/4 .527 15 1/2 .535 15 3/4 .543 16 .551 16 1/4 .559 16 1/2 .567 16 3/4 .575 17 .583 17 1/4 .591 17 1/2 .599 17 3/4 .607 18 .615 18 1/4 .623 18 1/2 .631 18 3/4 .639 19 .647 19 1/4 .655 19 1/2 .663 19 3/4 .671 20 .679 20 1/4 .687 20 1/2 .695 20 3/4 .703 21 .711 21 1/4 .719 21 1/2 .727 21 3/4 .735 22 .743 22 1/4 .751 22 1/2 .759 22 3/4 .767 23 .775 23 1/4 .783 23 1/2 .791 23 3/4 .799 24 .807 24 1/4 .815 24 1/2 .823 24 3/4 .831 25 .839 25 1/4 .847 25 1/2 .855 25 3/4 .863 26 .871 26 1/4 .879 26 1/2 .887 26 3/4 .895 27 .903 27 1/4 .911 27 1/2 .919 27 3/4 .927 28 .935 28 1/4 .943 28 1/2 .951 28 3/4 .959 29 .967 29 1/4 .975 29 1/2 .983 29 3/4 .991 30 .999 30 1/4 .1007 30 1/2 .1015 30 3/4 .1023 31 .1031 31 1/4 .1039 31 1/2 .1047 31 3/4 .1055 32 .1063 32 1/4 .1071 32 1/2 .1079 32 3/4 .1087 33 .1095 33 1/4 .1103 33 1/2 .1111 33 3/4 .1119 34 .1127 34 1/4 .1135 34 1/2 .1143 34 3/4 .1151 35 .1159 35 1/4 .1167 35 1/2 .1175 35 3/4 .1183 36 .1191 36 1/4 .1199 36 1/2 .1207 36 3/4 .1215 37 .1223 37 1/4 .1231 37 1/2 .1239 37 3/4 .1247 38 .1255 38 1/4 .1263 38 1/2 .1271 38 3/4 .1279 39 .1287 39 1/4 .1295 39 1/2 .1303 39 3/4 .1311 40 .1319 40 1/4 .1327 40 1/2 .1335 40 3/4 .1343 41 .1351 41 1/4 .1359 41 1/2 .1367 41 3/4 .1375 42 .1383 42 1/4 .1391 42 1/2 .1399 42 3/4 .1407 43 .1415 43 1/4 .1423 43 1/2 .1431 43 3/4 .1439 44 .1447 44 1/4 .1455 44 1/2 .1463 44 3/4 .1471 45 .1479 45 1/4 .1487 45 1/2 .1495 45 3/4 .1503 46 .1511 46 1/4 .1519 46 1/2 .1527 46 3/4 .1535 47 .1543 47 1/4 .1551 47 1/2 .1559 47 3/4 .1567 48 .1575 48 1/4 .1583 48 1/2 .1591 48 3/4 .1599 49 .1607 49 1/4 .1615 49 1/2 .1623 49 3/4 .1631 50 .1639 50 1/4 .1647 50 1/2 .1655 50 3/4 .1663 51 .1671 51 1/4 .1679 51 1/2 .1687 51 3/4 .1695 52 .1703 52 1/4 .1711 52 1/2 .1719 52 3/4 .1727 53 .1735 53 1/4 .1743 53 1/2 .1751 53 3/4 .1759 54 .1767 54 1/4 .1775 54 1/2 .1783 54 3/4 .1791 55 .1799 55 1/4 .1807 55 1/2 .1815 55 3/4 .1823 56 .1831 56 1/4 .1839 56 1/2 .1847 56 3/4 .1855 57 .1863 57 1/4 .1871 57 1/2 .1879 57 3/4 .1887 58 .1895 58 1/4 .1903 58 1/2 .1911 58 3/4 .1919 59 .1927 59 1/4 .1935 59 1/2 .1943 59 3/4 .1951 60 .1959 60 1/4 .1967 60 1/2 .1975 60 3/4 .1983 61 .1991 61 1/4 .1999 61 1/2 .2007 61 3/4 .2015 62 .2023 62 1/4 .2031 62 1/2 .2039 62 3/4 .2047 63 .2055 63 1/4 .2063 63 1/2 .2071 63 3/4 .2079 64 .2087 64 1/4 .2095 64 1/2 .2103 64 3/4 .2111 65 .2119 65 1/4 .2127 65 1/2 .2135 65 3/4 .2143 66 .2151 66 1/4 .2159 66 1/2 .2167 66 3/4 .2175 67 .2183 67 1/4 .2191 67 1/2 .2199 67 3/4 .2207 68 .2215 68 1/4 .2223 68 1/2 .2231 68 3/4 .2239 69 .2247 69 1/4 .2255 69 1/2 .2263 69 3/4 .2271 70 .2279 70 1/4 .2287 70 1/2 .2295 70 3/4 .2303 71 .2311 71 1/4 .2319 71 1/2 .2327 71 3/4 .2335 72 .2343 72 1/4 .2351 72 1/2 .2359 72 3/4 .2367 73 .2375 73 1/4 .2383 73 1/2 .2391 73 3/4 .2399 74 .2407 74 1/4 .2415 74 1/2 .2423 74 3/4 .2431 75 .2439 75 1/4 .2447 75 1/2 .2455 75 3/4 .2463 76 .2471 76 1/4 .2479 76 1/2 .2487 76 3/4 .2495 77 .2503 77 1/4 .2511 77 1/2 .2519 77 3/4 .2527 78 .2535 78 1/4 .2543 78 1/2 .2551 78 3/4 .2559 79 .2567 79 1/4 .2575 79 1/2 .2583 79 3/4 .2591 80 .2599 80 1/4 .2607 80 1/2 .2615 80 3/4 .2623 81 .2631 81 1/4 .2639 81 1/2 .2647 81 3/4 .2655 82 .2663 82 1/4 .2671 82 1/2 .2679 82 3/4 .2687 83 .2695 83 1/4 .2703 83 1/2 .2711 83 3/4 .2719 84 .2727 84 1/4 .2735 84 1/2 .2743 84 3/4 .2751 85 .2759 85 1/4 .2767 85 1/2 .2775 85 3/4 .2783 86 .2791 86 1/4 .2799 86 1/2 .2807 86 3/4 .2815 87 .2823 87 1/4 .2831 87 1/2 .2839 87 3/4 .2847 88 .2855 88 1/4 .2863 88 1/2 .2871 88 3/4 .2879 89 .2887 89 1/4 .2895 89 1/2 .2903 89 3/4 .2911 90 .2919 90 1/4 .2927 90 1/2 .2935 90 3/4 .2943 91 .2951 91 1/4 .2959 91 1/2 .2967 91 3/4 .2975 92 .2983 92 1/4 .2991 92 1/2 .2999 92 3/4 .3007 93 .3015 93 1/4 .3023 93 1/2 .3031 93 3/4 .3039 94 .3047 94 1/4 .3055 94 1/2 .3063 94 3/4 .3071 95 .3079 95 1/4 .3087 95 1/2 .3095 95 3/4 .3103 96 .3111 96 1/4 .3119 96 1			