

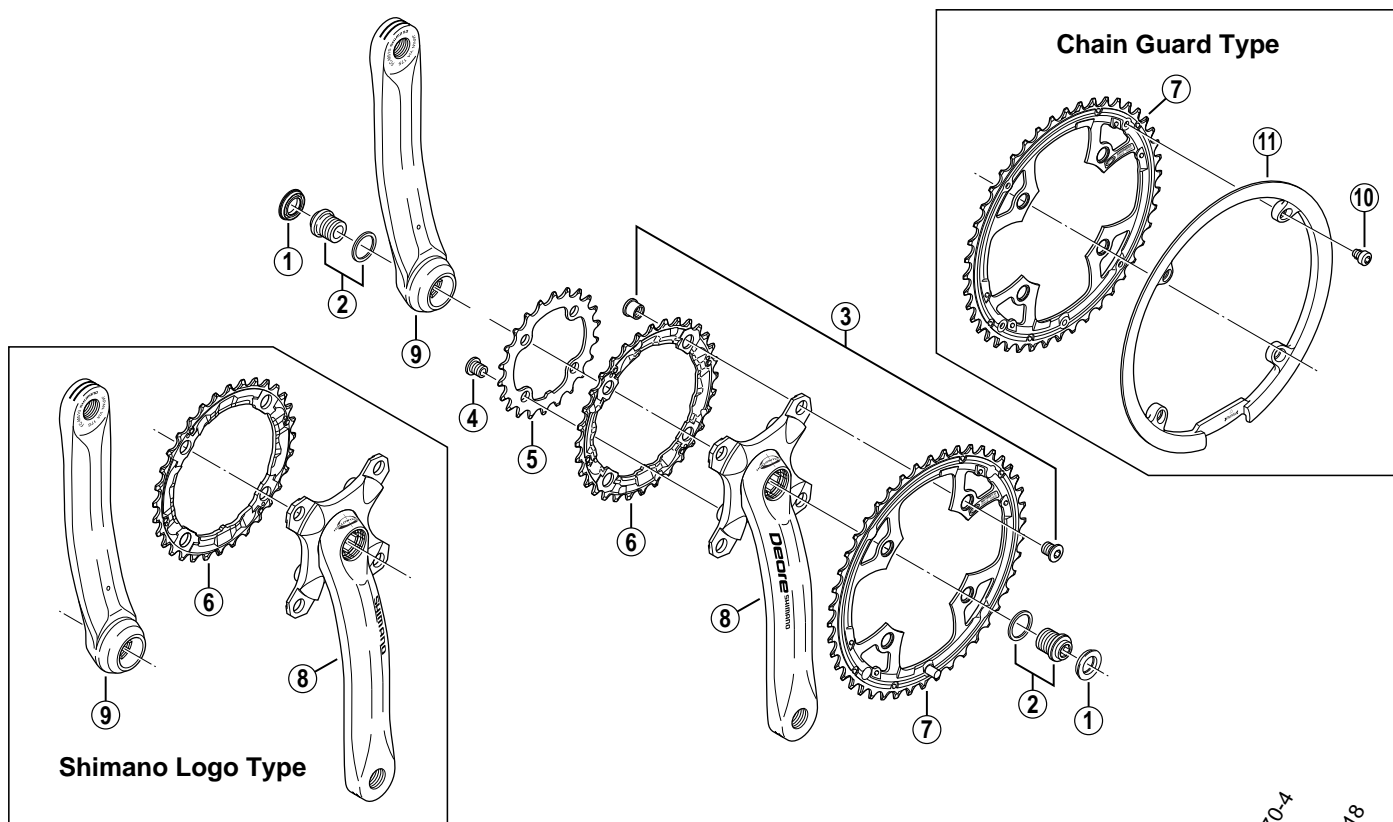

SHIMANO DEORE Front Chainwheel (Black Version)

FC-M510-L

FC-M510-LK For Chain Case



• Bolt circle diameter: 104 mm...(For outer gear and middle gear), 64 mm...(For inner gear)

FC-M510-4

FC-MC18

ITEM NO.	SHIMANO CODE NO.	DESCRIPTION	INTERCHANGEABILITY
1	Y-16V 07000	Crank Arm Cap	
2	Y-16V 98010	Crank Arm Fixing Bolt & Washer	
3	Y-1C8 98010	Double Gear Fixing Bolt (M8 x 8.5) & Nut (4 sets)	A
4	Y-1BD 98030	Inner Gear Fixing Bolt (M8 x 8.5 / 4 pcs.)	A A
5	Y-1DJ 22100	Chainring 22T (Silver)	B B
6	Y-1DS 98010	Chainring 32T (Silver)	B
	Y-1C8 93200	Chainring 32T (Silver / Alloy) for Shimano Logo	B
7	Y-1DS 98110	Chainring 44T (Black)	B
	Y-1DS 98120	Chainring 44T (Black) for FC-M510-LK	
	Y-1DS 98130	Chainring 44T (Black) for Chain Guard	B
8	Y-1EN 98070	Right Hand Crank Arm 170 mm (Black)	B
	Y-1EN 98080	Right Hand Crank Arm 170 mm (Black) for Shimano Logo	
	Y-1EN 98090	Right Hand Crank Arm 170 mm (Black) for FC-M510-LK	
	Y-1EN 98100	Right Hand Crank Arm 175 mm (Black)	B
	Y-1EN 98110	Right Hand Crank Arm 175 mm (Black) for Shimano Logo	B
	Y-1EN 98120	Right Hand Crank Arm 175 mm (Black) for FC-M510-LK	
9	Y-1EN 98130	Left Hand Crank Arm 170 mm (Black)	B
	Y-1EN 98140	Left Hand Crank Arm 170 mm (Black) for Shimano Logo	B
	Y-1EN 98150	Left Hand Crank Arm 175 mm (Black)	B
	Y-1EN 98160	Left Hand Crank Arm 175 mm (Black) for Shimano Logo	B
10	Y-1CY 98020	Chain Guard Fixing Bolt (4 pcs.)	A A
11	Y-1C6 18000	Chain Guard	

A : Same parts.

B : Parts are usable, but differ in materials, appearance, finish, size, etc.

Absence of mark indicates non-interchangeability.

0107-2087

Specifications are subject to change without notice.

SHIMANO®



© 2001 by Shimano Inc.



SHIMANO DEORE Front Chainwheel (Silver Version)

FC-M510-s

FC-M510-SK For Chain Case

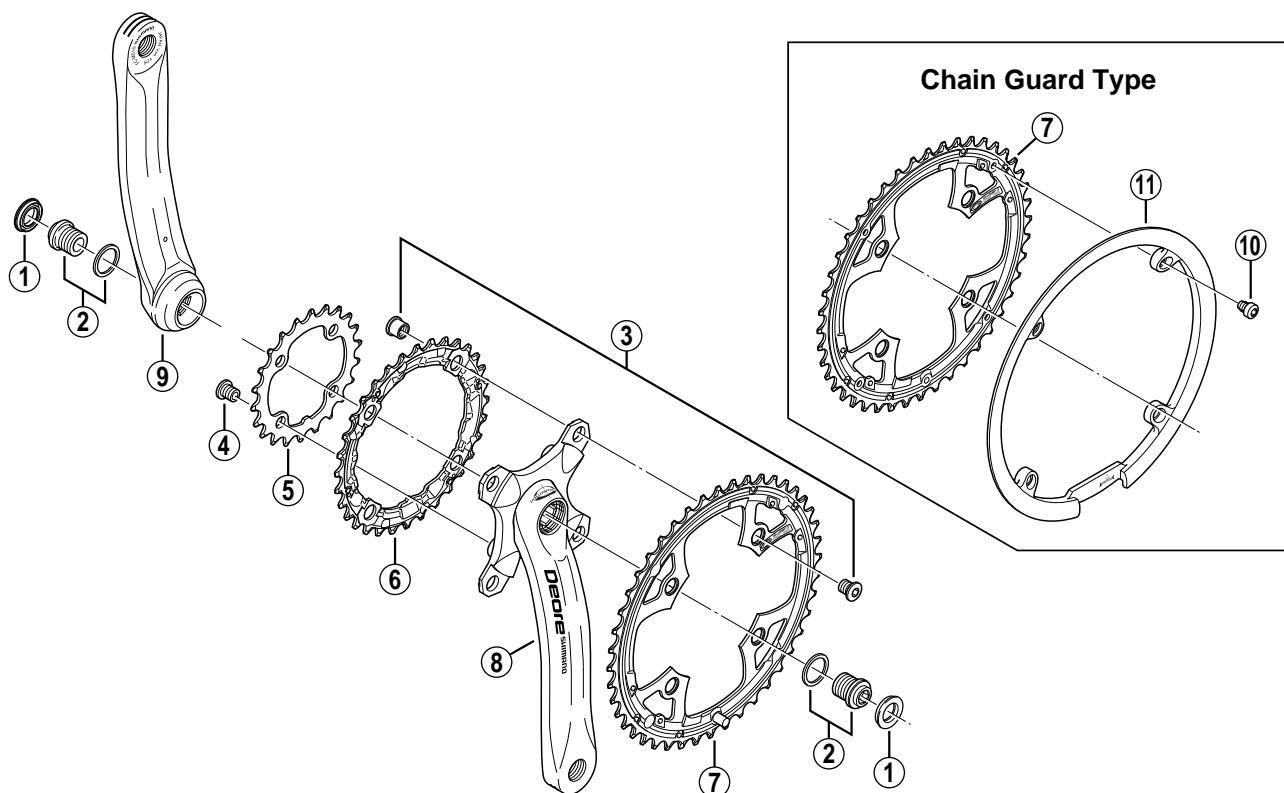

- **Chainring teeth combinations: 44 - 32 - 22T / 48 - 36 - 26T**
- **Bolt circle diameter: 104 mm...(For outer gear and middle gear), 64 mm...(For inner gear)**

FC-M510-4
FC-MC18

ITEM NO.	SHIMANO CODE NO.	DESCRIPTION	INTERCHANGEABILITY
1	Y-16V 07000	Crank Arm Cap	
2	Y-16V 98010	Crank Arm Fixing Bolt & Washer	
3	Y-1C8 98010	Double Gear Fixing Bolt (M8 x 8.5) & Nut (4 sets)	A
4	Y-1BD 98030	Inner Gear Fixing Bolt (M8 x 8.5 / 4 pcs.)	A A
5	Y-1DJ 22100	Chainring 22T (Silver)	B B
	Y-1DS 26000	Chainring 26T (Silver)	
6	Y-1DS 98010	Chainring 32T (Silver)	B
	Y-1DS 98200	Chainring 36T (Silver)	
7	Y-1DS 98020	Chainring 44T (Silver)	B
	Y-1DS 98030	Chainring 44T (Silver) for FC-M510-SK	
	Y-1DS 98040	Chainring 44T (Silver) for Chain Guard	B
	Y-1DS 98210	Chainring 48T (Silver)	
8	Y-1EN 98010	Right Hand Crank Arm 170 mm (Silver)	B
	Y-1EN 98020	Right Hand Crank Arm 170 mm (Silver) for FC-M510-SK	
	Y-1EN 98030	Right Hand Crank Arm 175 mm (Silver)	B
	Y-1EN 98040	Right Hand Crank Arm 175 mm (Silver) for FC-M510-SK	
9	Y-1EN 98050	Left Hand Crank Arm 170 mm (Silver)	B
	Y-1EN 98060	Left Hand Crank Arm 175 mm (Silver)	B
10	Y-1CY 98020	Chain Guard Fixing Bolt (4 pcs.)	A A
	Y-1C6 18000	Chain Guard (for 44T)	
11	Y-1DS 08000	Chain Guard (for 48T)	

A : Same parts.

B : Parts are usable, but differ in materials, appearance, finish, size, etc.

Absence of mark indicates non-interchangeability.

0107-2086

Specifications are subject to change without notice.

© 2001 by Shimano Inc.

SHIMANO®