

SHIMANO ULTEGRA Pedals PD-6600 SPD-R Type

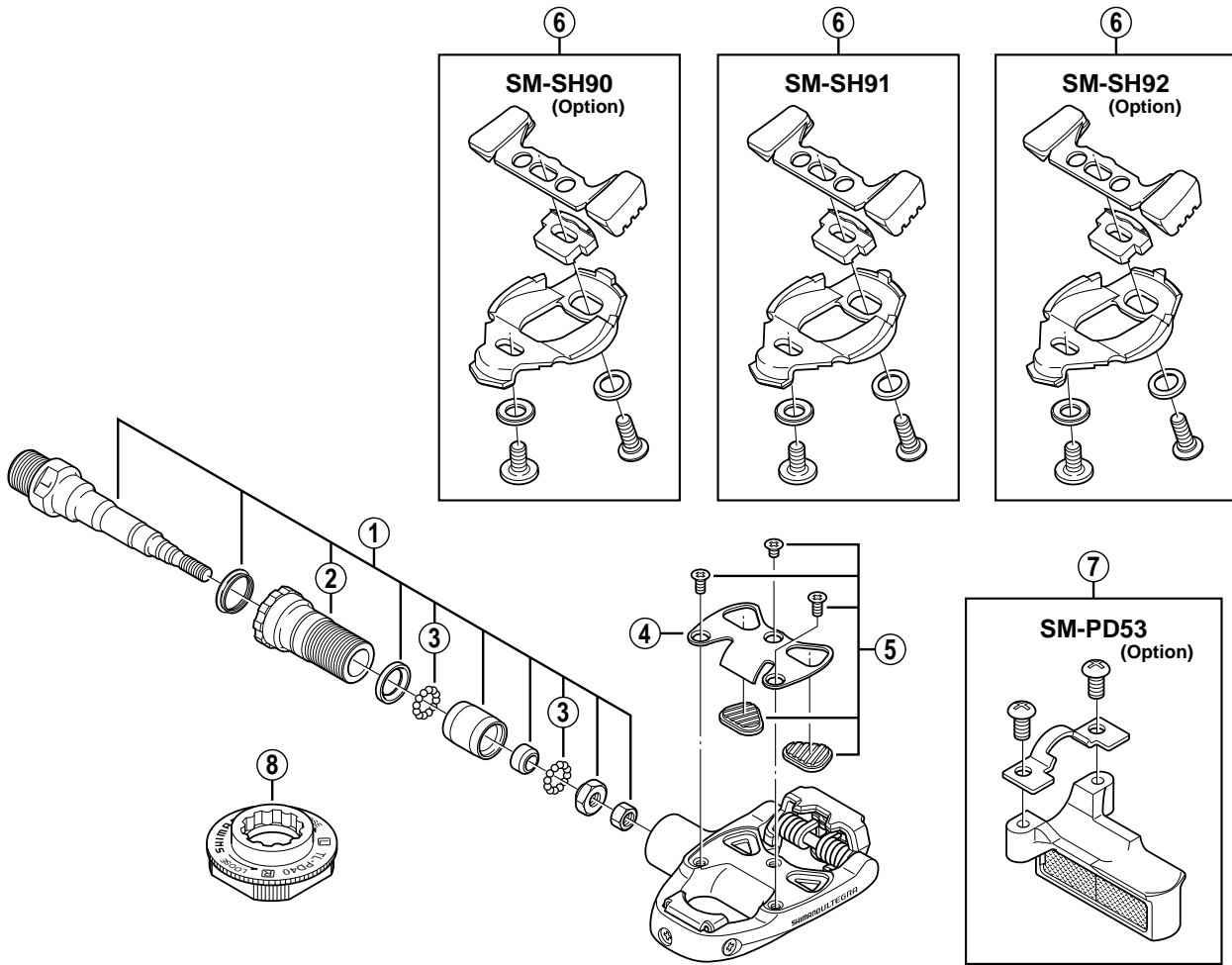

PD-7700
PD-5500

ITEM NO.	SHIMANO CODE NO.	DESCRIPTION	INTERCHANGEABILITY	
1	Y-43Z 98010	Pedal Axle Assembly (Right / B.C.9/16" x 20T.P.I.)	B	
	Y-43Z 98020	Pedal Axle Assembly (Left / B.C.9/16" x 20T.P.I.)	B	
2	Y-43Z 13000	Lock Bolt (Right)	A	
	Y-43Z 14000	Lock Bolt (Left)	A	
3	Y-000 91610	Steel Ball (3/32") 60 pcs.	A	A
4	Y-43Y 03000	Body Cover	B	
5	Y-43Y 98040	Friction Rubber Unit (L / Pair)	A	
	Y-43Y 98050	Friction Rubber Unit (H / Pair)	A	
6	Y-43Y 98010	SM-SH90 Cleat Set (Fixed mode / Pair / Option)	A	A
	Y-43Y 98020	SM-SH91 Cleat Set (Self-aligning mode / 3° / Pair)	A	A
	Y-43Y 98030	SM-SH92 Cleat Set (Self-aligning mode / 5° / Pair / Option)	A	A
7	Y-40R 98020	SM-PD53 Reflector Unit (Pair / Option)	A	
8	Y-42A 09000	TL-PD40 Special Tool	A	

The table indicates the adaptability of conventional parts to PD-6600.

9905-1828A

A : Same parts.

B : Parts are usable, but differ in materials, appearance, finish, size, etc.

Absence of mark indicates non-interchangeability.

Specifications are subject to change without notice.

SHIMANO