

NEXUS 7-Speed Internal Hub SG-C3001-7D

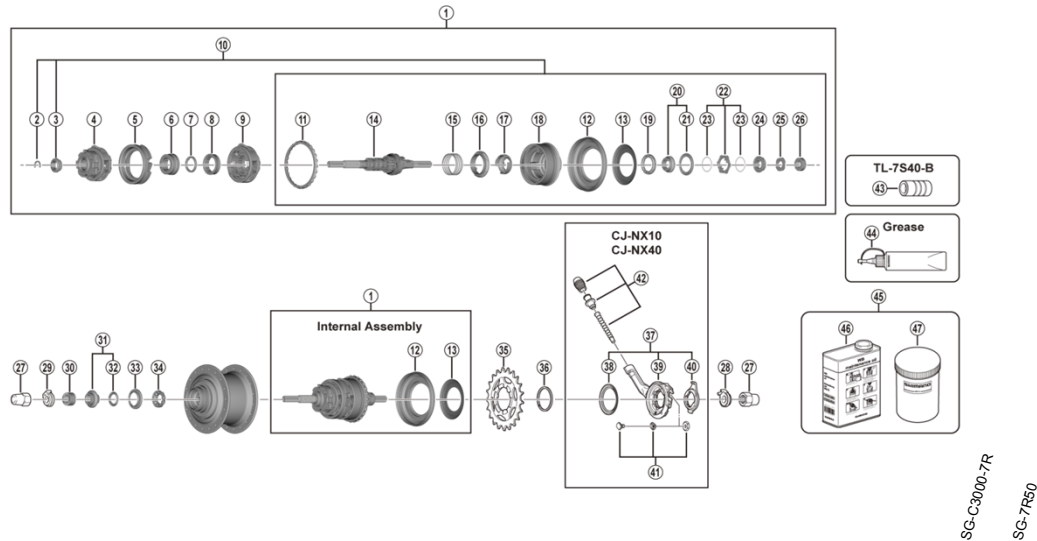

ITEM NO.	SHIMANO CODE NO.	DESCRIPTION	INTERCHANGEABILITY	
1	Y3EW98010	Internal Assembly (Axle Length 187 mm)		
2	Y30807000	Stop Ring for Carrier Guide 2	A	A
3	Y33E03000	Carrier Guide 2	A	A
4	Y3EW98020	Carrier Unit 2		
5	Y38P98040	Ring Gear Unit 2	A	A
6	Y3EV09000	Sun Gear 3		
7	Y38R11000	Sun Gear Guide Ring 2	A	A
8	Y3EV08000	Sun Gear 2		
9	Y38P98050	Carrier Unit 1	A	A
10	Y3EW98030	Carrier Guide 2 / Axle & Driver Unit (Axle Length 187 mm)		
* 11	Y3EV98220	Ball Retainer H (3/16" x 26)		
12	Y35C07000	Right Hand Dust Cap B	A	A
13	Y33Z26000	Right Hand Dust Cap C	A	A
14	Y3EW98040	Axle Unit (Axle Length 187 mm)		
15	Y33024000	Return Spring A	A	A
16	Y33Z10000	Gear Shifting Cam	A	A
17	Y3EV02000	Feed Cam		
18	Y35D98120	Driver Unit	A	A
19	Y33091600	Ball Retainer F (3/16" x 12)	A	A
20	Y39098160	Right Hand Cone w/Seal	A	A
21	Y35K07000	Right Hand Cone Seal	A	A
22	Y33F98040	Driver Plate w/Seal	A	A
23	Y33012000	Driver Plate Seal	A	A
24	Y33E98120	Lock Washer	A	A
25	Y33Z08000	Stop Washer	A	A
26	Y3EW05000	Right Hand Lock Nut		
27	Y31414010	Cap Nut (3/8")	A	A
	Y33Z20500	Non-turn Washer 5R (Yellow)	A	A
28	Y33M39600	Non-turn Washer 6R (Silver)	A	A
	Y33M39700	Non-turn Washer 7R (Black)	A	A
	Y33M39510	Non-turn Washer 5L (Brown)	A	A
29	Y33M39610	Non-turn Washer 6L (White)	A	A
	Y33M39710	Non-turn Washer 7L (Gray)	A	A
30	Y35Z19000	Left Hand Serated Lock Nut (10.7 mm)		
31	Y31L98040	Left Hand Cone w/Dust Cap & Seal Ring		
32	Y37710000	Seal Ring		
33	Y32T08100	Left Hand Inner Dust Cap		
34	Y36U98030	Ball Retainer (7/32" x 9)		
	Y32203220	Sprocket Wheel 16T (Silver)	A	A
	Y32203420	Sprocket Wheel 18T (Silver)	A	A
	Y32203520	Sprocket Wheel 19T (Silver)	A	A
35	Y32203620	Sprocket Wheel 20T (Silver)	A	A
	Y33060000	Sprocket Wheel 21T (Silver)	A	A
	Y33060100	Sprocket Wheel 22T (Silver)	A	A
	Y33060200	Sprocket Wheel 23T (Silver)	A	A
36	Y32120100	Snap Ring C	A	A
	Y74Y98050	CJ-NX10 Cassette Joint Unit	A	A
37	Y74V98010	CJ-NX10 Cassette Joint Unit for Belt drive system		
* 38	Y74Y98100	CJ-NX40 Cassette Joint Unit		
	Y74Y18000	Driver Cap	A	A
	Y74Y93100	CJ-NX10 Cassette Joint	A	A
39	Y74V98020	CJ-NX10 Cassette Joint for Belt drive system		
* 40	Y74Y98090	CJ-NX40 Cassette Joint		
	Y33Z98020	Cassette Joint Fixing Ring	A	A
	Y74Y98030	Inner Cable Fixing Bolt Unit	A	A
* 42	Y74Y98160	Outer Casing Holder Unit for CJ-NX40		
43	Y30889000	TL-7S40-B Right Hand Cone Tool	A	A
44	Y04120800	Internal Hub Grease (Net. 100g)	A	A
45	Y00298010	WB maintenance oil set	A	A
46	Y00201000	WB maintenance oil (1L)	A	A
47	Y00201100	Bottle	A	A
-	Y35D08000	Right Hand Hub Cup		

A: Same parts.

B: Parts are usable, but differ in materials, appearance, finish, size, etc.

Absence of mark indicates non-interchangeability.

Specifications are subject to change without notice.

Dec.-2019-4221B

© Shimano Inc. I