

NEXUS 3-SPEED HUB w/Hi-Power Roller Brake

**SG-3R40** Inter-3 Hub  
**BR-IM31-R** Inter-M Brake

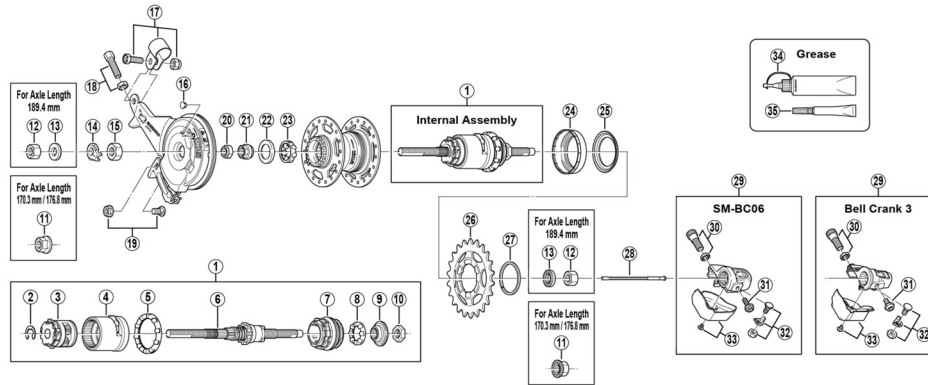

ITEM NO.	SHIMANO CODE NO.	DESCRIPTION
1	Y33S90700	Internal Assembly (Axle Length 170.3 mm)
	Y33S98270	Internal Assembly (Axle Length 176.8 mm)
	Y33S90710	Internal Assembly (Axle Length 189.4 mm)
2	Y33Y19000	Stop Ring ( $\phi$ 9.6 mm)
3	Y33S90400	Carrier Unit
4	Y33S90300	Ring Gear Unit
5	Y33R90220	Ball Retainer K (7/32" x 10)
6	Y33S98040	Axle Unit (Axle Length 170.3 mm)
	Y33S98280	Axle Unit (Axle Length 176.8 mm)
	Y33S98050	Axle Unit (Axle Length 189.4 mm)
7	Y33S90200	Driver Unit
8	Y33R90210	Ball Retainer J (7/32" x 8)
9	Y33R90500	Right Hand Cone w/Dust Seal
10	Y33R08100	Right Hand Lock Nut (5 mm) for Axle Length 170.3 mm / 189.4 mm
	Y32S30100	Right Hand Lock Nut (9.9 mm) for Axle Length 176.8 mm
11	Y22015010	Flange Nut for Axle Length 170.3 mm / 176.8 mm
12	Y32170020	Hub Nut (7 mm) for Axle Length 189.4 mm
	Y20003000	Hub Nut (9 mm) for Axle Length 189.4 mm
13	Y22006000	Washer (2 mm) for Axle Length 189.4 mm
	Y22006040	Washer (3.2 mm) for Axle Length 189.4 mm
14	Y33Z20200	Non-turn Washer 2 (Yellow)
15	Y75V13000	Brake Unit Fixing Nut (8.2 mm) for Axle Length 170.3 mm / 189.4 mm
	Y75V13010	Brake Unit Fixing Nut (9.7 mm) for Axle Length 176.8 mm
* 16	Y75F11000	Grease Hole Cap
	Y75M98050	Brake Arm Clip Unit ( $\phi$ 15 mm)
17	Y33F98090	Brake Arm Clip Unit (5/8")
	Y75M98060	Brake Arm Clip Unit (11/16")
	Y33F98100	Brake Arm Clip Unit (3/4")
18	Y75Y98050	Brake Cable Adjusting Bolt & Nut
19	Y75Y98060	Inner Cable Fixing Bolt & Nut
20	Y31Z06020	Lock Nut for Left Hand Cone
21	Y33M37000	Left Hand Cone
22	Y31Z07000	Left Hand Dust Cap
23	Y32190220	Ball Retainer A (1/4" x 7)
24	Y33R05000	Right Hand Dust Cap A
25	Y33R52001	Right Hand Dust Cap B
26	Y32203200	Sprocket Wheel 16T (Black)
	Y73T21830	Sprocket Wheel 18T (Black)
	Y73T21930	Sprocket Wheel 19T (Black)
	Y73T22030	Sprocket Wheel 20T (Black)
	Y73T22130	Sprocket Wheel 21T (Black)
	Y73T22230	Sprocket Wheel 22T (Black)
Y73T22330	Sprocket Wheel 23T (Black)	
* 27	Y32520110	Snap Ring C
28	Y33R98080	Push Rod (81.85 mm) for Axle Length 170.3 mm
	Y33S98180	Push Rod (86.85 mm) for Axle Length 176.8 mm
	Y33S98290	Push Rod (90.75 mm) for Axle Length 189.4 m
29	Y6P198030	SM-BC06 Bell Crank Unit
	Y33S95100	Bell Crank 3 Unit
30	Y33S98010	Cable Adjusting Bolt & Nut
31	Y33S74000	Bell Crank Body Fixing Bolt for SM-BC06
	Y33S57000	Bell Crank Body Fixing Bolt for Bell Crank 3
32	Y33S98030	Inner Cable Fixing Bolt Unit
33	Y6P198040	Bell Crank Cover & Fixing Screw for SM-BC06
	Y33S98020	Bell Crank Cover & Fixing Screw for Bell Crank 3
34	Y04120800	Internal Hub Grease (Net. 100g)
	Y04120400	Roller Brake Grease (Net. 100g)
35	Y04140020	Roller Brake Grease (Net. 10g)

Feb.-2018-1836C

© Shimano Inc. I

Specifications are subject to change without notice.

**SHIMANO**