

REPRESENTING ARCHITECTURE

Drawings & Diagrams

Summer Studies in Architecture
Parsons the New School 2010



Morphosis
San Francisco Federal Building

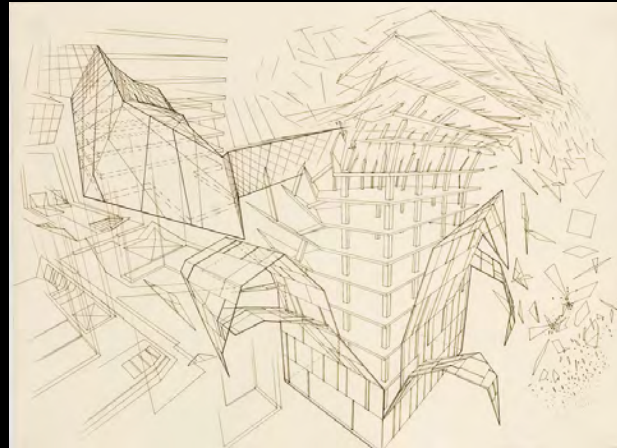
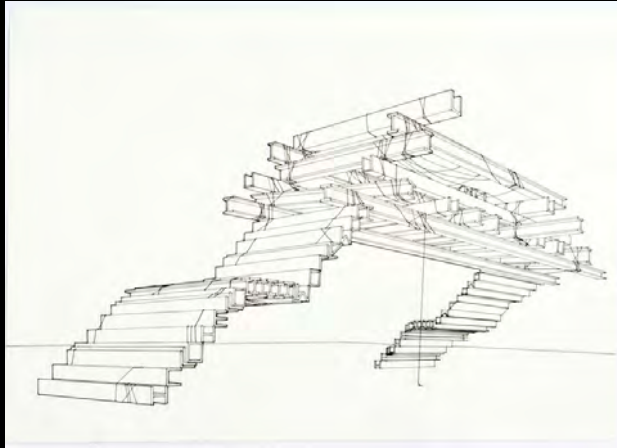
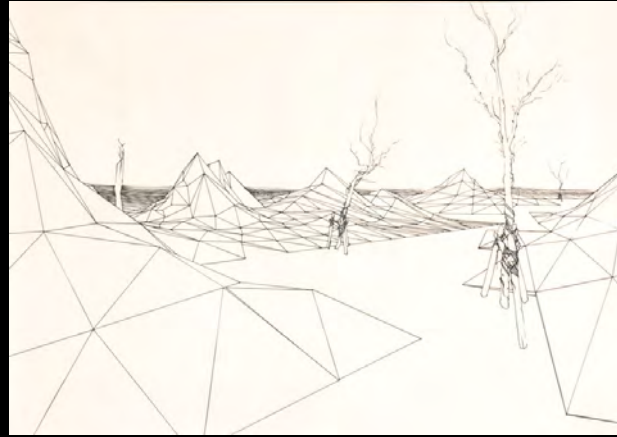
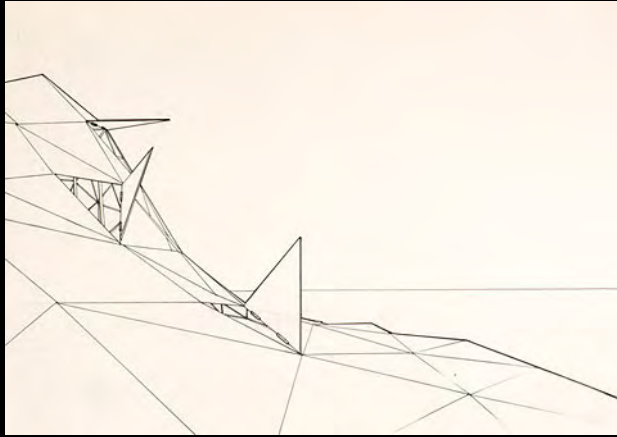

DRAWING
Ink

Viktor Timofeev

DRAWING
Ink, Colored Pencil

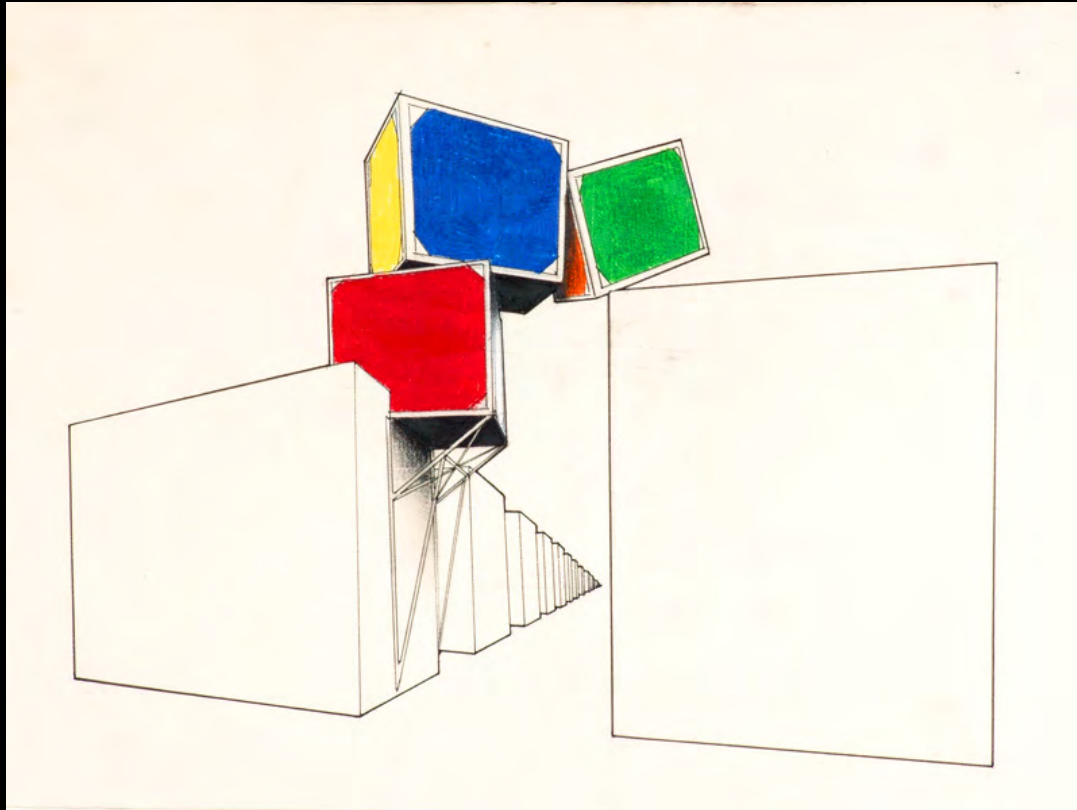

Viktor Timofeev

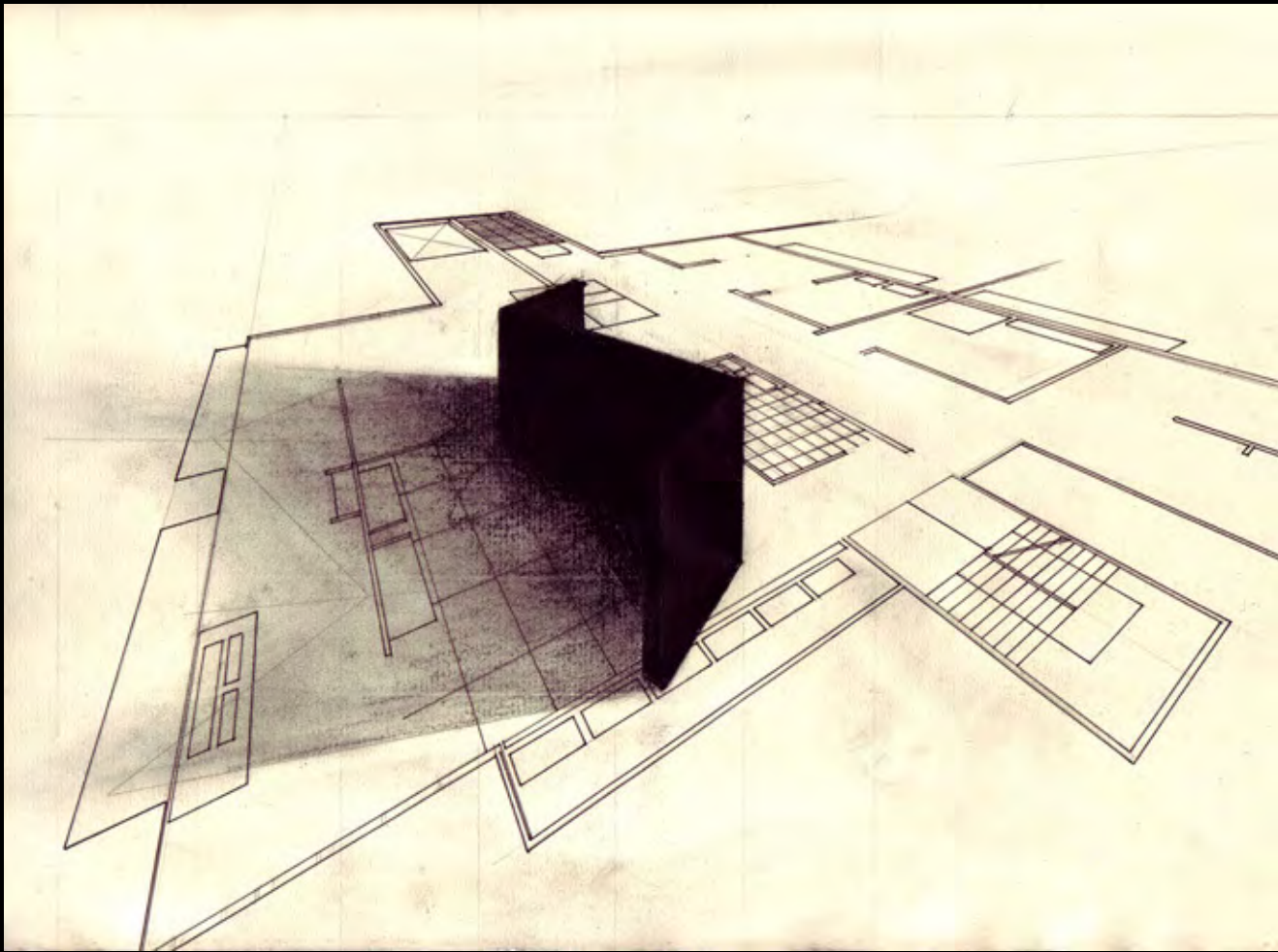

DRAWING
Ink, Guache

Viktor Timofeev

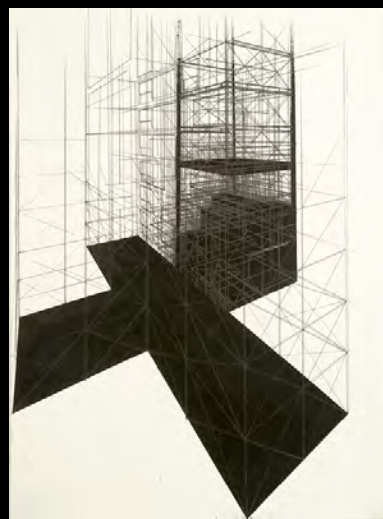
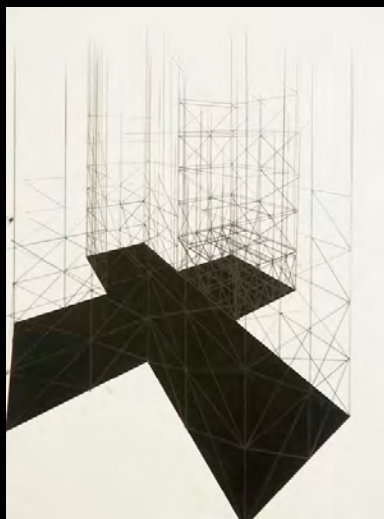
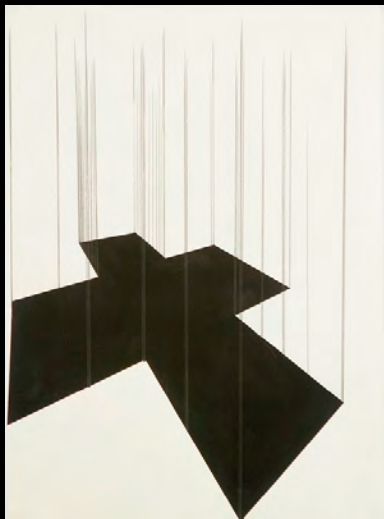

DRAWING

Graphite, Ink, Paint

Viktor Timofeev

Icon

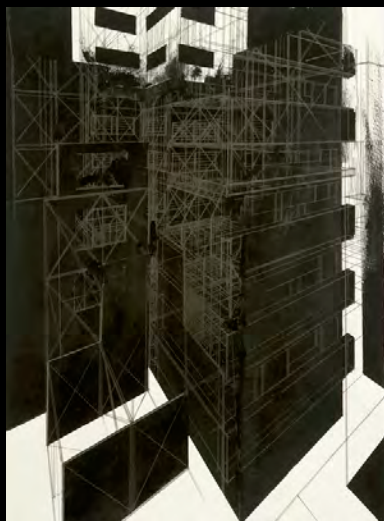
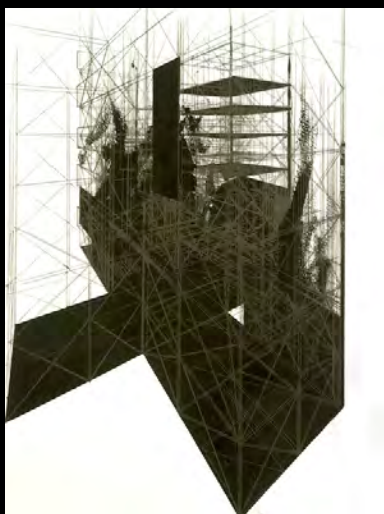

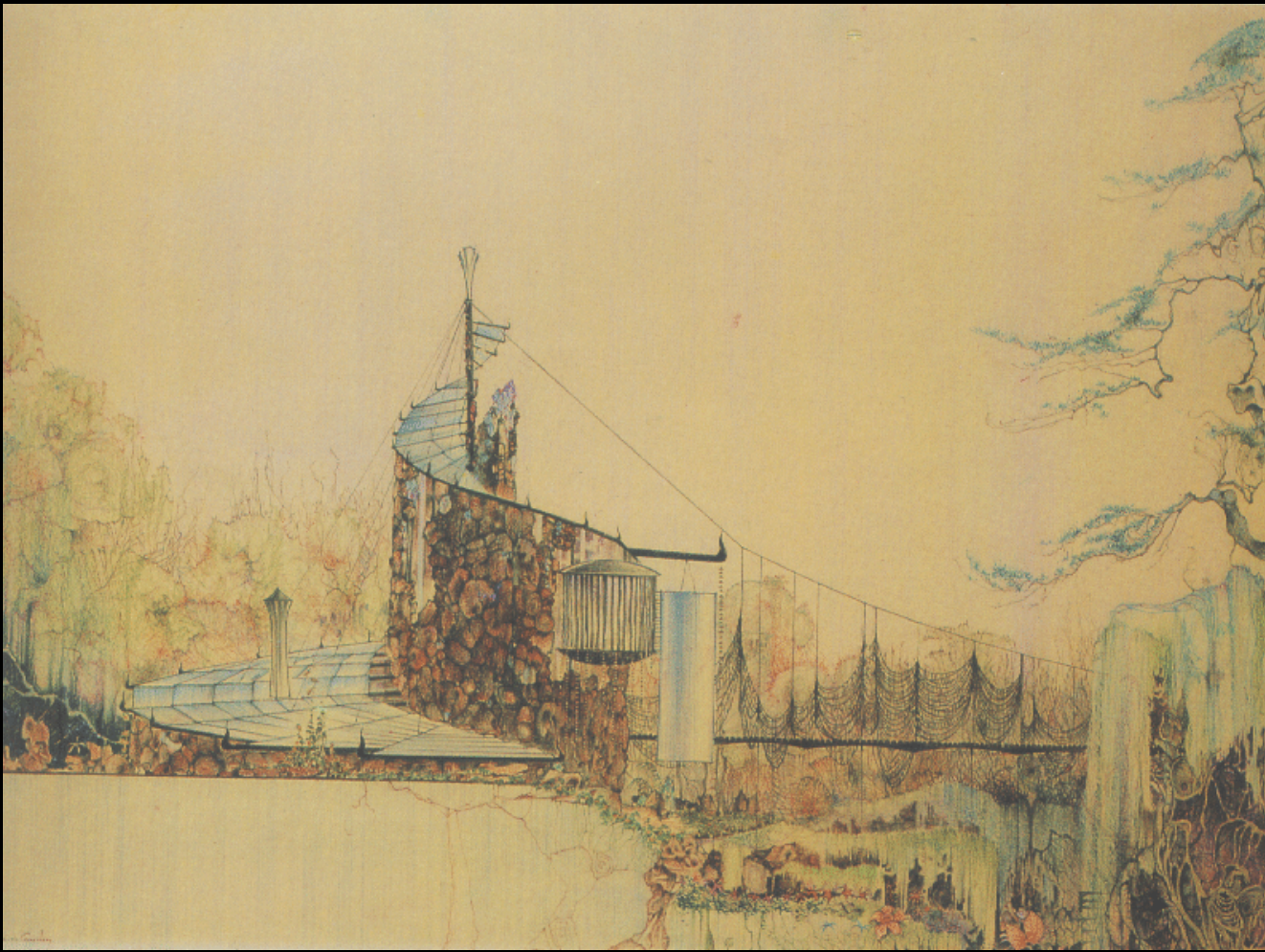

DRAWING
colored pencil

Bruce Goff
Bavinger House



DRAWING
Ink and Color



DRAWING

Collage with photo and colored pencil

Superstudio



DRAWING

Collage with photo and colored pencil

Superstudio
Monument

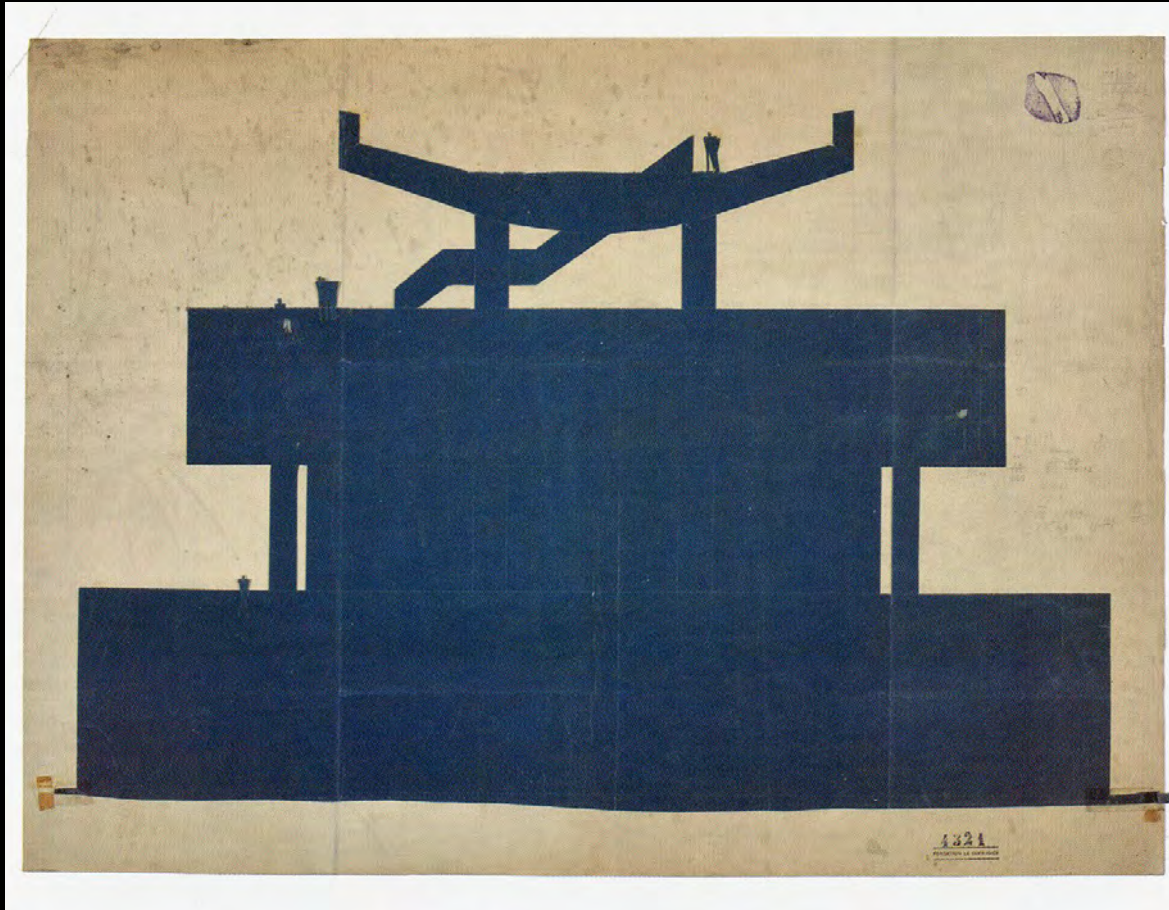

DRAWING
Ink and Guache

Le Corbusier

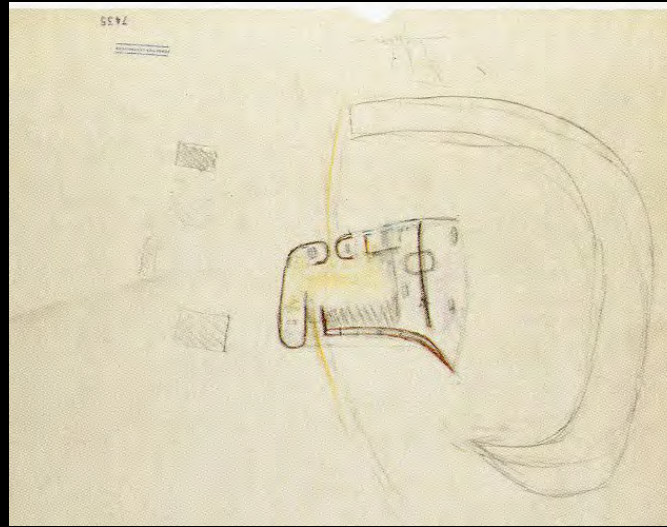
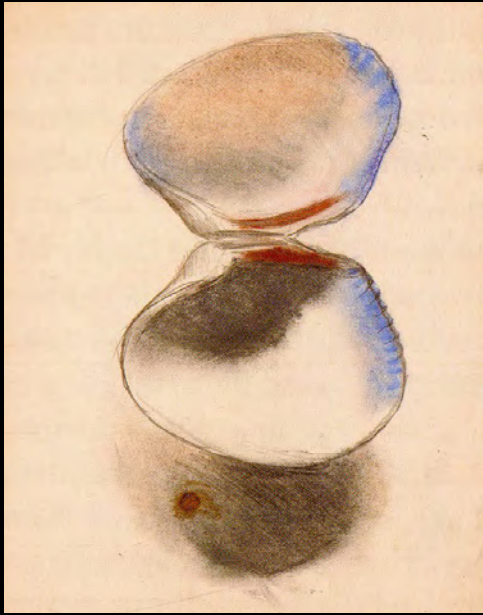

DRAWING

Graphite, Ink, colored pencil

Le Corbusier

La Ronchamps Inspiration Studies; Plan

DRAWING

Ink

Eric Miralles
Igualada Cemetery

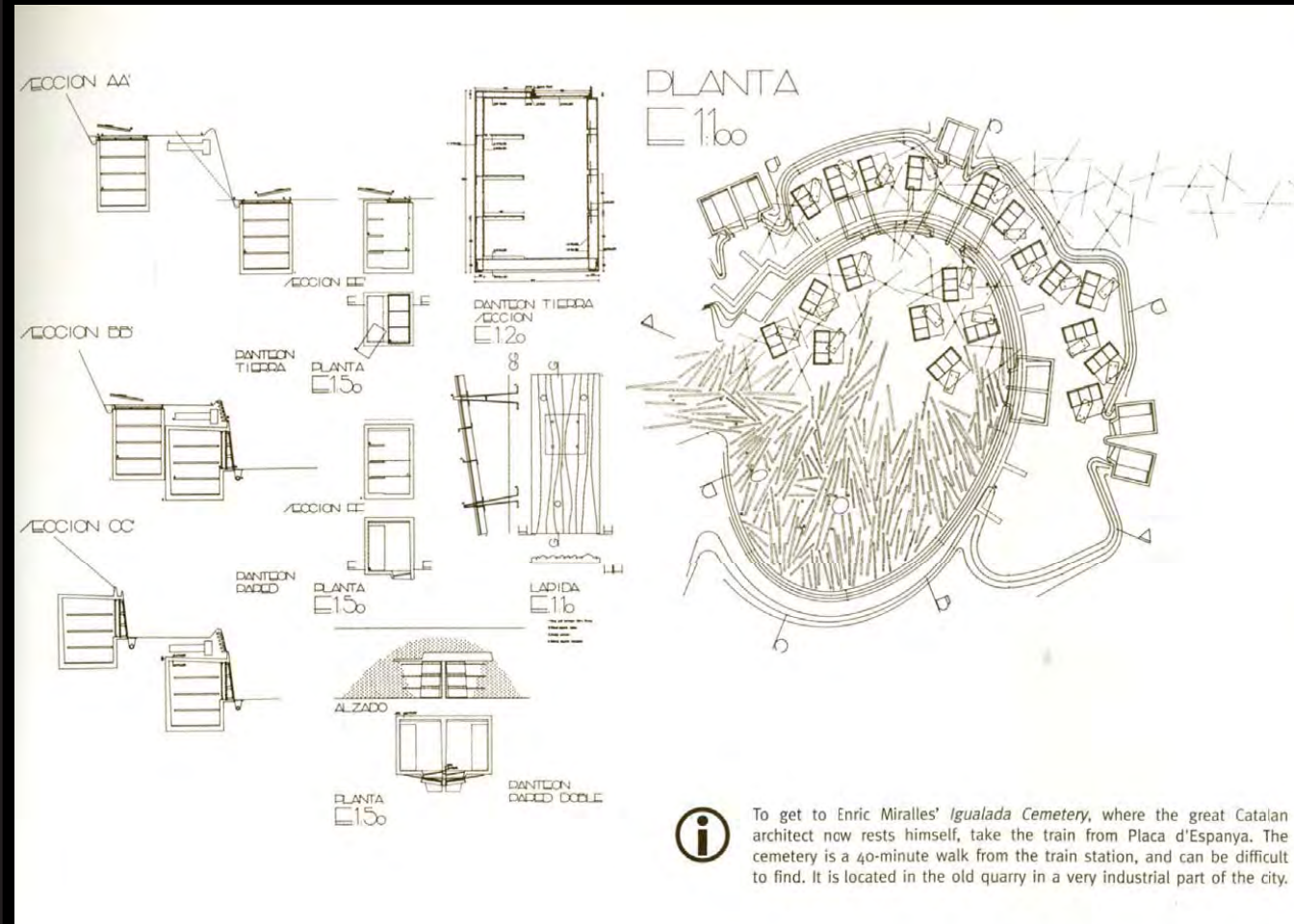

To get to Eric Miralles' *Igualada Cemetery*, where the great Catalan architect now rests himself, take the train from Placa d'Espanya. The cemetery is a 40-minute walk from the train station, and can be difficult to find. It is located in the old quarry in a very industrial part of the city.

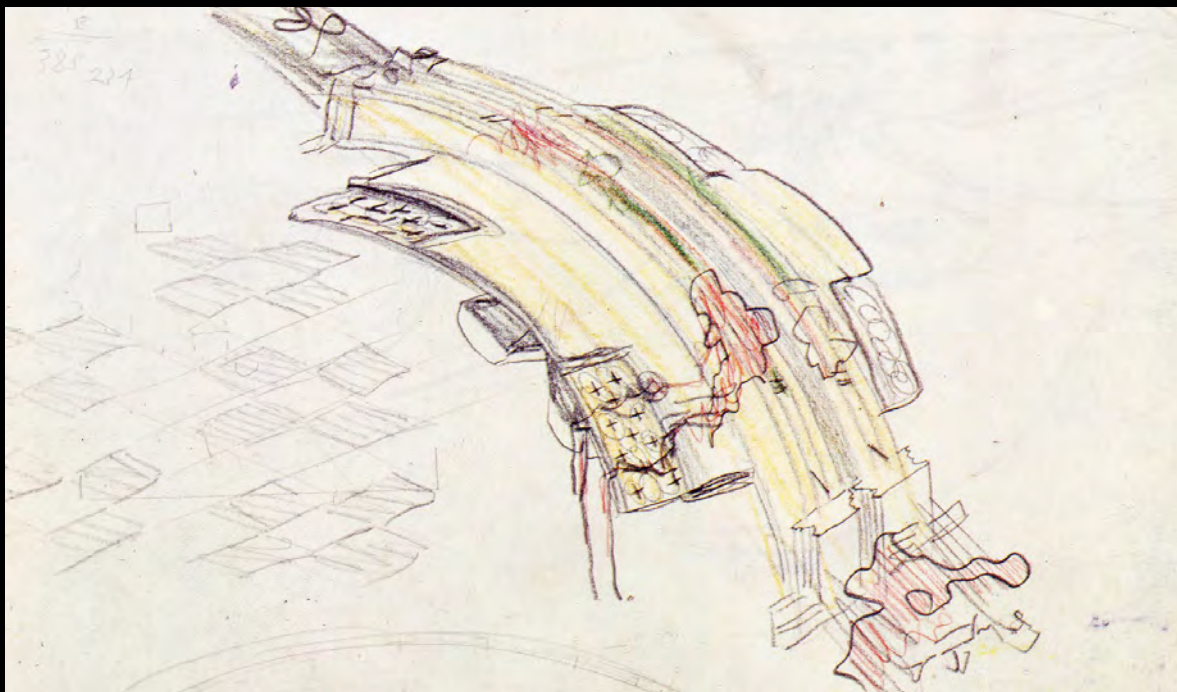

DRAWING

Graphite, Ink, colored pencil

Carlo Scarpa
Brion Cemetery

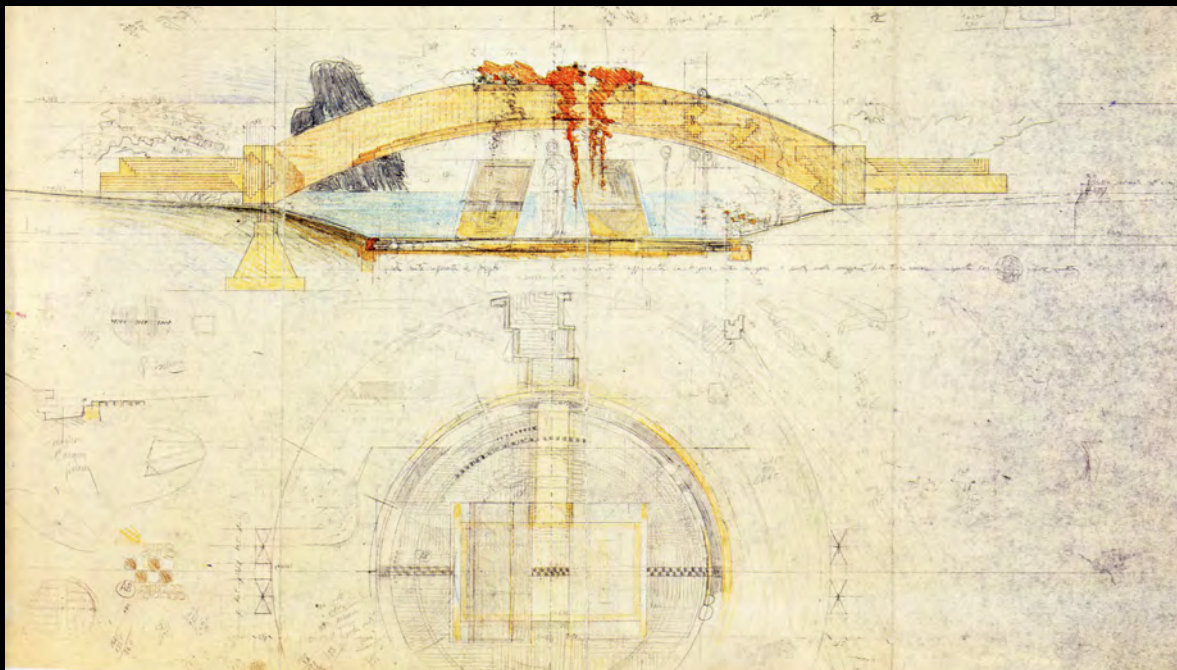

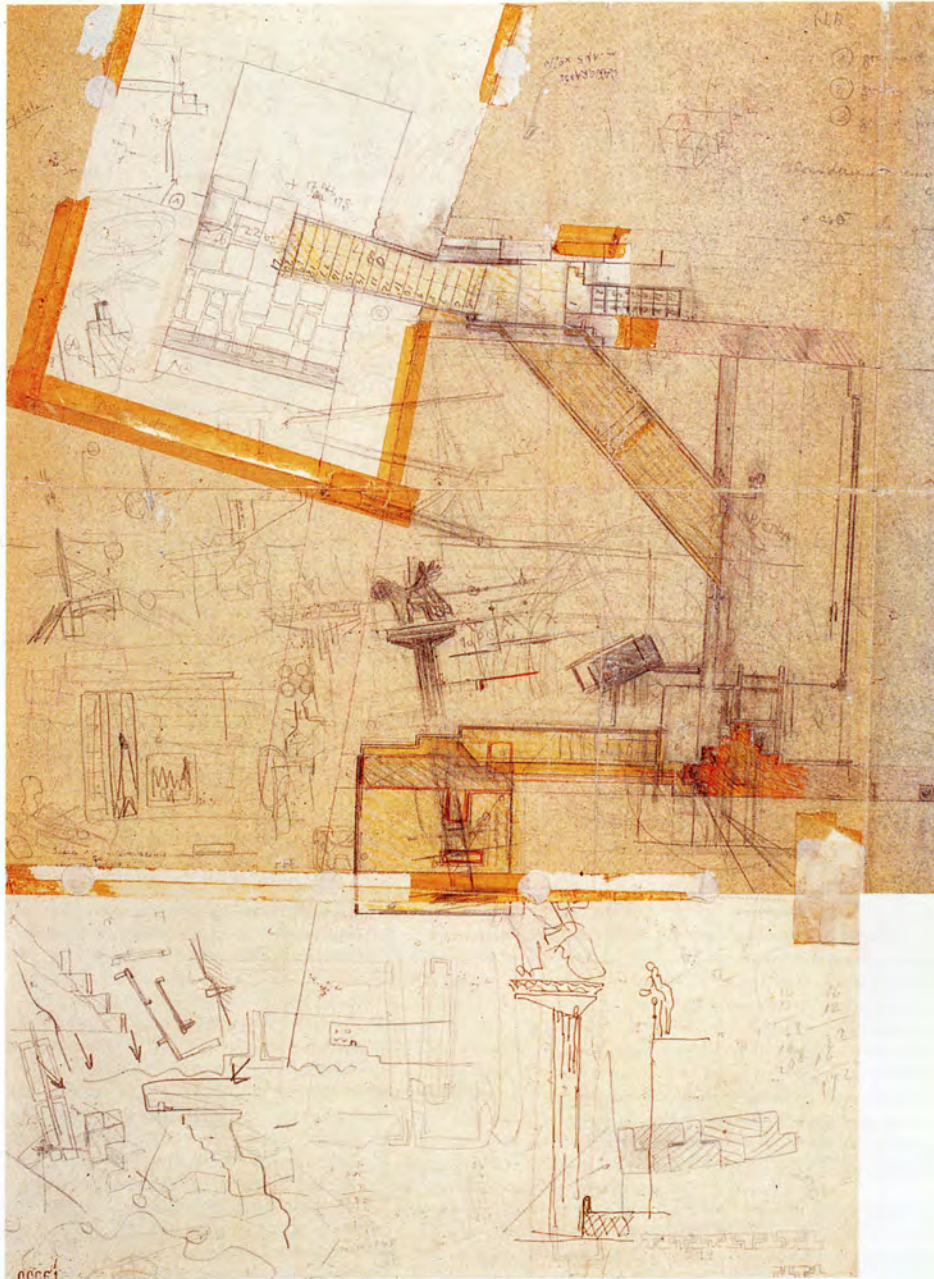

DRAWING
Graphite, Ink, colored pencil

Carlo Scarpa
Castelvecchio

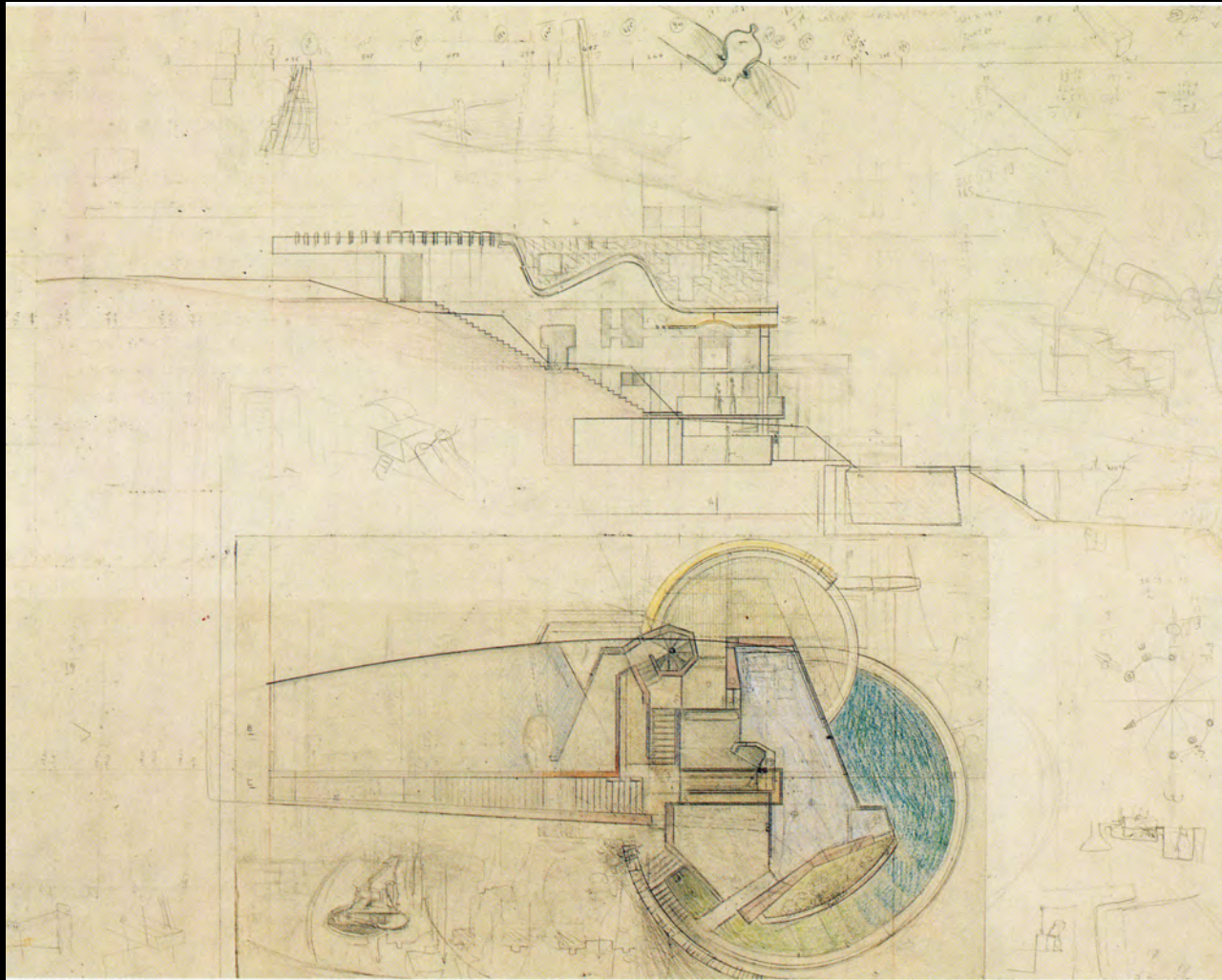

DRAWING

Graphite, Ink, colored pencil

Carlo Scarpa

Private Residence



DRAWING

Graphite, colored pencil

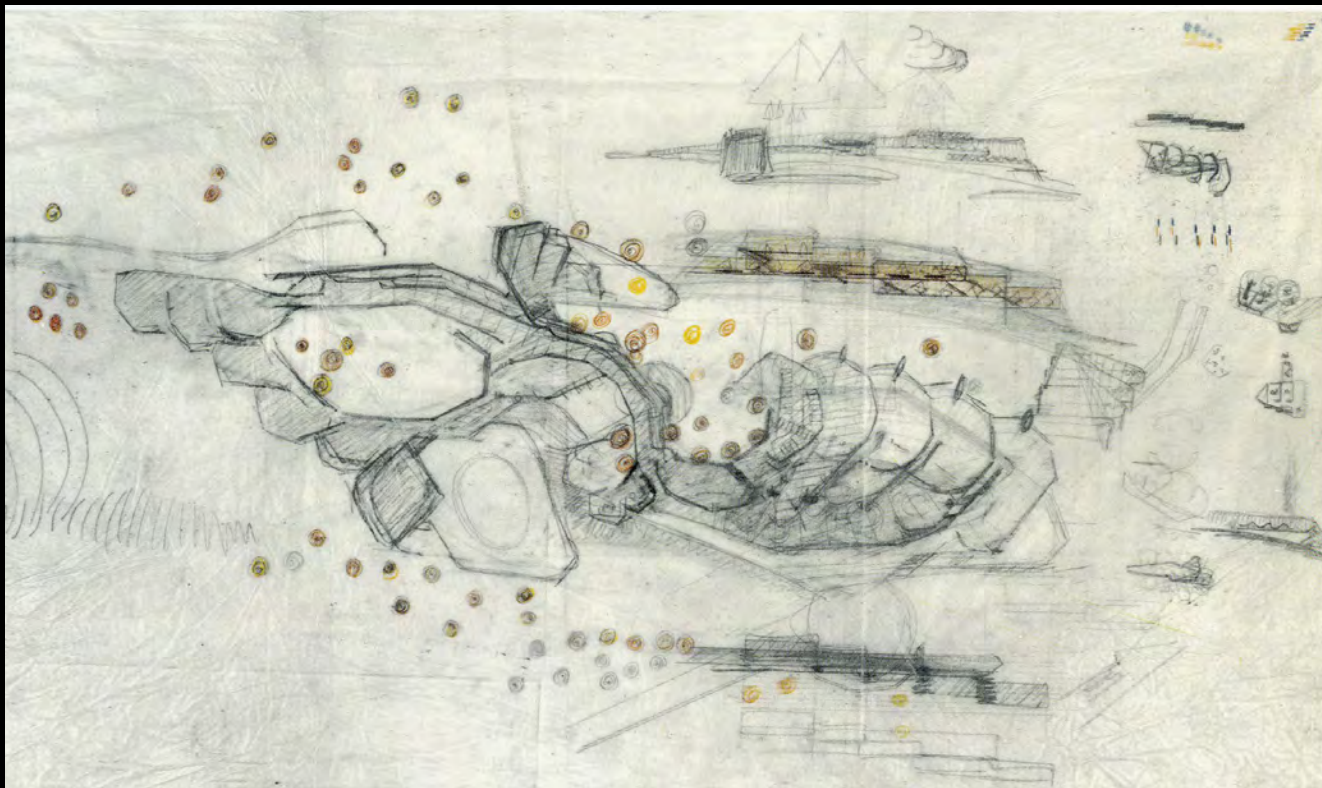

Carlo Scarpa
Studies

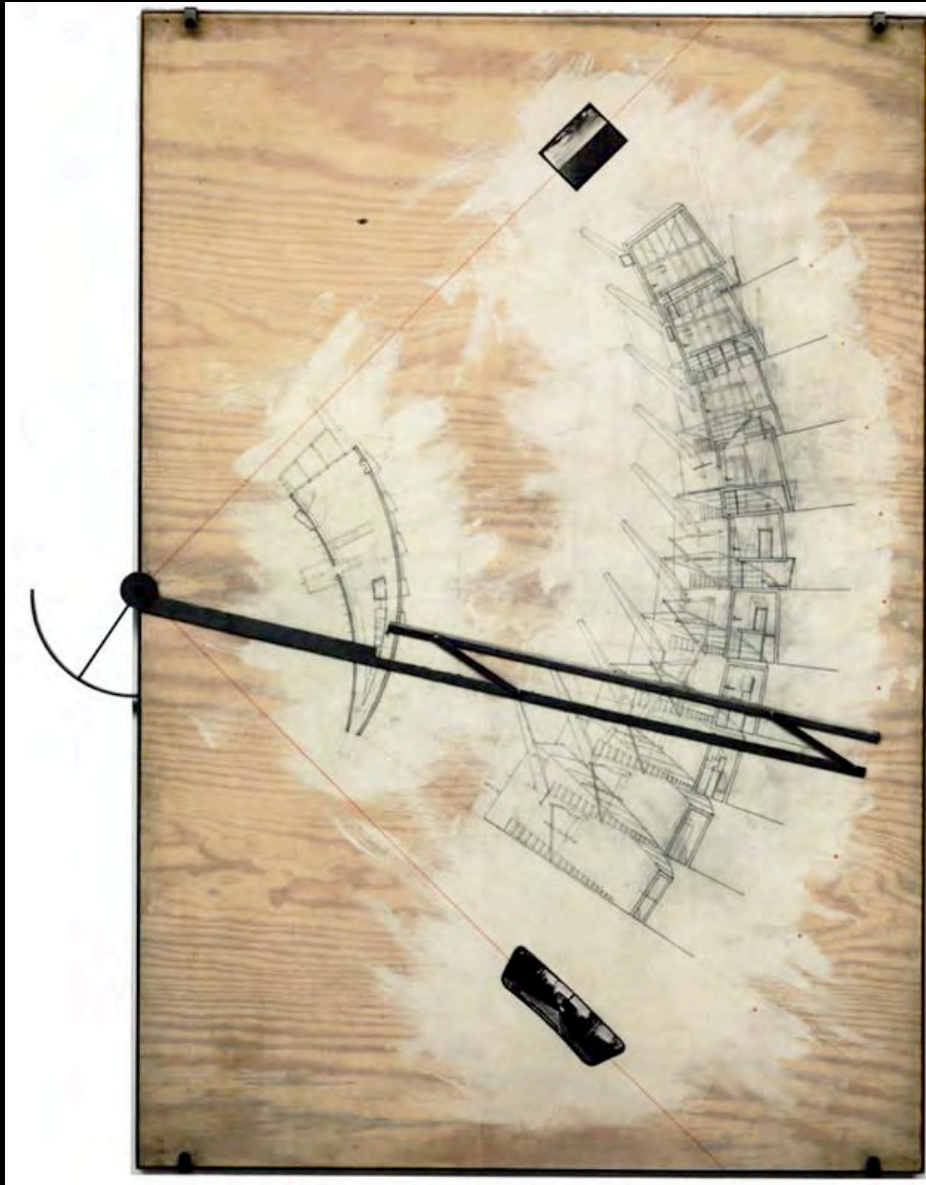

DRAWING

Drawing on 3D surface / Drawing as Model

MATERIAL ASSEMBLY OF DRAWING SURFACE
AND TOOLS

DRAWING AND COLLAGE ON PAINTED
PLYWOOD SURFACE

Diller + Scofidio

Slow House, North Haven, New York, 1988
plan of lower level with sections

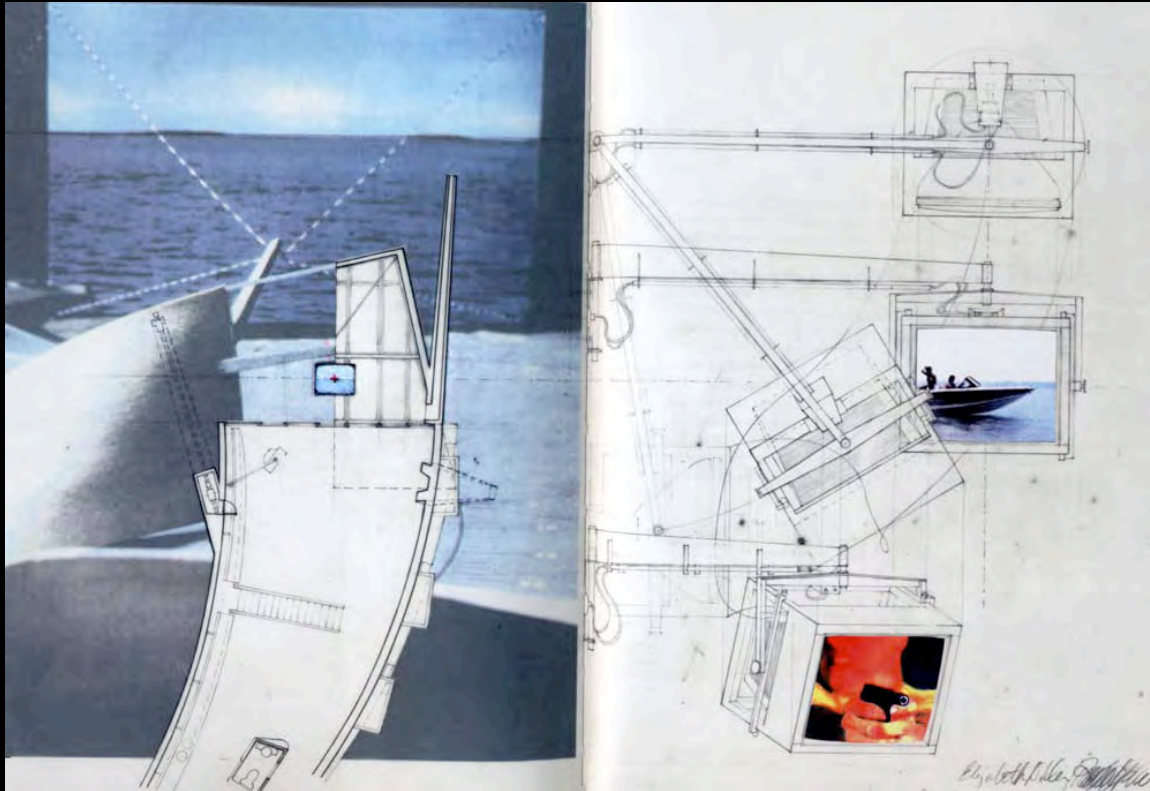

DRAWING

Collage

MIXED MEDIA ON BOARD

PHOTO

DRAWING

Diller + Scofidio

TV in Picture Window Apparatus, Slow House, North haven, New York, 1988 perspective and plans

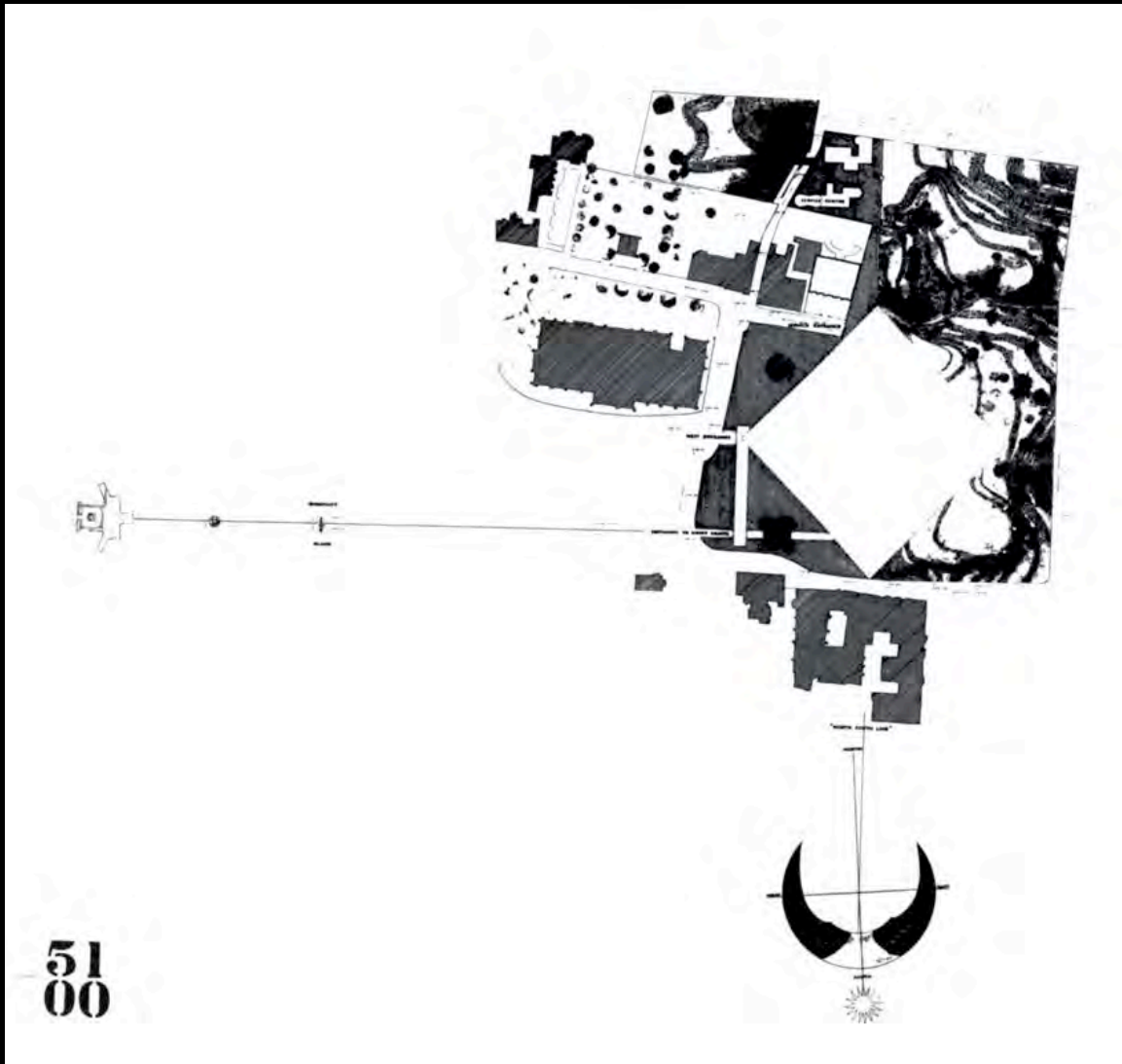

DRAWING

Lines, Fills and Hatches

SINGLE LINE

LINE HATCH

FILL

TEXTURE

Alison and Peter Smithson

*Site plan of Coventry Cathedral, 1954
site plan with building site as blank - void*

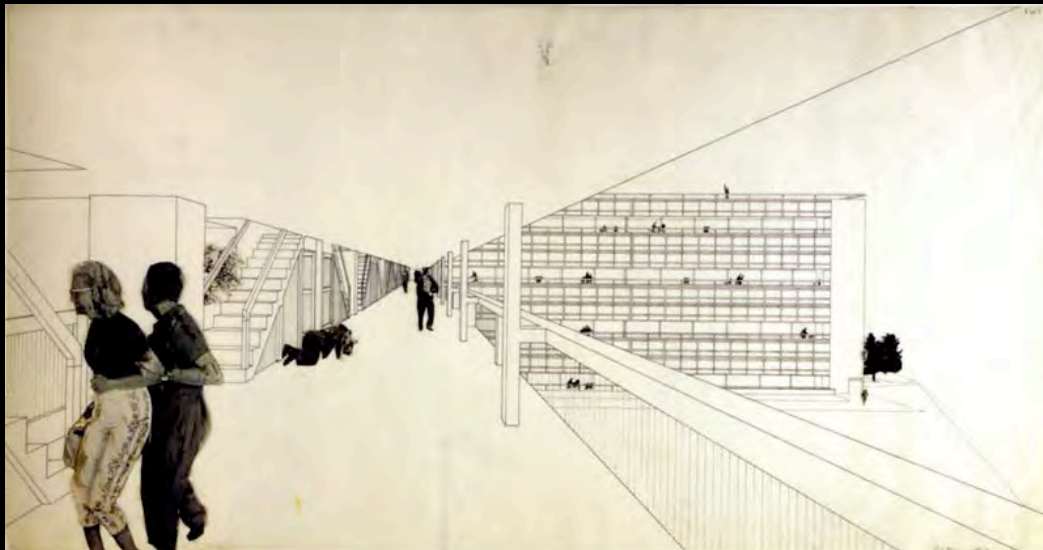

DRAWING

Collage

HIDDEN LINE PERSPECTIVE
PHOTOS

Alison and Peter Smithson

Golden Lane, 1952

interior and exterior perspective views



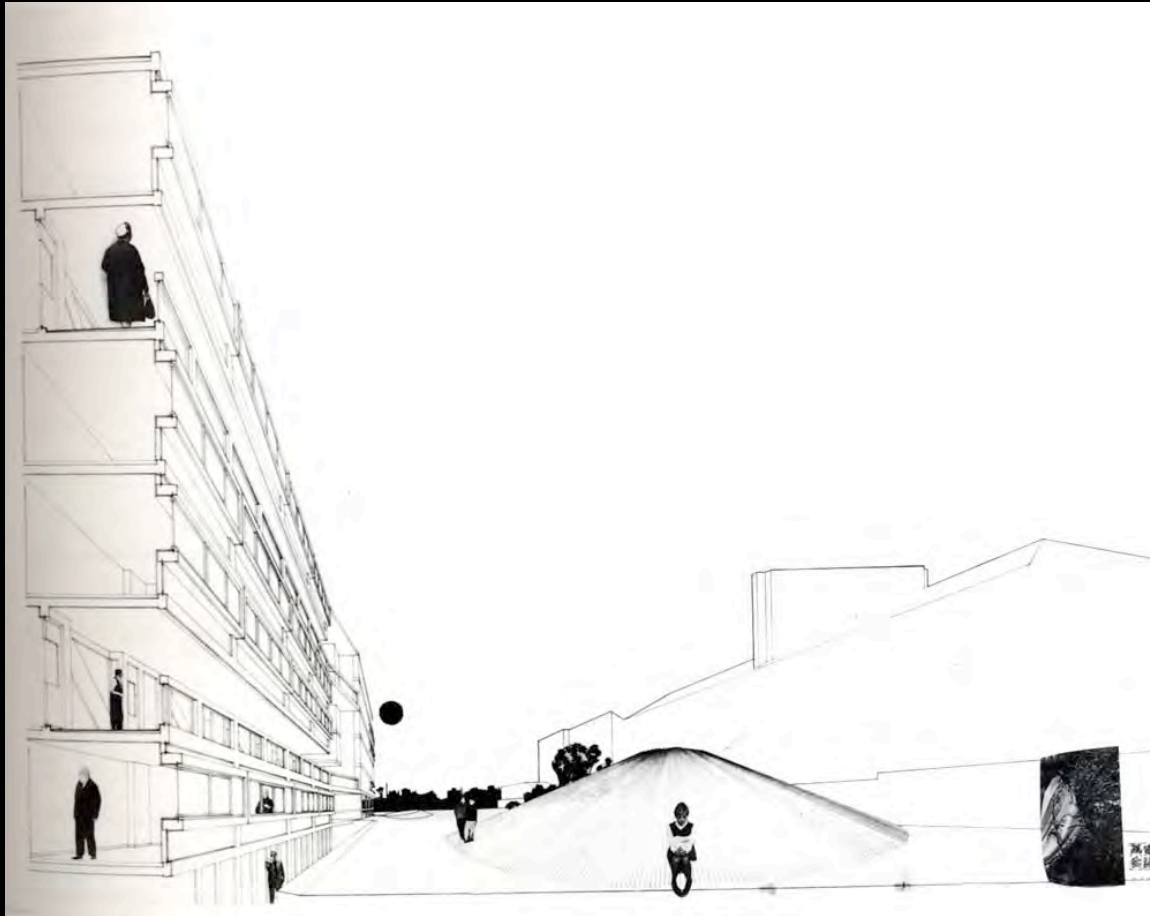

DRAWING

Collage

HIDDEN LINE PERSPECTIVE
PHOTOS

Alison and Peter Smithson

Robin Hood Gardens, London, 1966-1972
exterior perspective view with garden mound

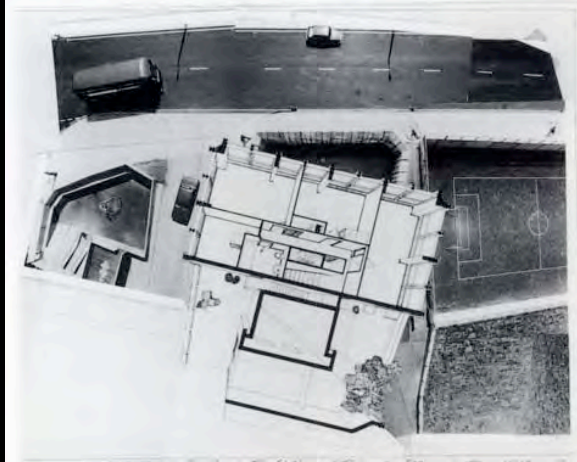
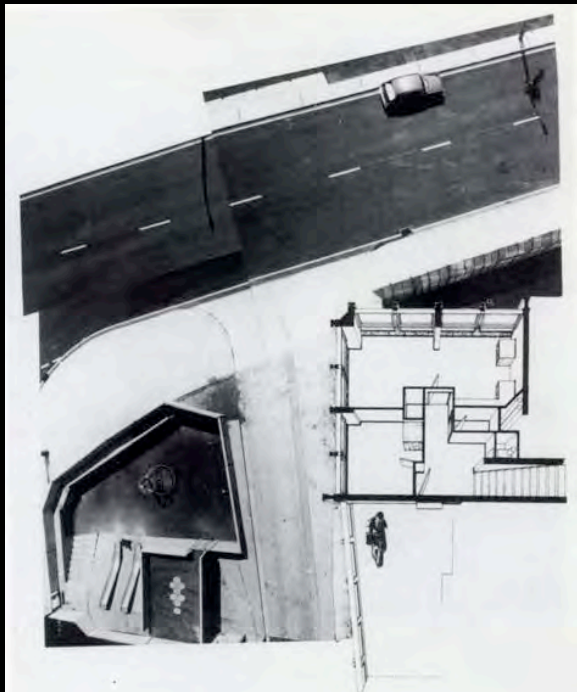

DRAWING

Collage

HIDDEN LINE PERSPECTIVE

SECTION CUT HATCH

AERIAL PHOTOS

Alison and Peter Smithson

Robin Hood Gardens, London, 1966-1972
plan perspectives with site context



DRAWING

Collage

HIDDEN LINE PERSPECTIVE
SECTION CUT HATCH
SITE PHOTOS

Alison and Peter Smithson

Robin Hood Gardens, London, 1966-1972
section perspectives with site context

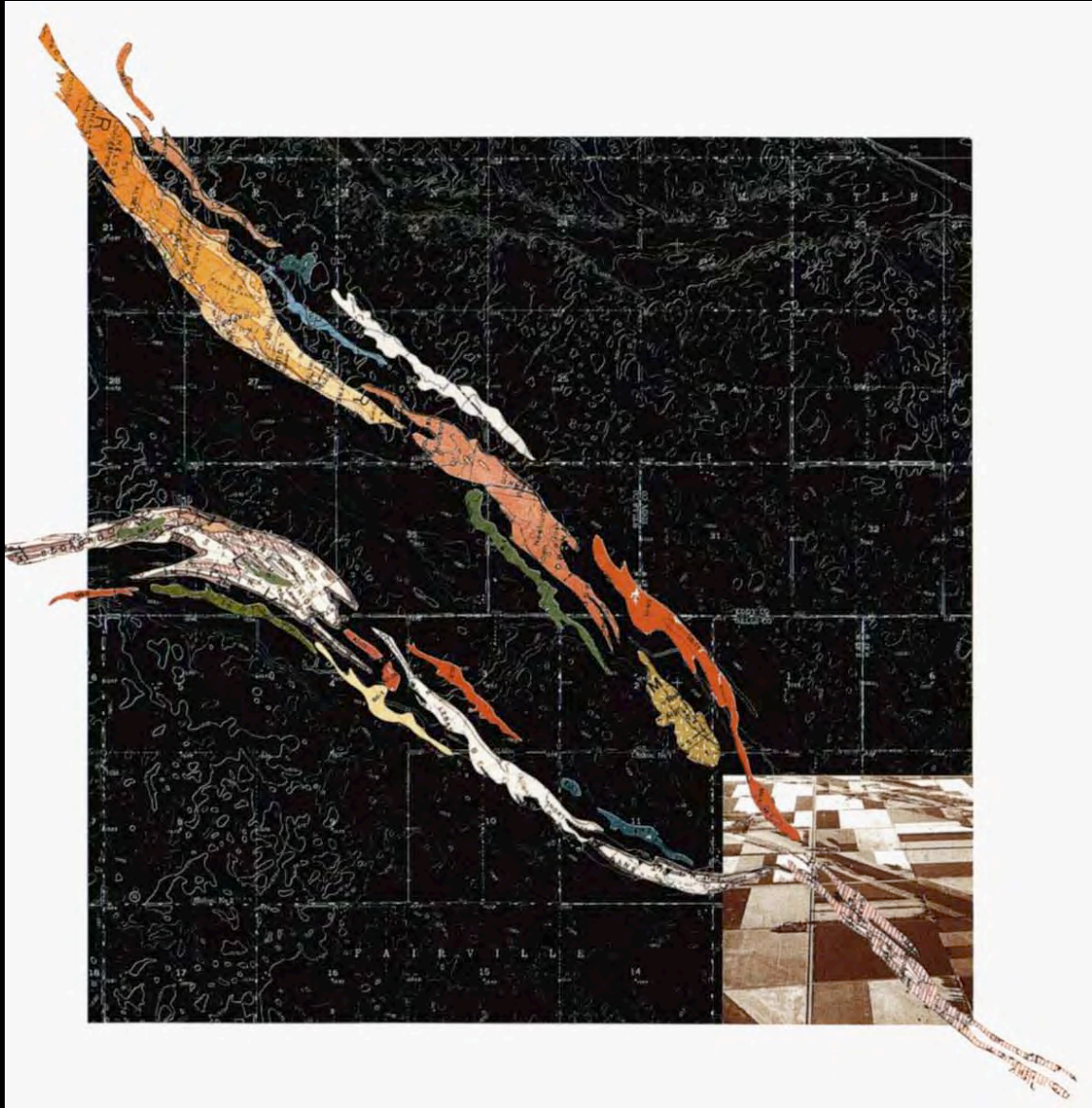

DRAWING

Combining media and information

MAPS
PHOTOS
DATA

James Corner

Pedological Drift, 1990-1994

ridges from old beach deposits of an ancient lake drift in contrast to geometrical survey grid

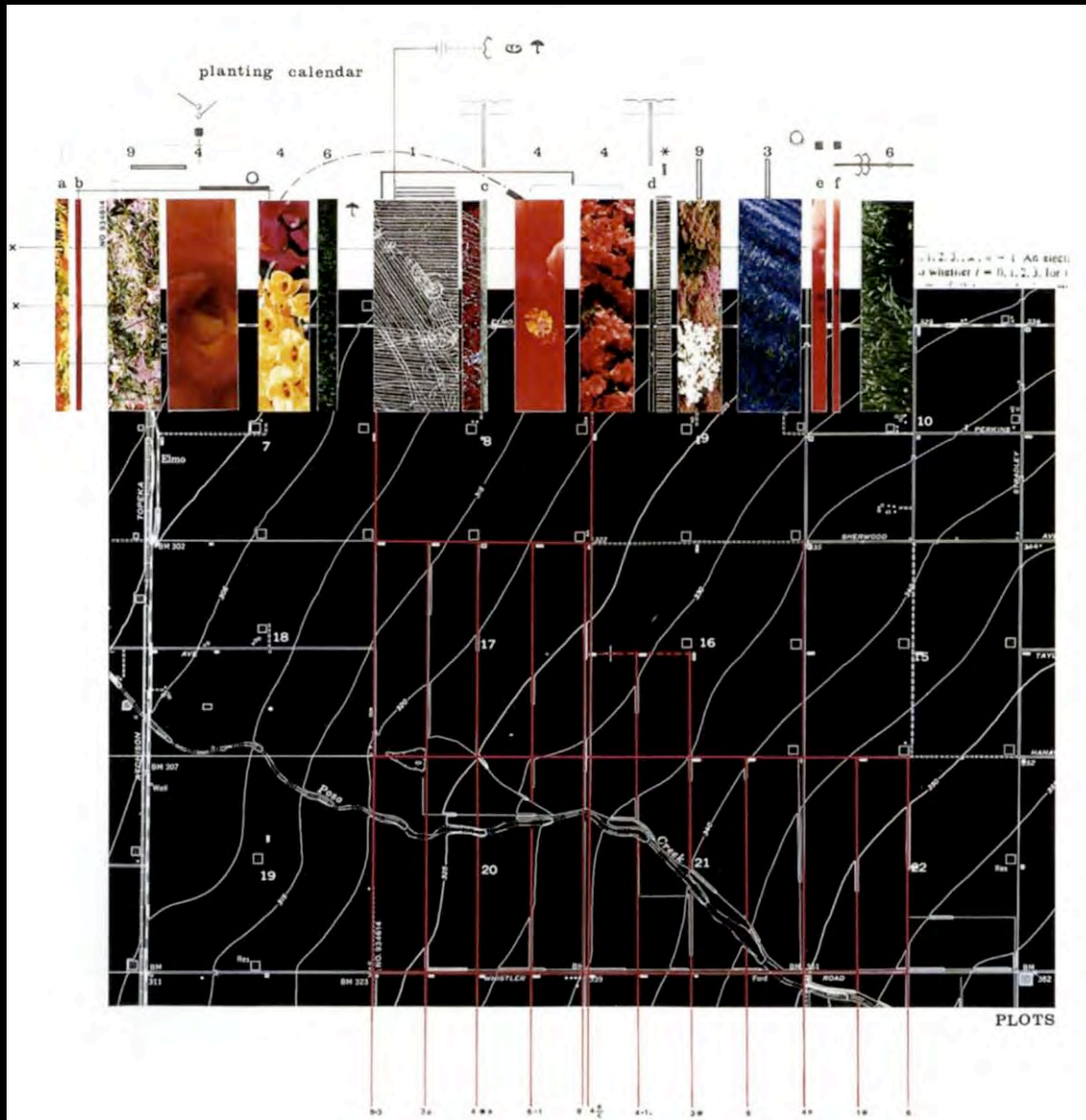

DRAWING

Combining media and information

MAPPING

PHOTOS

DATA

James Corner

Field Plots, 1990-1994

dimension and schedule rotation of crop farming - spacing of crop lines and timing and sequencing of seeding and harvesting

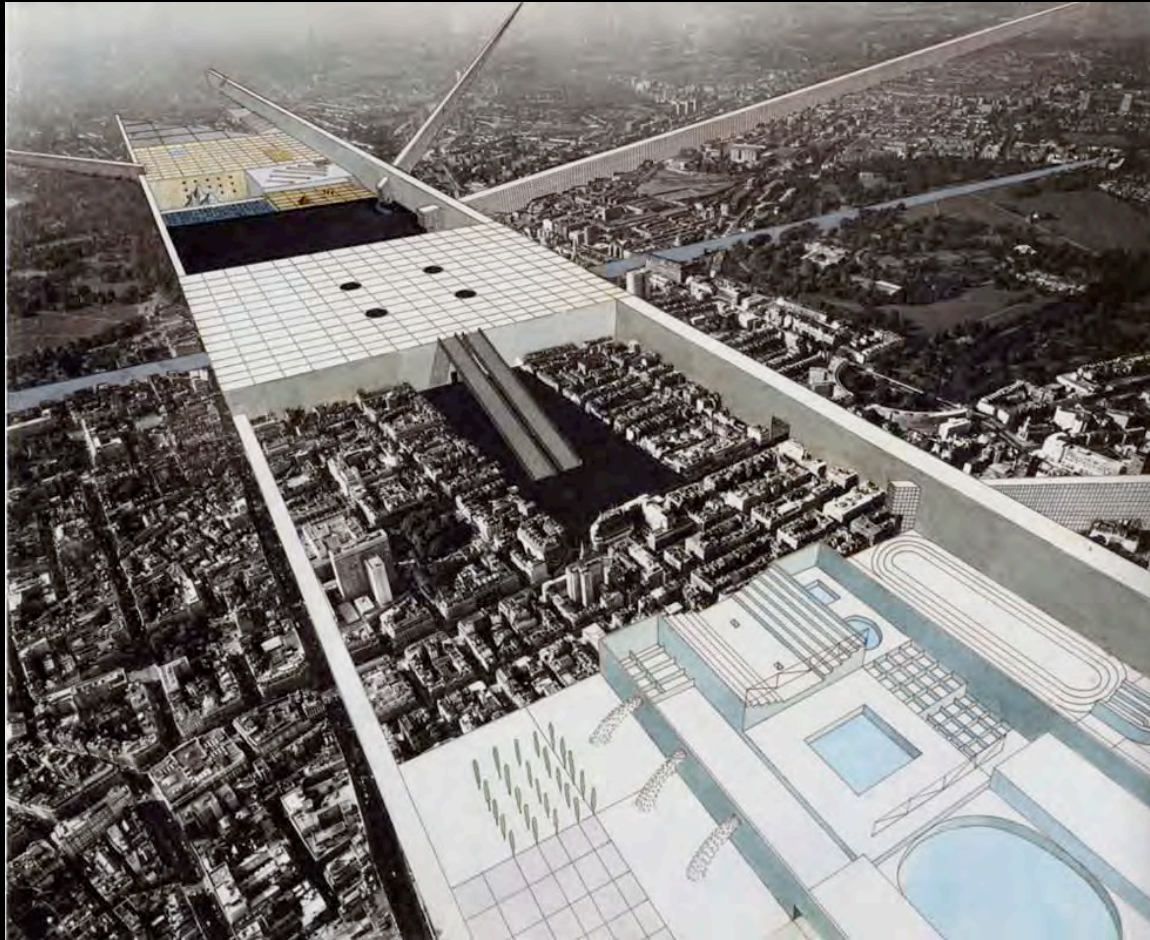

DRAWING

Collage

AERIAL PHOTO
PERSPECTIVE DRAWING

Rem Koolhaas and Elia Zanghelis
*Exodus, or the Voluntary Prisoners of
Architecture Project: The Strip, 1972*
proposed project for London



DRAWING

Drawing on photo

PHOTOGRAPH

PERSPECTIVE DRAWING

Cedric Price



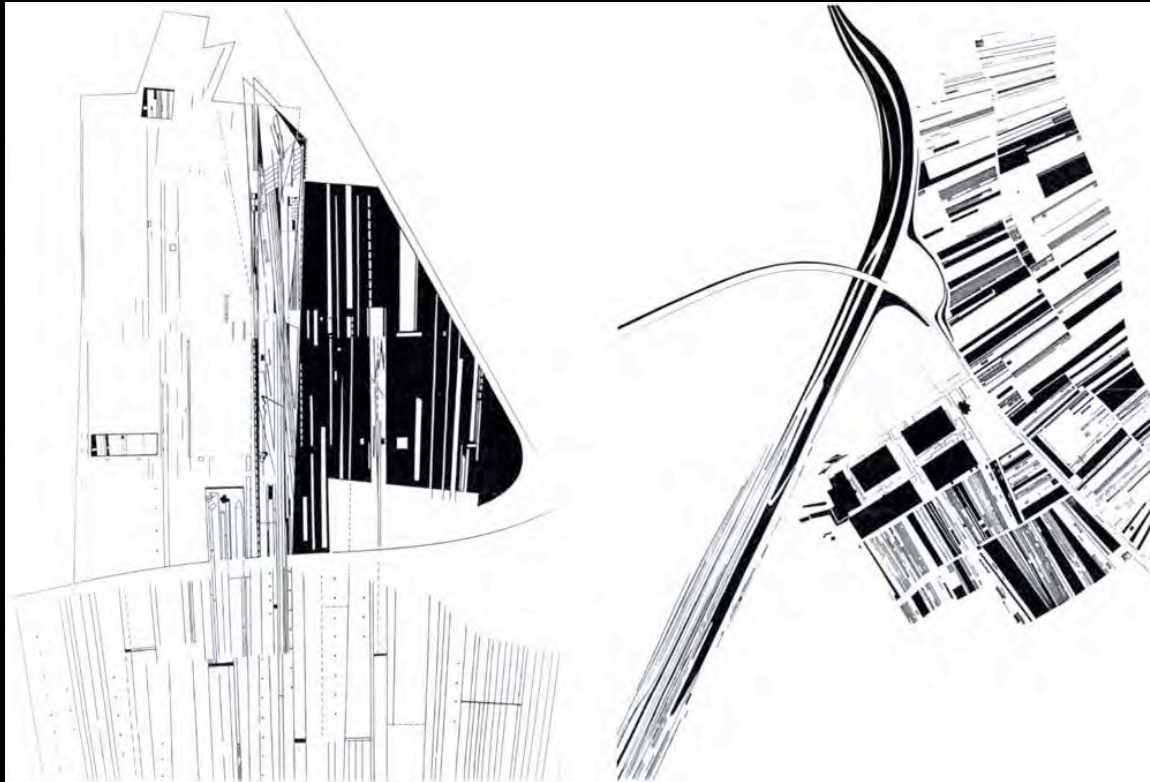

DRAWING

Variation of Line Weights and Fill

LINE (solid, dashed, bold, light)

FILL (black, grey, white)

Zaha Hadid

Vitra site Study, 1999

relationship between architecture and
landscape



DRAWING

Photo Collage

PHOTO OF MODEL

PHOTOSHOP : Trim, Cut, Paste, Transparency

RAAUm Group

Croton Aqueduct study, 1992-1995
proposed programs/buildings along the
Croton Aqueduct

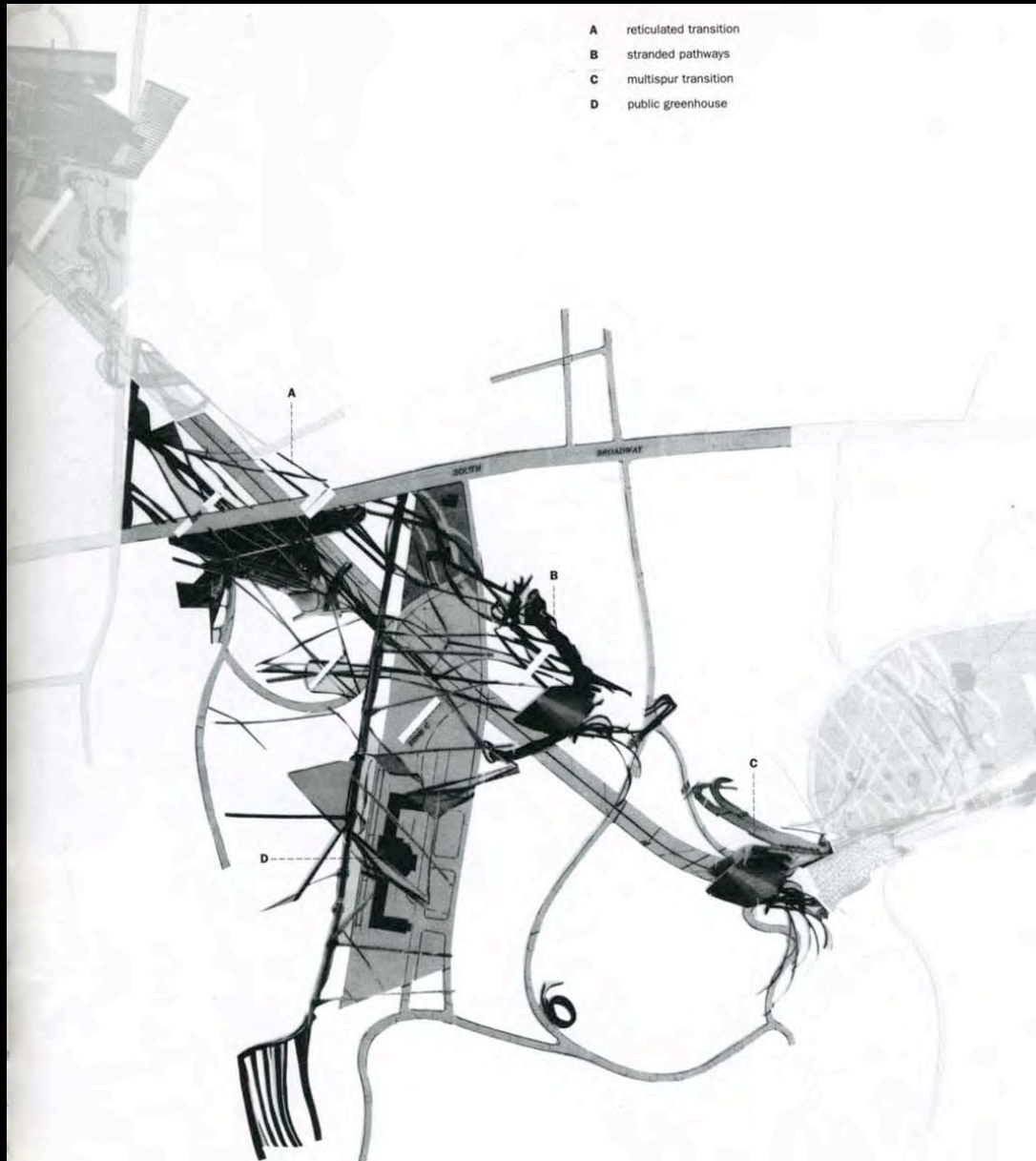

- A reticulated transition
- B stranded pathways
- C multispur transition
- D public greenhouse

DRAWING

Photo Collage

PHOTO OF MODEL

PHOTOSHOP : Trim, Cut, Paste, Transparency

RAAUm Group

Croton Aqueduct study, 1992-1995
proposed programs/buildings along the
Croton Aqueduct

DIAGRAM

3D Model rendered,
Illustrator

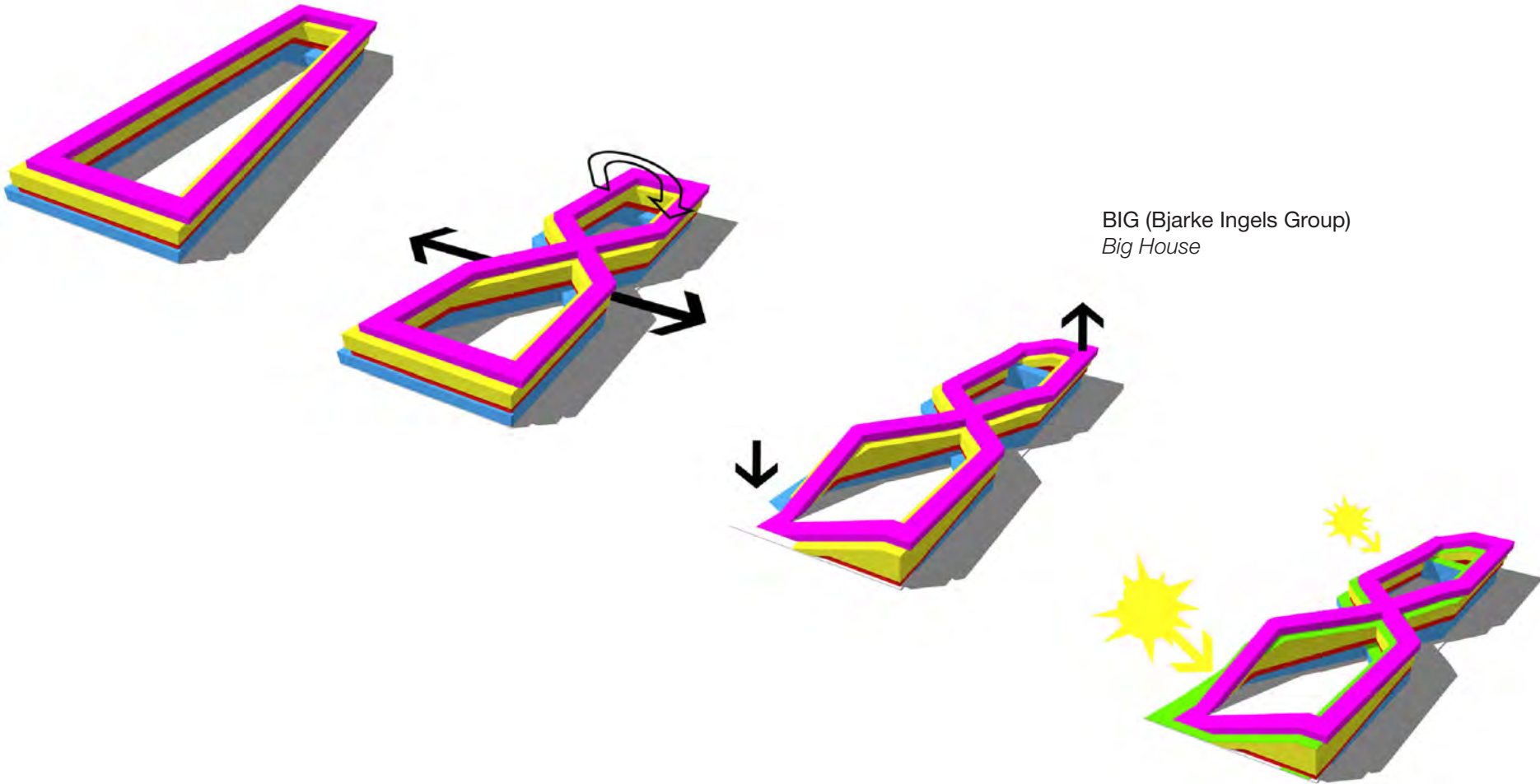

BIG (Bjarke Ingels Group)
Big House

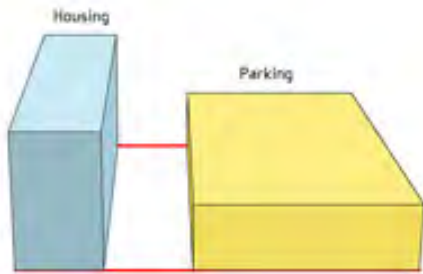

1

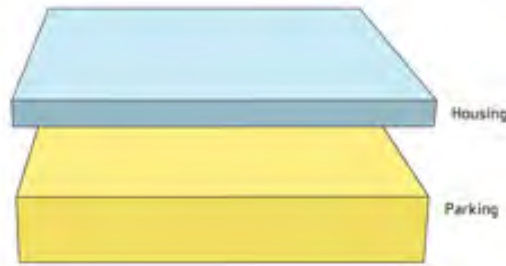

2

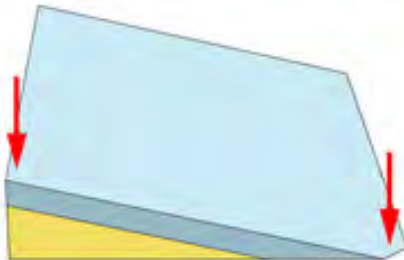

3

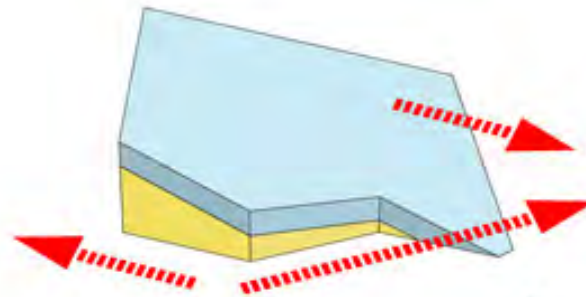

4

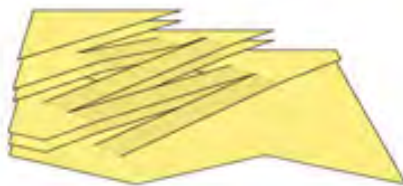

5

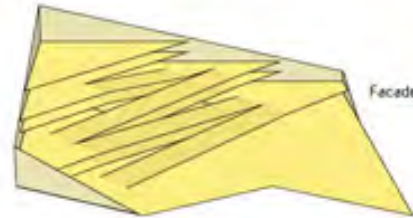

6

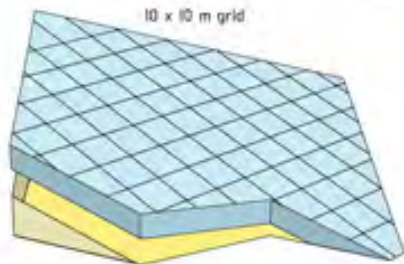

7

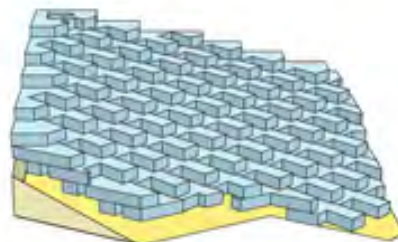

8

DIAGRAM
3D Model,
Illustrator

BIG (Bjarke Ingels Group)
Mountain Dwelling

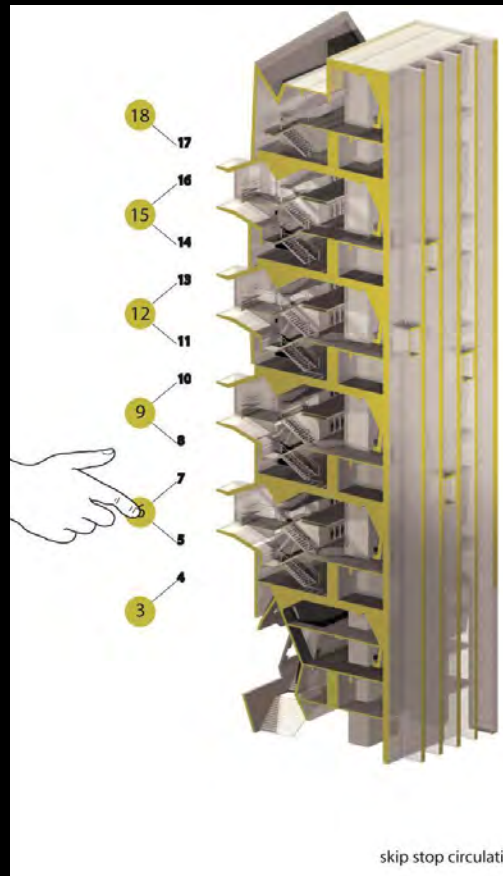
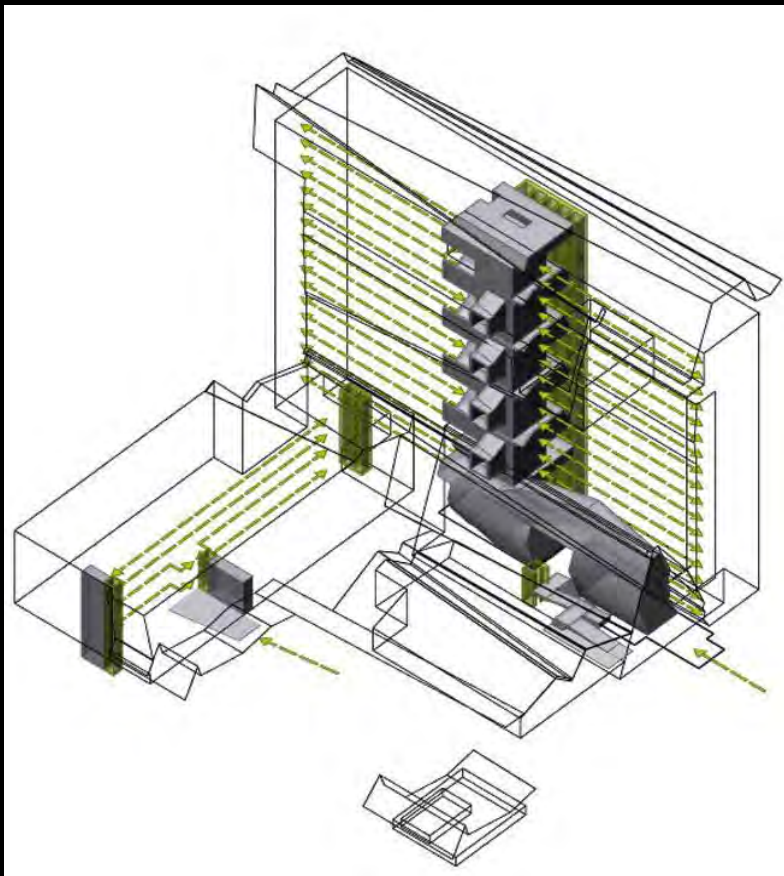

DIAGRAM
3D Model rendered,
Illustrator

Morphosis
San Francisco Federal Building

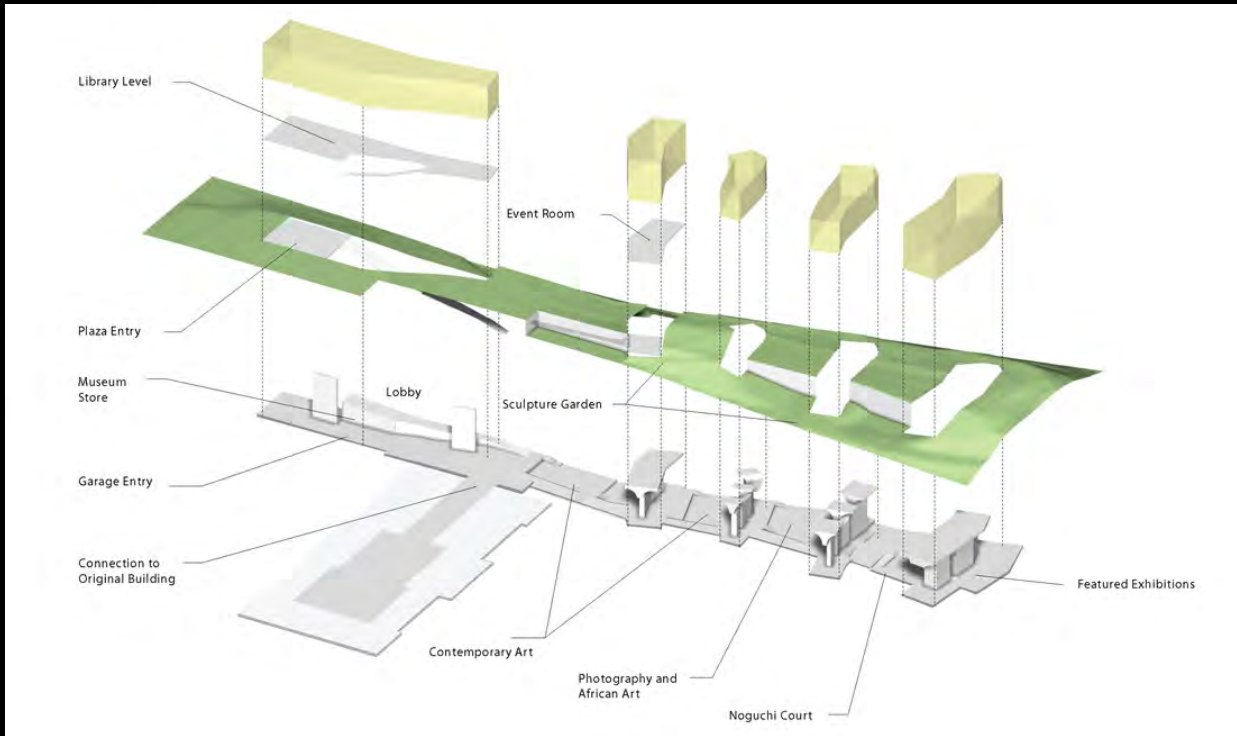
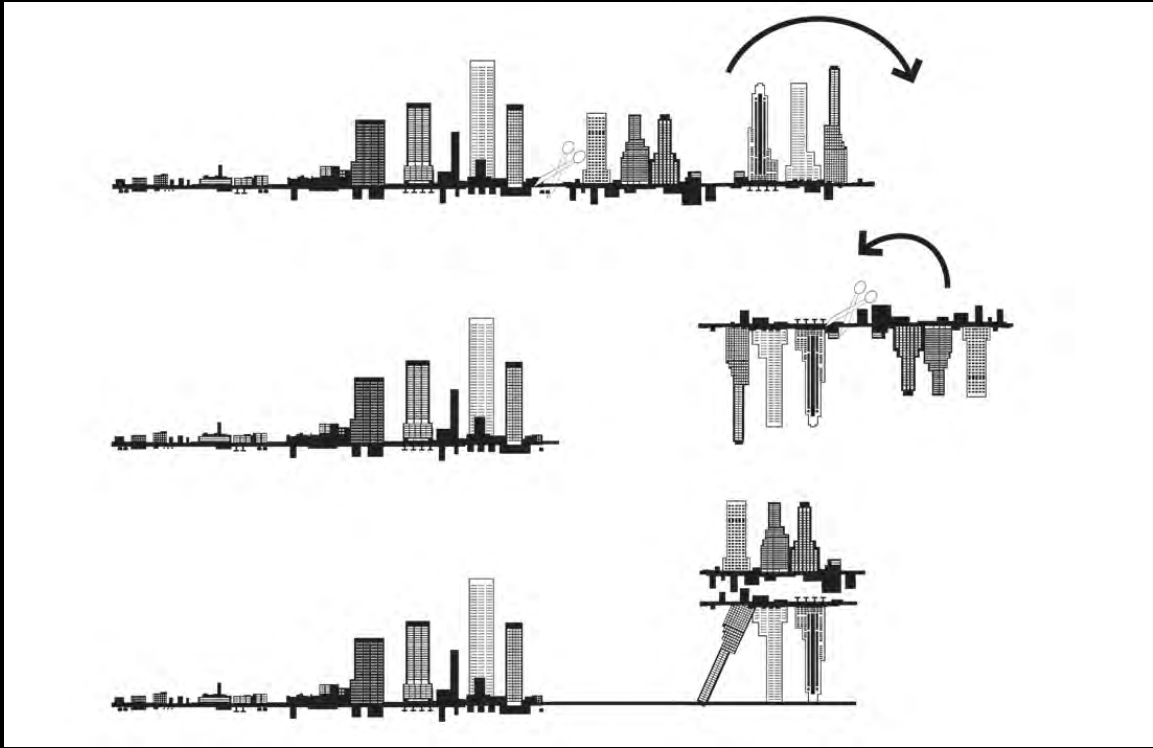

DIAGRAM
3D Model rendered,
Illustrator

Steven Holl
Nelson-Atkins Museum of Art



DIAGRAM

Illustrator

REX

Museum Plaza

structure of volume

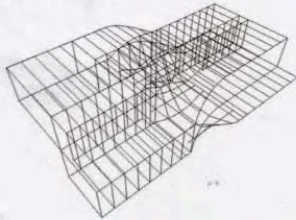

diagrammatic section

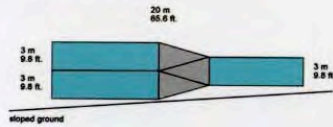

planar volumes

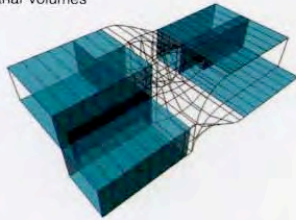

diagrammatic plan

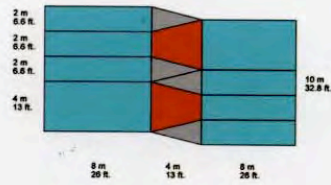

twisted surfaces

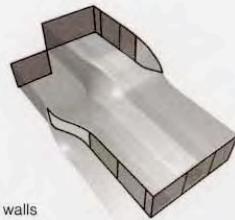
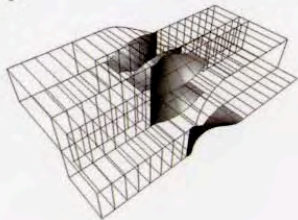

glass walls

single-curved surfaces

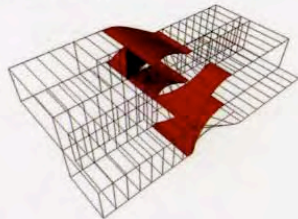

structural support and
two additional walls

DIAGRAM

2D and 3D color coded diagrams

WIRE FRAME
COLOR VOLUME
COLOR CODING
NOTATIONS

UN Studio

Villa NM, Upstate New York, 2000-2005
component diagrams

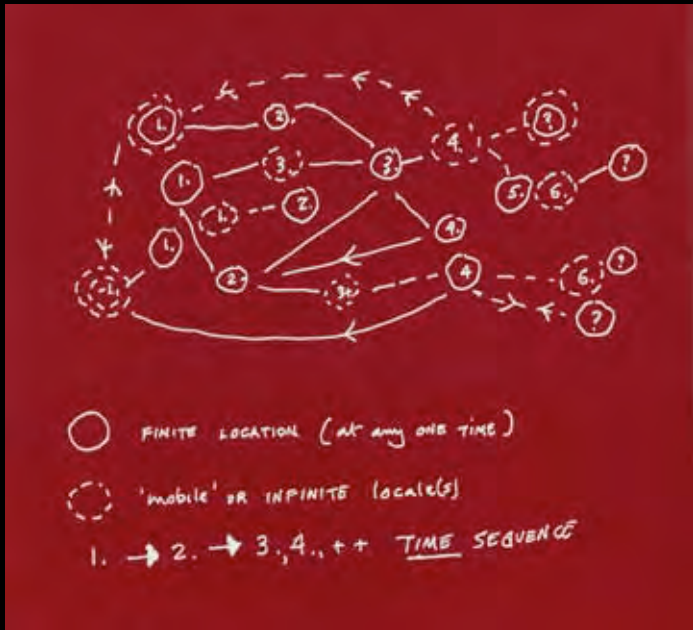

DIAGRAM

2D and 3D line drawings_hand sketched

- SINGLE LINE
- DASHED LINE
- DOTTED LINE
- COLOR
- FILL
- NOTATION

Cedric Price

Drawings for cities on the move, 2000

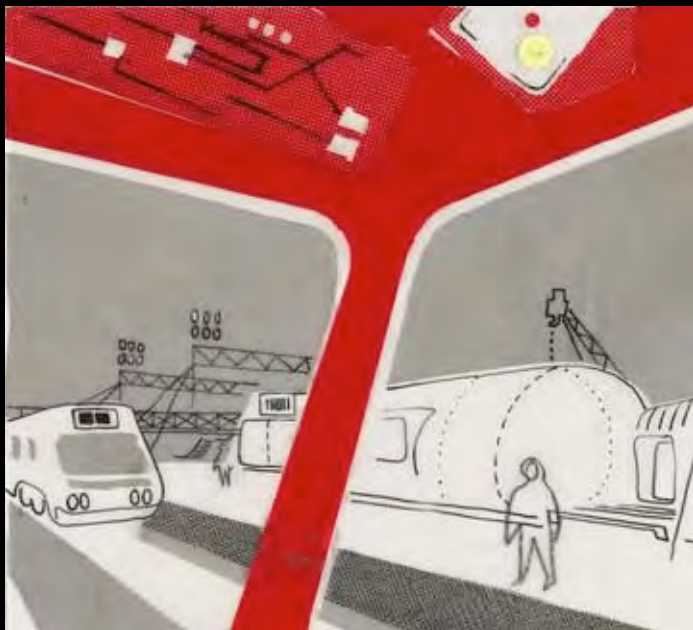

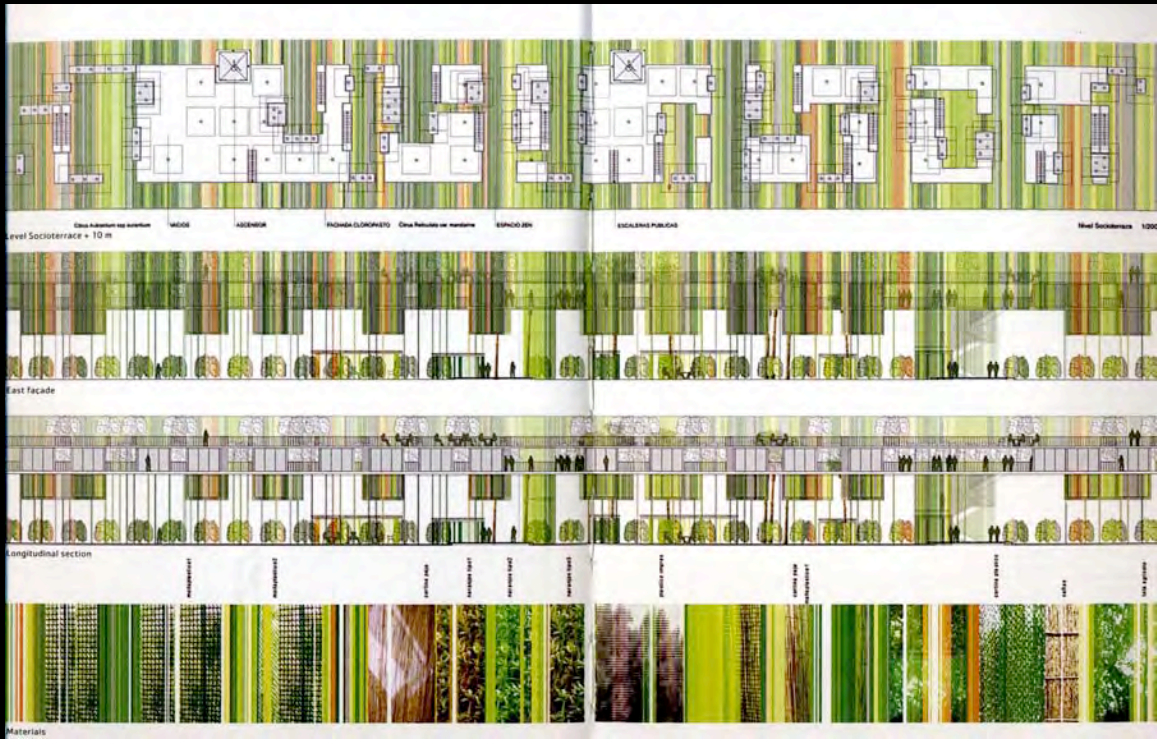

DIAGRAM

Collage

PLANS

ELEVATIONS

MATERIAL PLANTINGS IMAGES

Duncan Lewis Scape

Community Center, Valencia

collage diagrams of planting materials

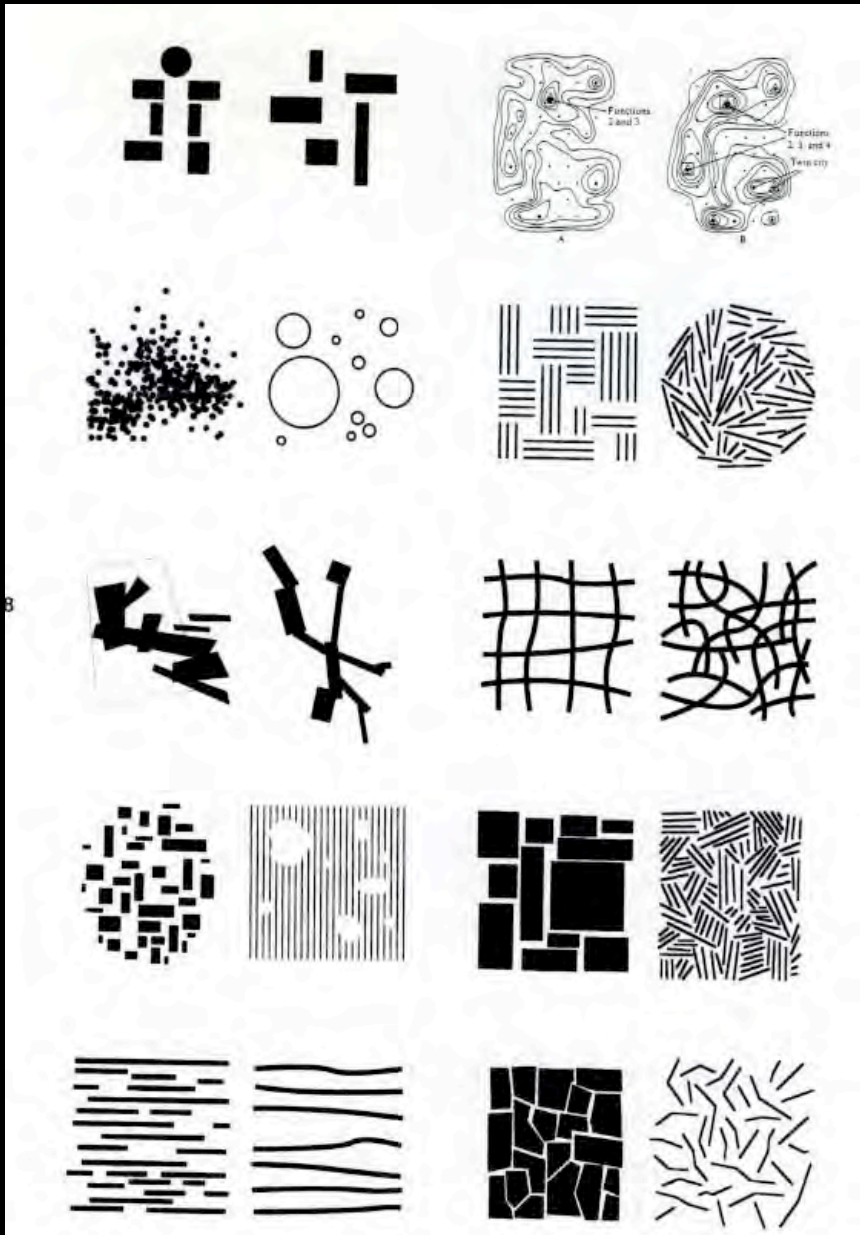

DIAGRAM

2D line drawings

- SINGLE LINE
- DASHED LINE
- SOLID FILL
- HATCH

Stan Allen

Field Conditions, 1995
grids and fields



Undifferentiated program

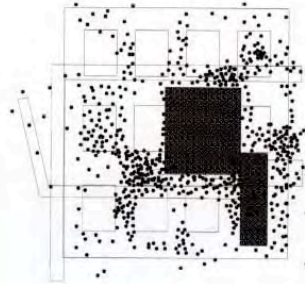

Activity clusters

DIAGRAM

2D line drawings

- SINGLE LINE
- DASHED LINE
- DOT PATTERN
- SOLID FILL
- HATCH

Stan Allen

Korean-American Museum of Art, Los Angeles, 1995

program, activity, movement, figure/ground

