

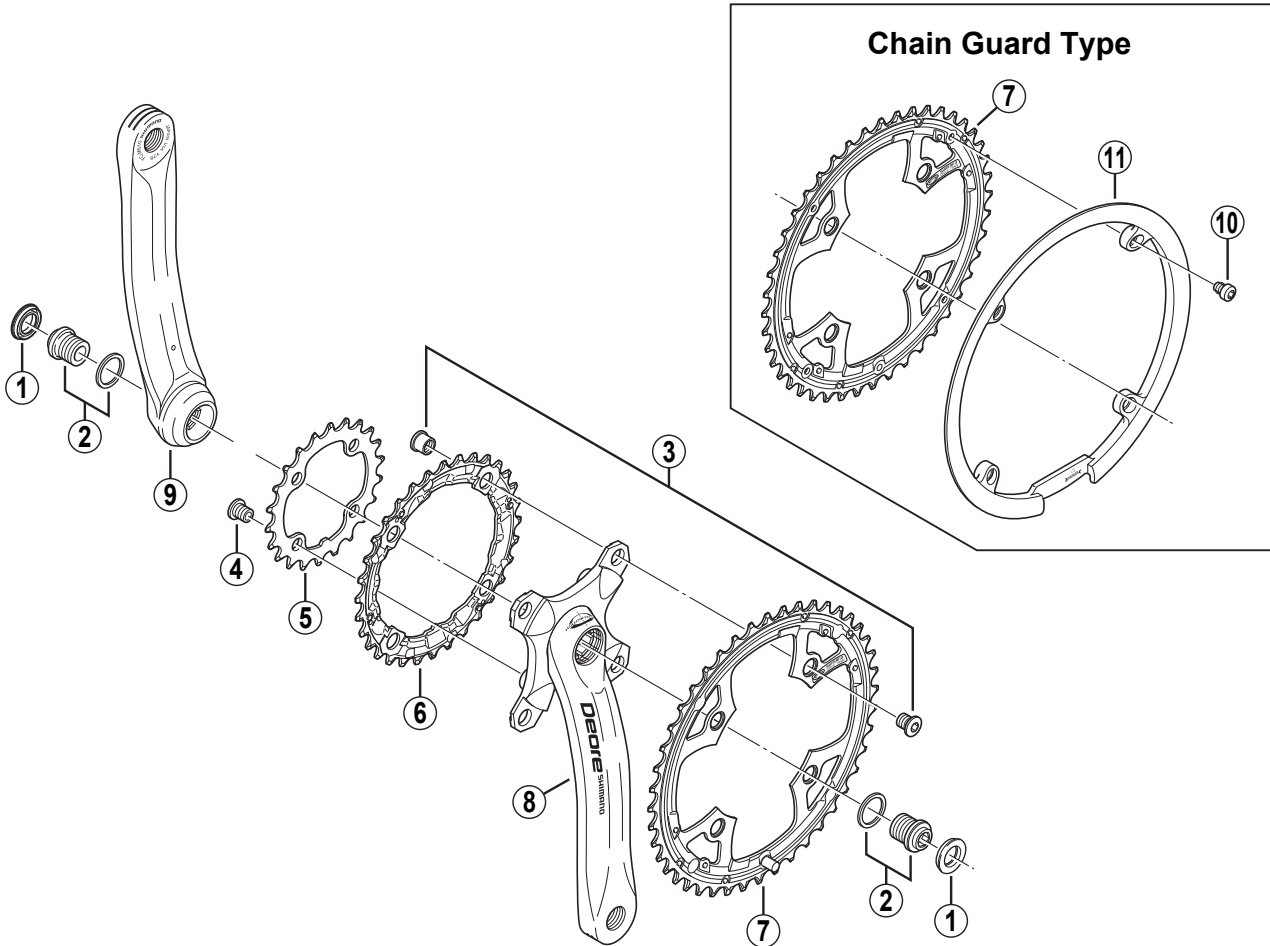

SHIMANO DEORE Front Chainwheel (Silver Version)

FC-M510-s

FC-M510-SK For Chain Case



- Chaining teeth combinations: 44-32-22T / 48-36-26T
- Bolt circle diameter: 104 mm...(For outer gear and middle gear), 64 mm...(For inner gear)

Q'TY	ITEM NO.	SHIMANO CODE NO.	DESCRIPTION
	1	Y-16V 07000	Crank Arm Cap
	2	Y-16V 98010	Crank Arm Fixing Bolt & Washer
	3	Y-1C8 98010	Double Gear Fixing Bolt (M8 x 8.5) & Nut (4 sets)
	4	Y-1BD98030	Inner Gear Fixing Bolt (M8 x 8.5 / 4 pcs.)
	5	Y-1DJ 22100	Chainring 22T (Silver)
		Y-1DS26000	Chainring 26T (Silver)
		Y-1DS98010	Chainring 32T (Silver)
	6	Y-1DS98200	Chainring 36T (Silver)
		Y-1DS98020	Chainring 44T (Silver)
	7	Y-1DS98030	Chainring 44T (Silver) for FC-M510-SK
		Y-1DS98040	Chainring 44T (Silver) for Chain Guard
		Y-1DS98210	Chainring 48T (Silver)
	8	Y-1DS98230	Chainring 48T (Silver) for Chain Guard
		Y-1EN98010	Right Hand Crank Arm 170 mm (Silver)
	8	Y-1EN98020	Right Hand Crank Arm 170 mm (Silver) for FC-M510-SK
		Y-1EN98030	Right Hand Crank Arm 175 mm (Silver)
		Y-1EN98040	Right Hand Crank Arm 175 mm (Silver) for FC-M510-SK
	9	Y-1EN98050	Left Hand Crank Arm 170 mm (Silver)
		Y-1EN98060	Left Hand Crank Arm 175 mm (Silver)
	10	Y-1CY98020	Chain Guard Fixing Bolt (4 pcs.)
	11	Y-1C6 18000	Chain Guard (for 44T)
		Y-1DS08000	Chain Guard (for 48T)