

Disc Brake
BR-M475 Brake Caliper
SM-RT61 Disc Rotor

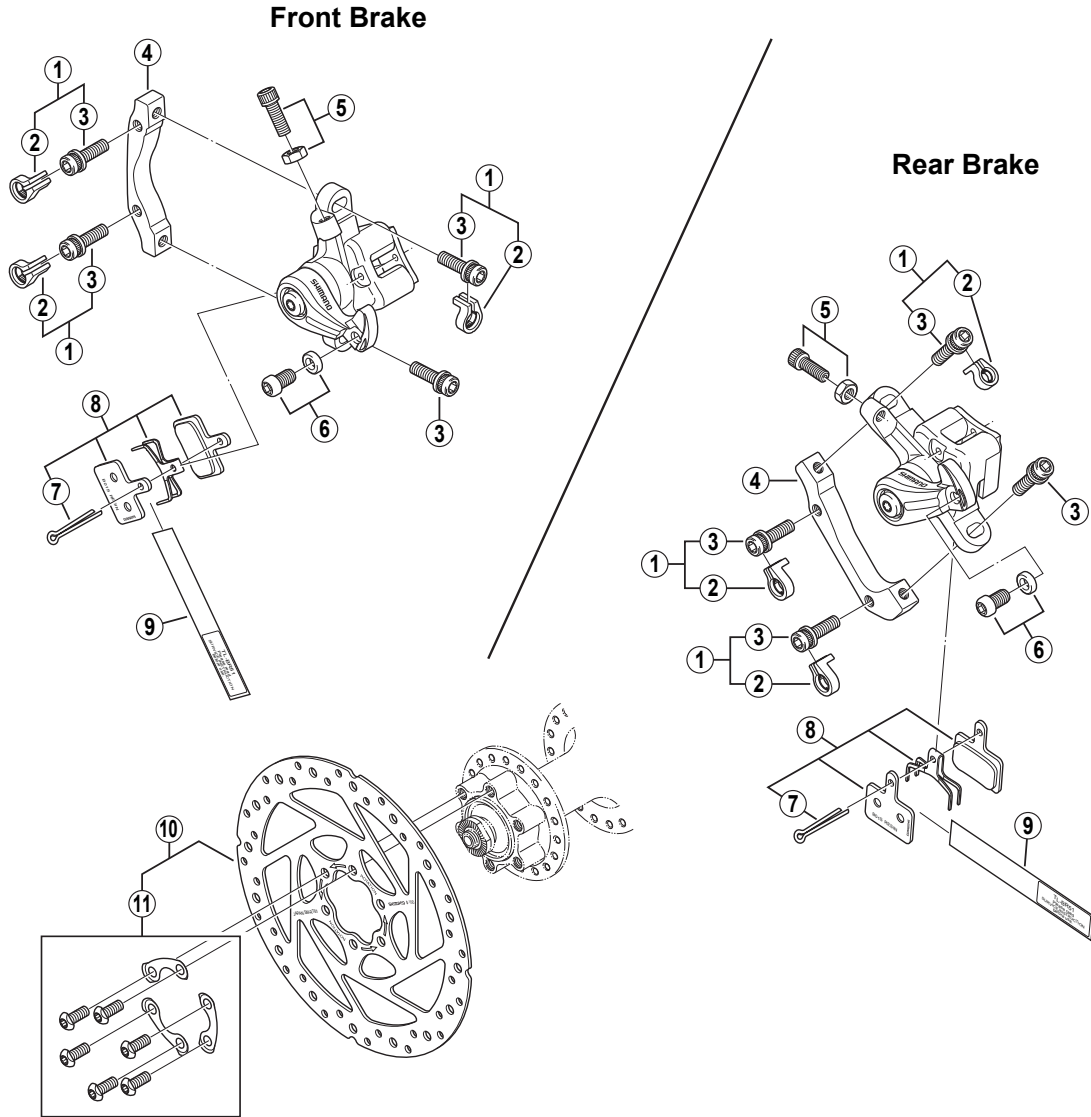

ITEM NO.	SHIMANO CODE NO.	DESCRIPTION
1	Y-8DS 98010	Adapter Fixing Bolt (M6 x 18.7) & Stop Ring
2	Y-8C5 11000	Stop Ring
3	Y-8C5 09020	Adapter Fixing Bolt (M6 x 18.7)
4	Y-8C5 08000	Adapter for Front
	Y-8C9 23000	Adapter for Rear
5	Y-8C9 98020	Cable Adjusting Bolt & Nut
6	Y-8B0 98020	Cable Fixing Bolt (M6 x 11.5) & Plate
7	Y-8C5 05000	Split Pin
* 8	Y-8FH 98030	Resin Pad (B01S) & Spring w/Split Pin
9	Y-8B6 98060	Spacer (TL-BR51)
10	I-SMRT61	SM-RT61 Disc Rotor Unit (φ160 mm)
11	Y-818 98030	Disc Rotor Fixing Bolt & Plate

0810-2179D

Specifications are subject to change without notice.

SHIMANO