

Thermoplastic Hose & R7 Couplings



Thermoplastic Hose

SAE 100R7, DIN EN 855 Hydraulic Hose



Recommended for: Medium pressure hydraulic oil lines

Tube: Nylon

Reinforcement: Synthetic fiber

Cover: Abrasion, ozone and weather resistant black urethane

Temperature Range: -40°F to +212°F

Part Number	Hose I.D. (in.)	Hose O.D.(in.)	Rated W.P.(psi)	Min. Burst (psi)	Min. Bend (in.)	Coupling Series
R7-02	1/8	0.34	3,000	12,000	1.0	R7 Series
R7-03	3/16	0.43	3,000	12,000	2.0	STD Series, R7 Series
R7-04	1/4	0.51	3,000	12,000	2.5	STD Series, R7 Series
R7-05	5/16	0.59	2,500	10,000	3.0	STD Series, R7 Series
R7-06	3/8	0.67	2,250	9,000	3.5	STD Series, R7 Series
R7-08	1/2	0.82	2,000	8,000	5.5	STD Series, R7 Series
R7-12	3/4	1.02	1,250	5,000	7.0	STD Series, R7 Series
R7-16	1	1.34	1,000	4,000	12.0	STD Series, R7 Series

SAE 100R7, DIN EN 855 Hydraulic Hose (Non-Conductive)



Recommended for: Medium pressure hydraulic oil lines to non-conductive standards

Tube: Nylon

Reinforcement: Synthetic fiber

Cover: Abrasion, ozone and weather resistant orange urethane

Temperature Range: -40°F to +212°F

Part Number	Hose I.D. (in.)	Hose O.D.(in.)	Rated W.P.(psi)	Min. Burst (psi)	Min. Bend (in.)	Coupling Series
R7-02 NC	1/8	0.34	3,000	12,000	1.0	R7 Series
R7-03 NC	3/16	0.43	3,000	12,000	2.0	STD Series, R7 Series
R7-04 NC	1/4	0.51	3,000	12,000	2.5	STD Series, R7 Series
R7-05 NC	5/16	0.59	2,500	10,000	3.0	STD Series, R7 Series
R7-06 NC	3/8	0.67	2,250	9,000	3.5	STD Series, R7 Series
R7-08 NC	1/2	0.82	2,000	8,000	5.5	STD Series, R7 Series
R7-12 NC	3/4	1.02	1,250	5,000	7.0	STD Series, R7 Series
R7-16 NC	1	1.34	1,000	4,000	12.0	STD Series, R7 Series

Thermoplastic Hose

SAE 100R7, DIN EN 855 Hydraulic Hose Twin Line



Recommended for: Medium pressure hydraulic oil lines twin-line applications

Tube: Nylon

Reinforcement: Synthetic fiber

Cover: Abrasion, ozone and weather resistant black urethane

Temperature Range: -40°F to +212°F

Part Number	Hose I.D. (in.)	Hose O.D.(in.)	Rated W.P.(psi)	Min. Burst (psi)	Min. Bend (in.)	Coupling Series
R7-03 TW	3/16	0.43	3,000	12,000	2.0	STD Series, R7 Series
R7-04 TW	1/4	0.51	3,000	12,000	2.5	STD Series, R7 Series
R7-05 TW	5/16	0.59	2,500	10,000	3.0	STD Series, R7 Series
R7-06 TW	3/8	0.67	2,250	9,000	3.5	STD Series, R7 Series
R7-08 TW	1/2	0.82	2,000	8,000	5.5	STD Series, R7 Series

SAE 100R7, DIN EN 855 1SN Hydraulic Hose Twin Line (Non-Conductive)

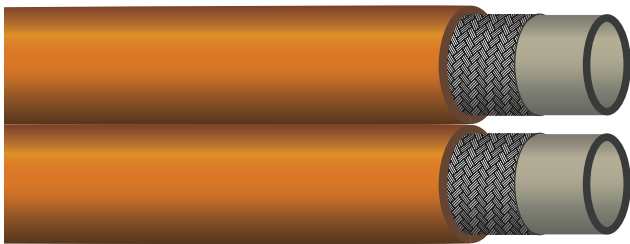

Recommended for: Medium pressure hydraulic oil lines for non-conductive twin-line applications

Tube: Nylon

Reinforcement: Synthetic fiber

Cover: Abrasion, ozone and weather resistant orange urethane

Temperature Range: -40°F to +212°F

Part Number	Hose I.D. (in.)	Hose O.D.(in.)	Rated W.P.(psi)	Min. Burst (psi)	Min. Bend (in.)	Coupling Series
R7-04 TW NC	1/4	0.51	3,000	12,000	2.5	STD Series, R7 Series
R7-05 TW NC	5/16	0.59	2,500	10,000	3.0	STD Series, R7 Series
R7-06 TW NC	3/8	0.67	2,250	9,000	3.5	STD Series, R7 Series
R7-08 TW NC	1/2	0.82	2,000	8,000	5.5	STD Series, R7 Series

Thermoplastic Hose

SAE 100R18 Hydraulic Hose



Recommended for: High pressure hydraulic oil lines

Tube: Nylon

Reinforcement: Two synthetic fiber braids

Cover: Abrasion, ozone and weather resistant black urethane

Temperature Range: -40°F to +212°F

Part Number	Hose I.D. (in.)	Hose O.D.(in.)	Rated W.P.(psi)	Min. Burst (psi)	Min. Bend (in.)	Coupling Compatible
R18-04	1/4	0.49	3,000	12,000	2.0	STD Series, R7 Series
R18-05	5/16	0.61	3,000	12,000	2.5	STD Series, R7 Series
R18-06	3/8	0.66	3,000	12,000	3.0	STD Series, R7 Series
R18-08	1/2	0.85	3,000	12,000	5.5	STD Series, R7 Series

SAE 100R8, DIN EN 855 Hydraulic Hose



Recommended for: High pressure hydraulic oil lines

Tube: Nylon

Reinforcement: Two synthetic fiber braids

Cover: Abrasion, ozone and weather resistant black urethane

Temperature Range: -40°F to +212°F

Part Number	Hose I.D. (in.)	Hose O.D.(in.)	Rated W.P.(psi)	Min. Burst (psi)	Min. Bend (in.)	Coupling Series
R8-03	3/16	0.52	5,000	20,000	2.0	STD Series
R8-04	1/4	0.63	5,000	20,000	2.5	STD Series
R8-06	3/8	0.77	4,000	16,000	3.5	STD Series
R8-08	1/2	0.89	3,500	14,000	5.5	STD Series

Thermoplastic Hose

SAE 100R8, DIN EN 855 Hydraulic Hose (Non-Conductive)



Recommended for: High pressure non-conductive hydraulic oil lines

Tube: Nylon

Reinforcement: Two synthetic fiber braids

Cover: Abrasion, ozone and weather resistant orange urethane

Temperature Range: -40°F to +212°F

Part Number	Hose I.D. (in.)	Hose O.D.(in.)	Rated W.P.(psi)	Min. Burst (psi)	Min. Bend (in.)	Coupling Series
R8-03 NC	3/16	0.52	5,000	20,000	2.0	STD Series
R8-04 NC	1/4	0.63	5,000	20,000	2.5	STD Series
R8-06 NC	3/8	0.77	4,000	16,000	3.5	STD Series
R8-08 NC	1/2	0.89	3,500	14,000	5.5	STD Series

SAE 100R8, DIN EN 855 Hydraulic Hose Twin Line



Recommended for: High pressure hydraulic oil lines for twin line applications

Tube: Nylon

Reinforcement: Two synthetic fiber braids

Cover: Abrasion, ozone and weather resistant black urethane

Temperature Range: -40°F to +212°F

Part Number	Hose I.D. (in.)	Hose O.D.(in.)	Rated W.P.(psi)	Min. Burst (psi)	Min. Bend (in.)	Coupling Series
R8-04 TW	1/4	0.63	5,000	20,000	2.5	STD Series
R8-06 TW	3/8	0.77	4,000	16,000	3.5	STD Series
R8-08 TW	1/2	0.89	3,500	14,000	5.5	STD Series

R7 Couplings

FFX - O-Ring Face Seal Female Coupling

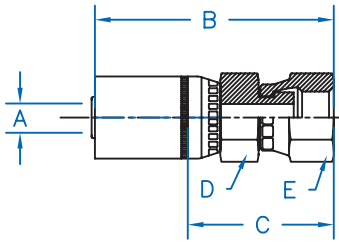

Part Number	A (Hose I.D. - inches)	B	C	D	E	Thread
FFX-04-04-R7	1/4	2.57	1.31	9/16	11/16	9/16 - 18
FFX-04-06-R7	1/4	2.51	1.25	11/16	13/16	11/16 - 16
FFX-05-06-R7	5/16	2.58	1.27	11/16	13/16	11/16 - 16
FFX-06-04-R7	3/8	2.84	1.35	3/4	11/16	9/16 - 18
FFX-06-06-R7	3/8	2.77	1.27	11/16	7/8	11/16 - 16
FFX-06-08-R7	3/8	2.95	1.45	7/8	15/16	13/16 - 16
FFX-08-08-R7	1/2	3.03	1.53	7/8	15/16	13/16 - 16
FFX-12-12-R7	3/4	3.66	2.07	1-1/8	1-3/8	1-3/16 - 12
FFX-16-16-R7	1	4.33	2.05	1-3/8	1-5/8	1-7/16 - 12

R7 Couplings

FJX - 37° JIC Female Swivel

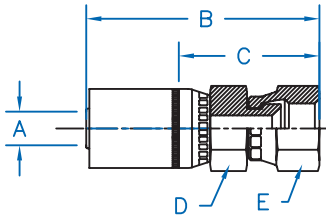

Part Number	A (Hose I.D. - inches)	B	C	D	E	Thread
FJX-02-03-R7	1/8	1.65	1.05	1/2	9/16	3/8 - 24
FJX-02-04-R7	1/8	1.72	1.10	1/2	5/8	7/16 - 20
FJX-03-04-R7	3/16	2.19	1.13	9/16	5/8	7/16 - 20
FJX-03-05-R7	3/16	2.19	1.13	9/16	3/4	1/2 - 20
FJX-04-03-R7	1/4	2.44	1.19	5/8	9/16	3/8 - 24
FJX-04-04-R7	1/4	2.36	1.10	9/16	5/8	7/16 - 20
FJX-04-05-R7	1/4	2.50	1.25	9/16	3/4	1/2 - 20
FJX-04-06-R7	1/4	2.45	1.19	9/16	3/4	9/16 - 18
FJX-04-08-R7	1/4	2.63	1.37	3/4	7/8	3/4 - 16
FJX-05-04-R7	5/16	2.56	1.25	5/8	5/8	7/16 - 20
FJX-05-05-R7	5/16	2.56	1.25	5/8	3/4	1/2 - 20
FJX-05-06-R7	5/16	2.51	1.20	5/8	3/4	9/16 - 18
FJX-06-04-R7	3/8	2.62	1.12	11/16	5/8	7/16 - 20
FJX-06-05-R7	3/8	2.76	1.26	3/4	3/4	1/2 - 20
FJX-06-06-R7	3/8	2.70	1.36	11/16	3/4	9/16 - 18
FJX-06-08-R7	3/8	2.86	1.34	11/16	15/16	3/4 - 16
FJX-08-06-R7	1/2	2.94	1.43	7/8	11/16	9/16 - 18
FJX-08-08-R7	1/2	2.85	1.59	7/8	15/16	3/4 - 16
FJX-08-10-R7	1/2	3.09	1.59	7/8	1-1/16	7/8 - 14
FJX-12-10-R7	3/4	3.26	1.67	1-1/8	1-1/16	7/8 - 14
FJX-12-12-R7	3/4	3.25	1.70	1-1/8	1-1/4	1-1/16 - 12
FJX-12-14-R7	3/4	3.35	1.76	1-3/8	1-1/2	1-3/16 - 12
FJX-12-16-R7	3/4	3.23	1.67	1-3/8	1-1/2	1-5/16 - 12
FJX-16-12-R7	1	3.41	1.72	1-3/8	1-1/4	1-1/16 - 12
FJX-16-16-R7	1	3.39	1.66	1-3/8	1-1/2	1-5/16 - 12

R7 Couplings

FJX45 - 37° JIC Female 45° Bent Tube Swivel

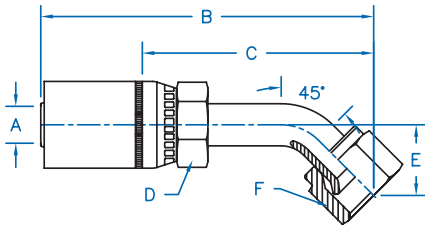

Part Number	A (Hose I.D. - inches)	B	C	D	E	F	Thread
FJX45-03-04-R7	3/16	2.36	1.30	9/16	0.39	9/16	7/16 - 20
FJX45-03-05-R7	3/16	2.50	1.44	9/16	0.53	5/8	1/2 - 20
FJX45-04-04-R7	1/4	3.14	1.88	5/8	0.39	9/16	7/16 - 20
FJX45-04-05-R7	1/4	3.17	1.91	5/8	0.39	5/8	1/2 - 20
FJX45-04-06-R7	1/4	3.21	1.96	5/8	0.43	11/16	9/16 - 18
FJX45-05-04-R7	5/16	3.19	1.88	5/8	0.39	9/16	7/16 - 20
FJX45-05-06-R7	5/16	3.29	1.98	5/8	0.43	11/16	9/16 - 18
FJX45-06-04-R7	3/8	2.81	1.30	3/4	0.47	9/16	7/16 - 20
FJX45-06-05-R7	3/8	2.95	1.45	11/16	0.53	5/8	1/2 - 20
FJX45-06-06-R7	3/8	3.47	1.97	11/16	0.43	11/16	9/16 - 18
FJX45-06-08-R7	3/8	3.81	2.31	3/4	0.59	7/8	3/4 - 16
FJX45-08-06-R7	1/2	3.17	1.48	7/8	0.59	11/16	9/16 - 18
FJX45-08-08-R7	1/2	3.91	2.41	7/8	0.59	7/8	3/4 - 16
FJX45-08-10-R7	1/2	3.56	2.06	7/8	0.63	1	7/8 - 14
FJX45-12-12-R7	3/4	3.90	2.56	1-1/8	0.83	1-1/4	1-1/16 - 12
FJX45-16-16-R7	1	4.92	2.64	1-3/8	1.15	1-1/2	1-5/16 - 12

FJX90L - 37° JIC Female 90° Long Drop Swivel

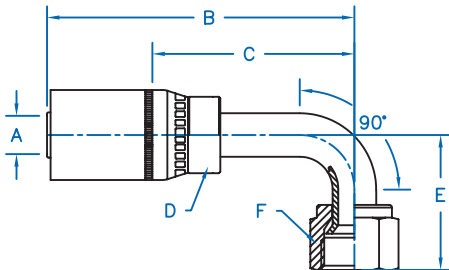

Part Number	A (Hose I.D. - inches)	B	C	D	E	F	Thread
FJX90L-04-04-R7	1/4	2.32	1.72	5/8	0.83	9/16	7/16 - 20
FJX90L-04-06-R7	1/4	2.44	1.19	5/8	2.18	11/16	9/16 - 18
FJX90L-06-04-R7	3/8	2.58	1.06	3/4	1.81	9/16	7/16 - 20
FJX90L-06-06-R7	3/8	3.38	1.19	11/16	2.13	11/16	9/16 - 18
FJX90L-06-08-R7	3/8	3.63	2.13	3/4	2.52	7/8	3/4 - 16
FJX90L-08-08-R7	1/2	3.75	2.25	7/8	2.52	7/8	3/4 - 16
FJX90L-08-10-R7	1/2	3.50	2.00	7/8	2.76	1	7/8 - 14
FJX90L-12-12-R7	3/4	3.78	2.42	1-3/8	4.33	1-1/2	1-1/16 - 12
FJX90L-16-16-R7	1	4.65	2.37	1-3/8	4.33	1-1/2	1-5/16 - 12

R7 Couplings

FJX90 - 37° JIC Female 90° Bent Tube Swivel

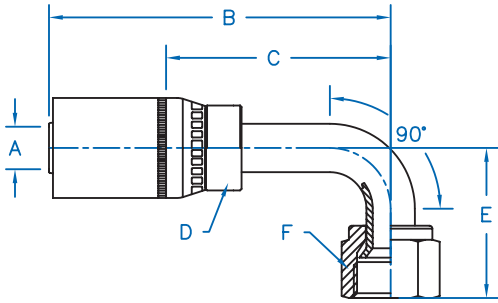

Part Number	A (Hose I.D. - inches)	B	C	D	E	F	Thread
FJX90-03-04-R7	3/16	1.89	0.95	7/16	0.88	9/16	7/16 - 20
FJX90-03-05-R7	3/16	2.30	1.25	9/16	0.875	5/8	1/2 - 20
FJX90-04-04-R7	1/4	3.04	1.78	5/8	0.83	9/16	7/16 - 20
FJX90-04-05-R7	1/4	3.07	1.81	5/8	0.83	5/8	1/2 - 20
FJX90-04-06-R7	1/4	3.17	1.91	5/8	0.91	11/16	9/16 - 18
FJX90-05-06-R7	5/16	2.69	1.38	5/8	0.94	11/16	9/16 - 18
FJX90-06-04-R7	3/8	2.56	1.06	3/4	0.88	9/16	7/16 - 20
FJX90-06-05-R7	3/8	2.77	1.27	11/16	0.88	5/8	1/2 - 20
FJX90-06-06-R7	3/8	3.38	1.88	11/16	0.86	11/16	9/16 - 18
FJX90-06-08-R7	3/8	3.63	2.13	3/4	1.12	7/8	3/4 - 16
FJX90-08-08-R7	1/2	3.75	2.25	7/8	1.13	7/8	3/4 - 16
FJX90-08-10-R7	1/2	3.25	1.75	7/8	1.23	1	7/8 - 14
FJX90-12-10-R7	3/4	3.48	1.89	1-1/8	1.23	1	7/8 - 14
FJX90-12-12-R7	3/4	3.76	2.30	1-1/8	1.83	1-1/4	1-1/16 - 12
FJX90-12-16-R7	3/4	4.19	2.31	1-3/8	2.50	1-1/2	1-5/16 - 12
FJX90-16-16-R7	1	4.65	2.37	1-3/8	2.5	1-1/2	1-5/16 - 12

R7 Couplings

Male Boss O-Ring Rigid

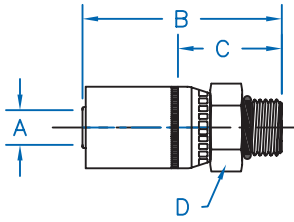

Part Number	A (Hose I.D. - inches)	B	C	D	Thread
MB-03-04-R7	3/16	1.92	0.86	9/16	7/16 - 20
MB-04-04-R7	1/4	2.11	0.86	5/8	7/16 - 20
MB-04-05-R7	1/4	2.11	0.86	5/8	1/2 - 20
MB-04-06-R7	1/4	2.15	0.89	11/16	9/16 - 18
MB-04-08-R7	1/4	2.34	1.09	7/8	3/4 - 16
MB-06-06-R7	3/8	2.50	1.00	3/4	9/16 - 18
MB-06-08-R7	3/8	2.54	1.04	7/8	3/4 - 16
MB-06-10-R7	3/8	2.65	1.15	1	7/8 - 14
MB-08-08-R7	1/2	2.68	1.18	15/16	3/4 - 16
MB-08-10-R7	1/2	2.75	1.85	1-1/16	7/8 - 14
MB-08-12-R7	1/2	2.84	1.34	1-1/4	1-1/16 - 12
MB-12-12-R7	3/4	2.95	1.36	1-1/4	1-1/16 - 12
MB-12-16-R7	3/4	3.05	1.46	1-1/2	1-5/16 - 12
MB-16-16-R7	1	3.21	1.48	1-1/2	1-5/16 - 12

MP - Male Pipe NPTF Rigid

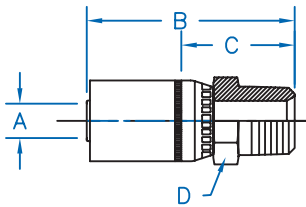

Part Number	A (Hose I.D. - inches)	B	C	D	Thread
MP-02-02-R7	1/8	1.34	0.74	1/2	1/8 - 27
MP-03-02-R7	3/16	1.93	0.87	9/16	1/8 - 27
MP-03-04-R7	3/16	1.90	0.96	11/16	1/4 - 18
MP-04-02-R7	1/4	2.13	0.88	5/8	1/8 - 27
MP-04-04-R7	1/4	2.32	1.06	11/16	1/4 - 18
MP-04-06-R7	1/4	2.41	1.15	3/4	3/8 - 18
MP-04-08-R7	1/4	2.66	1.40	15/16	1/2 - 14
MP-05-04-R7	5/16	2.37	1.06	11/16	1/4 - 18
MP-05-06-R7	5/16	2.46	1.15	3/4	3/8 - 18
MP-06-04-R7	3/8	2.67	1.17	3/4	1/4 - 18
MP-06-06-R7	3/8	2.67	1.17	3/4	3/8 - 18
MP-06-08-R7	3/8	2.92	1.42	15/16	1/2 - 14
MP-08-06-R7	1/2	2.74	1.25	7/8	3/8 - 18
MP-08-08-R7	1/2	3.00	1.50	15/16	1/2 - 14
MP-12-12-R7	3/4	3.10	1.51	1-1/8	3/4 - 14
MP-12-16-R7	3/4	3.29	1.70	1-3/8	1-11 - 1/2
MP-16-12-R7	1	3.26	1.53	1-1/8	3/4 - 14
MP-16-16-R7	1	3.45	1.72	1-3/8	1-11 - 1/2

R7 Couplings

MJ - 37° JIC Male Rigid

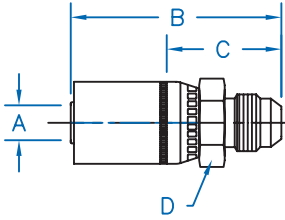

Part Number	A (Hose I.D. - inches)	B	C	D	Thread
MJ-03-04-R7	3/16	2.11	1.05	9/16	7/16 - 20
MJ-04-04-R7	1/4	2.30	1.05	5/8	7/16 - 20
MJ-04-05-R7	1/4	2.31	1.05	5/8	1/2 - 20
MJ-04-06-R7	1/4	2.31	1.06	3/4	9/16 - 18
MJ-05-05-R7	5/16	2.36	1.05	5/8	1/2 - 20
MJ-05-06-R7	5/16	2.36	1.05	11/16	9/16 - 18
MJ-06-04-R7	3/8	2.66	1.16	11/16	7/16 - 20
MJ-06-06-R7	3/8	2.66	1.17	3/4	9/16 - 18
MJ-06-08-R7	3/8	2.76	1.27	13/16	3/4 - 16
MJ-06-10-R7	3/8	2.94	1.44	7/8	7/8 - 14
MJ-08-06-R7	1/2	2.74	1.24	7/8	9/16 - 16
MJ-08-08-R7	1/2	2.85	1.35	7/8	3/4 - 16
MJ-08-10-R7	1/2	3.00	1.51	15/16	7/8 - 14
MJ-08-12-R7	1/2	3.11	1.61	1-1/8	1-1/16 - 12
MJ-12-10-R7	3/4	3.06	1.47	1-1/8	7/8 - 14
MJ-12-12-R7	3/4	3.22	1.63	1-1/8	1-1/16 - 12
MJ-12-14-R7	3/4	3.24	1.65	1-1/4	1-3/16 - 12
MJ-12-16-R7	3/4	3.27	1.67	1-3/8	1-5/16 - 12
MJ-16-16-R7	1	3.42	1.69	1-3/8	1-5/16 - 12



KURT

HYDRAULICS

www.kurthydraulics.com

[Other Kurt Divisions](#)

www.kurt.com

www.kurtworkholding.com

www.kurtengineeredsystems.com

Kurt Hydraulics 114 West O Street, Lyman, NE 69352
www.kurthydraulics.com | Toll Free: 866.257.7995 | hydraulicsales@kurt.com