



HAPPICH
A GHE Group Company

Nothammer

Emergency Hammer



K 51/9-06/06

HAPPICH – Ihr Partner
für Komponenten und Systeme

HAPPICH – Your Partner
for Components and Systems

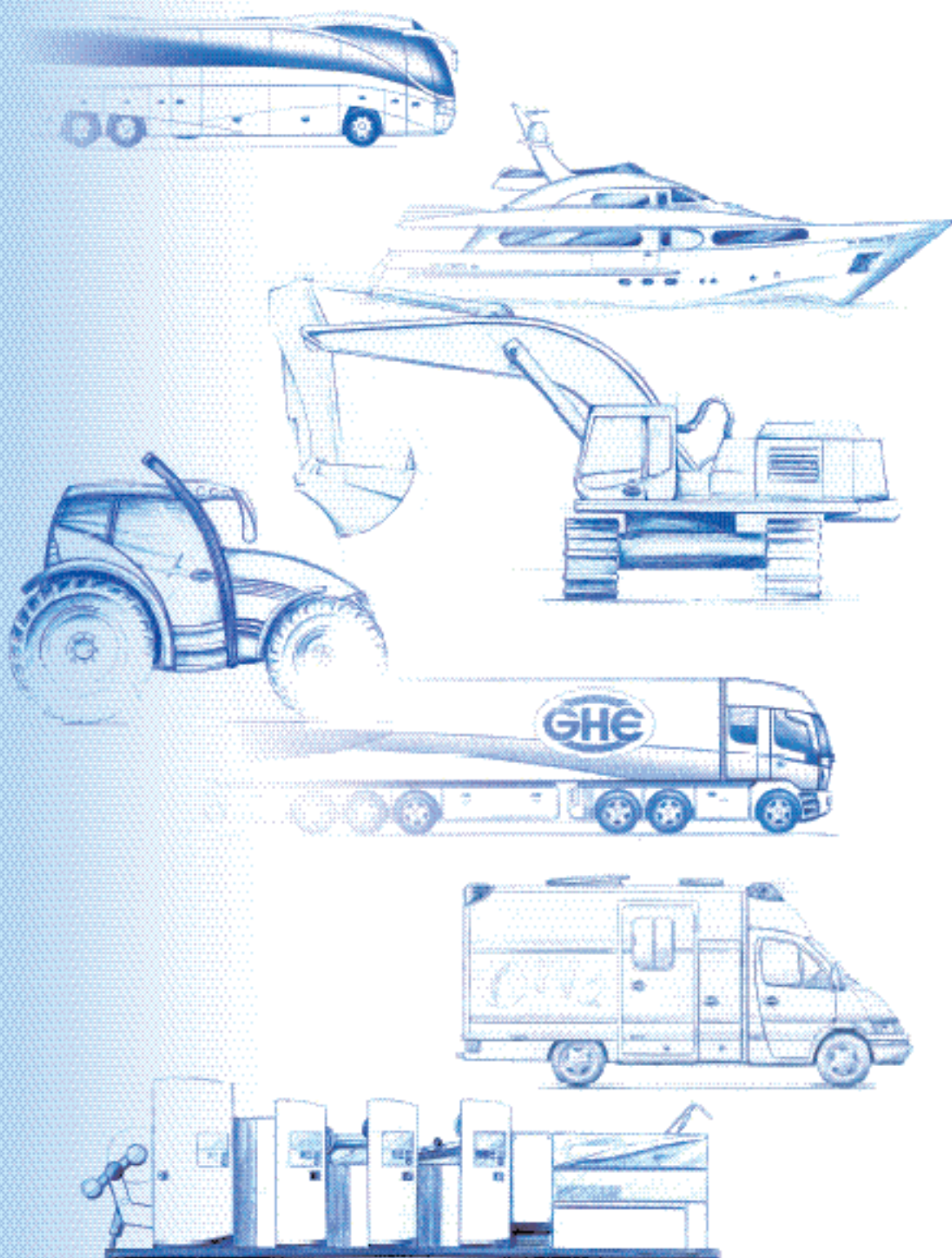

Zukunft durch Qualität

The Future assured by Quality



TÜV-ZERTIFIZIERUNG
DIN EN ISO 9001:2000
DIN EN ISO 14001:2004

Mit diesen Zertifikaten wurde vom TÜV Rheinland bescheinigt, dass sich die gesamte HAPPICH-Fahrzeug- und Industrieteile GmbH nach international genomten Qualitäts- und Umweltstandards ausrichtet und deren Umsetzung in der Praxis nachgewiesen worden ist. Für HAPPICH ist es die offizielle Bestätigung für ein umfassendes Managementsystem, das die Zufriedenheit unserer internen und externen Kunden weiter forciert. Der ständigen Weiterentwicklung dieses Managementsystems fühlen wir uns auch zukünftig verpflichtet.



TÜV CERTIFICATION
DIN EN ISO 9001:2000
DIN EN ISO 14001:2004

By issuing these certificates TÜV Rheinland, a member of Germany's independent Technical Supervision Association, has certified that HAPPICH Fahrzeug und Industrieteile GmbH is run in its entirety in conformity with internationally recognised quality and environmental standards and that proof was furnished that these standards are being implemented in HAPPICH's business routines. For HAPPICH they are the official acknowledgement of a comprehensive management system which will further its goal of greater customer satisfaction. In the future we shall continue to abide by our commitment to develop this management system constantly.

Wir entwickeln und produzieren Komponenten und Systeme

HAPPICH – Ihr Partner für Komponenten und Systeme

HAPPICH, ein Unternehmen der GHE Group, entwickelt und liefert standardisierte Produkte sowie kundenspezifische Komponenten und Systeme für die Ausstattung von Nutz- und Spezialfahrzeugen, ebenfalls für den Kabinenbereich von Land- und Baumaschinen, Schienenfahrzeugen, Booten und Schiffen. Das Lieferprogramm von HAPPICH wird auch in Karosserieaufbauten und in Wohnmobilen und Caravans eingesetzt.

HAPPICH beschäftigt über 500 Mitarbeiter in ihren verschiedenen europäischen Standorten. Unterstützt wird HAPPICH durch mehr als 50 Vertretungen weltweit. Innerhalb der Europäischen Union werden die Kunden durch Anwendungstechniker, Key Accountants, Tochtergesellschaften und Vertretungen betreut.

► Produktions-Technologien

Extrusion und Koextrusion

Vulkanisation

Wärmepressverformung

Spritzguß

Druckguß

Systemmontage

Textilkaschierung

Textilkonfektion

Stanzen, Lochen,
Streckbiegen

Eloxieren und andere
Oberflächenbehandlungen

Verkleben

► Engineering

Technische Dokumentation

Erstellung von Spezifikationen,
Normenfestlegung

Machbarkeitsstudien

FMEA-Untersuchungen

Modellbau, Experimental-
und Prüflabors

► Logistik und IT

Neueste Informations-
technologien

Technisch: Catia 2D und 3D

Kommerziell: mySAP R3
Automotive Version

SAP-Referenzkunde

JIT-Lieferungen

Lagergestützte Abläufe für
Standardkomponenten

► Qualitätssysteme

TÜV-Zertifizierung nach
ISO 9001 sowie ISO 14001

HAPPICH PLZEN
mit Entwicklung und
Vertrieb Wuppertal
TÜV-zertifiziert nach
ISOTS 16949

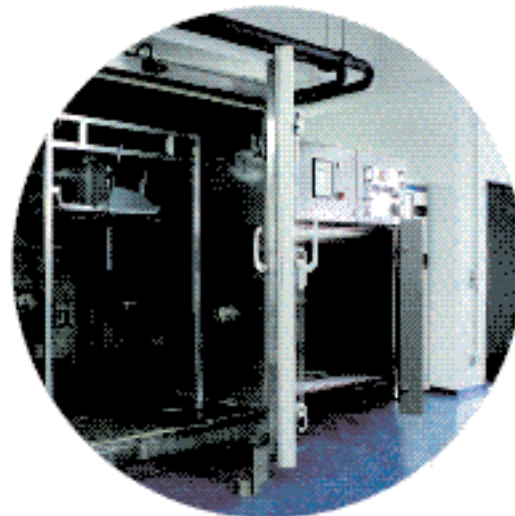

We develop and produce Components and Systems

► Production Technologies

Extrusion and Co-extrusion
Vulcanisation
Thermal Press Moulding
Injection Moulding
Pressure Die-casting
System Assembly
Textile Lamination
Textile Finishing
Stamping, Punching,
Stretch-Bending
Anodising and other
Surface Treatments
Bonding

► Engineering

Technical Documentation
Drawing-up Specifications
Setting Standards
Feasibility Studies
FMEA Analysis
Model-making, Experimental
and Test Laboratories

► Logistics and IT

Latest Information
Technology
Technical: Catia 2D and 3D
Commercial: mySAP R3 –
Automotive Version
SAP Reference Customer
JIT Deliveries
Warehouse supported
Procedures for Standard
Components

► Quality Systems

TÜV certified to ISO 9001
and ISO 14001
HAPPICH PLZEN with R&D
and sales support from
Wuppertal certified to
ISOTS 16949

HAPPICH – your Partner for Components and Systems

HAPPICH, a GHE Group company, develops, engineers and supplies standardised products and tailor-made components and systems for applications in commercial and special vehicles as well as for equipping the cabins of agricultural and building machinery, rolling stock, boats and ships. HAPPICH's product range is also suitable for body making, caravans and motor homes.

HAPPICH employs more than 500 in its various European locations and is supported by over 50 agencies and representatives world-wide. Customers in countries inside the European Union are served by application engineers, key accountants, subsidiaries and representatives.



Sachwortverzeichnis

Index

Sachwortverzeichnis	Seite	Index	Page
A Anwendungsbeispiel	11	E Emergency Hammer Brackets	5, 10
N Nothämmer	4-10	Emergency Hammers	4-10
Nothammerhalterungen	5, 10	Example of possible Application	11
T Technische Übersicht	2, 3	T Technical Data	2, 3

Artikel-Nummern

Part Numbers

	Seite / Page
274 0009	10
274 0010	10
274 0037	4
274 0038	5
274 0039	5
274 0043	5
274 0044	6
274 0045	4
274 0046	7
274 0047	7
274 0048	8
274 0049	9
274 0050	9

Hinweis

Die technischen Angaben sind unverbindlich und entsprechen dem heutigen Stand. Änderungen behalten wir uns vor. Für Druckfehler oder Irrtümer übernehmen wir keine Gewähr. Rechtsansprüche jeglicher Art können aus der Benutzung des Kataloges nicht hergeleitet werden.

Note

The technical information contained in this catalogue is not binding and reflects the current status at the time of going into print. We reserve the right to make alterations and assume no responsibility whatsoever for printing errors, mistakes or omissions. No legal claims whatsoever may be derived from the use of this catalogue.

Der Nothammer mit eingesetzter Hartmetallspitze

The Emergency Hammer with an inserted toughened metal tip

Mehr Sicherheit, weniger Verletzungsgefahr, höhere Leistung für die Zertrümmerung von Scheiben mit geringem Kraftaufwand sind die Vorteile des **patentierten** und vom **TÜV Rheinland GS-geprüften** Nothammers von Happich.



Geprüft nach 95/28/EG und DIN 55 10



More safety, less danger of injury, a higher degree of glass smashing performance with a minimum of effort are all features of the Happich emergency hammer **patented** and **approved to the safety standards set by the TÜV Rheinland**, an independent technical supervision organisation.



Tested to 95/28/EC and DIN 55 10

**EP Patent
Nr. 0 134 558**

In ÖPNV-Bussen des Standardtyps müssen pro Fahrzeug mindestens vier Nothämmer an bestimmten Plätzen installiert sein.

Die Nothämmer befinden sich in Halterungen in unmittelbarer Nähe der Seitenscheiben, die aufgrund einer besonderen Kennzeichnung als Notausstieg vorgesehen sind und deren Einscheibensicherheitsglas (ESG) mit Hilfe des Nothammers leicht zertrümmert werden kann. Bei Gelenkbussen im kommunalen Verkehr erhöht sich die vorgeschriebene Zahl der Nothämmer auf mindestens sechs pro Fahrzeug.



**EP Patent
Nr. 0 134 558**

In standard public transport buses at least four emergency hammers must be installed at defined locations in the vehicle.

The emergency hammers are stowed in brackets in the direct vicinity of all side windows especially designated as emergency exits and made of single pane safety glass which can easily be smashed with the help of the emergency hammer. In cases where communities use articulated buses for public transport the minimum number of emergency hammers required goes up to six per vehicle.



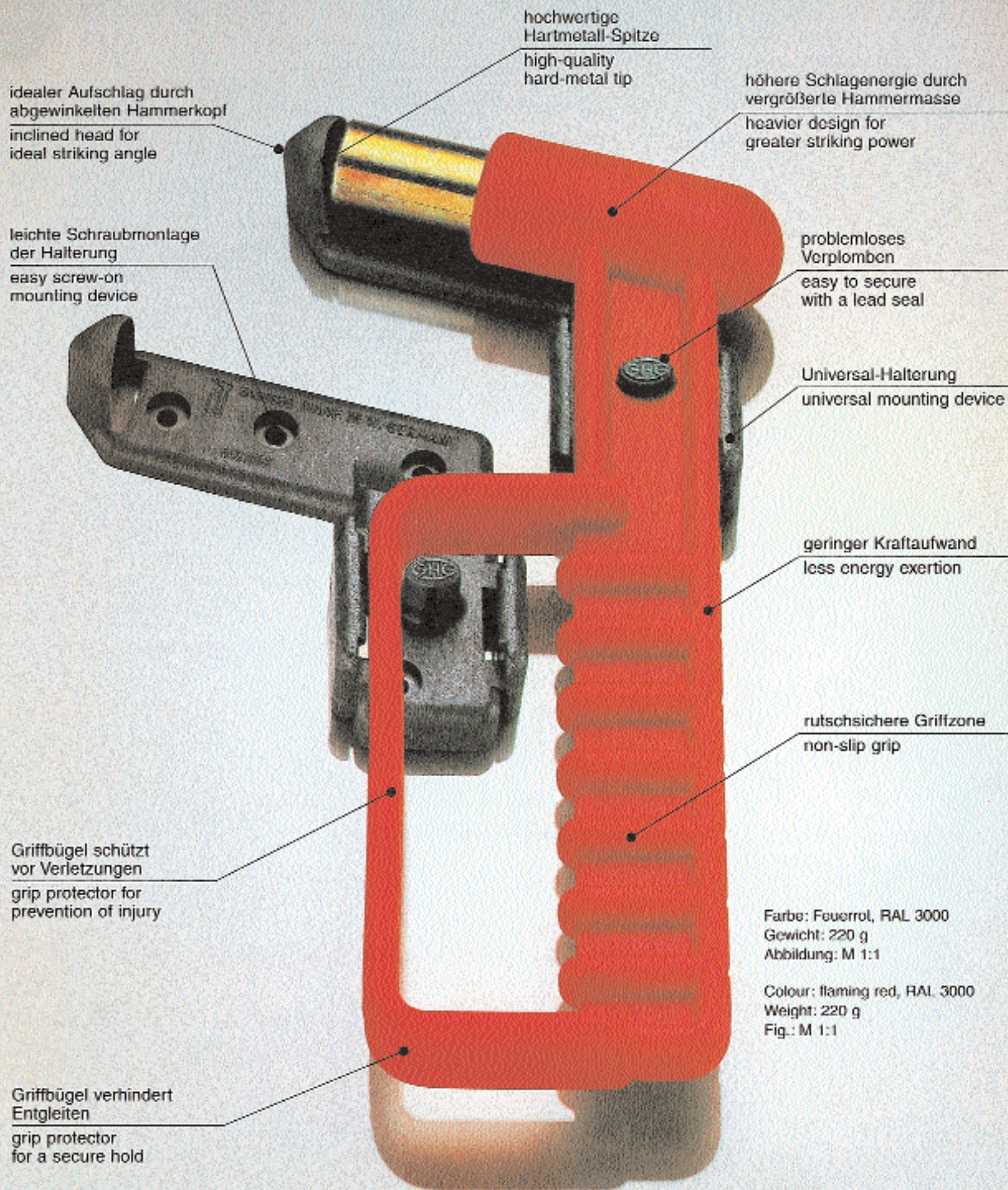

hochwertige
Hartmetall-Spitze
high-quality
hard-metal tip

höhere Schlagenergie durch
vergrößerte Hammermasse
heavier design for
greater striking power

idealer Aufschlag durch
abgewinkelten Hammerkopf
inclined head for
ideal striking angle

leichte Schraubmontage
der Halterung
easy screw-on
mounting device

problemloses
Verplomben
easy to secure
with a lead seal

Universal-Halterung
universal mounting device

geringer Kraftaufwand
less energy exertion

rutschsichere Griffzone
non-slip grip

Griffbügel schützt
vor Verletzungen
grip protector for
prevention of injury

Griffbügel verhindert
Entgleiten
grip protector
for a secure hold

Farbe: Feuerrot, RAL 3000
Gewicht: 220 g
Abbildung: M 1:1

Colour: flaming red, RAL 3000
Weight: 220 g
Fig.: M 1:1

Nothammer

Emergency Hammer



Geprüft nach 95/28/EG und DIN 5510
Tested to 95/28/EG and DIN 5510

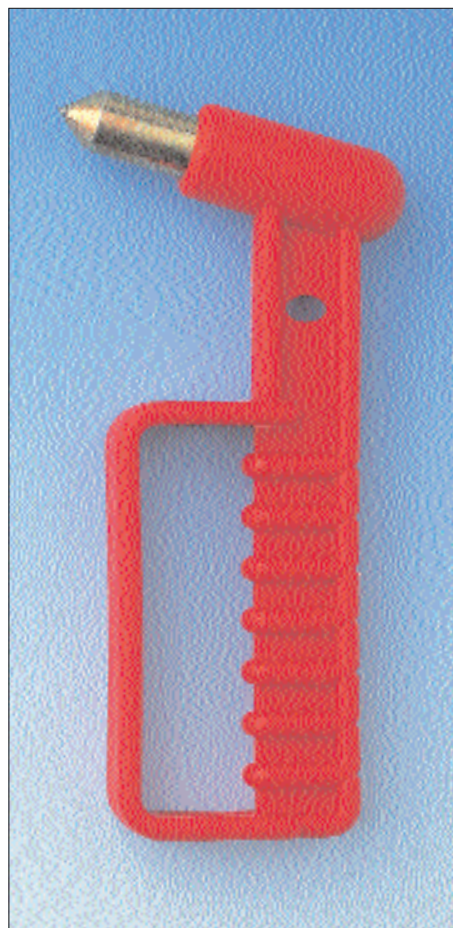
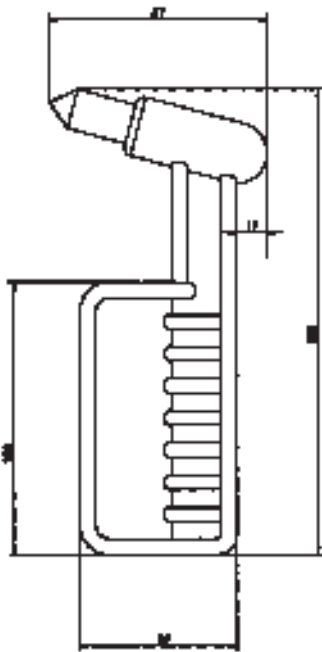
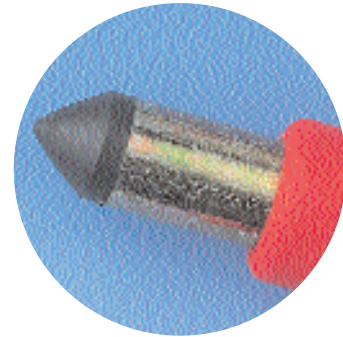

**274 0037
Nothammer**

PP, rot
Stahleinlage: verz., gelb passiviert
Spitze: Hartmetall
180 g/St. VE 10 St.

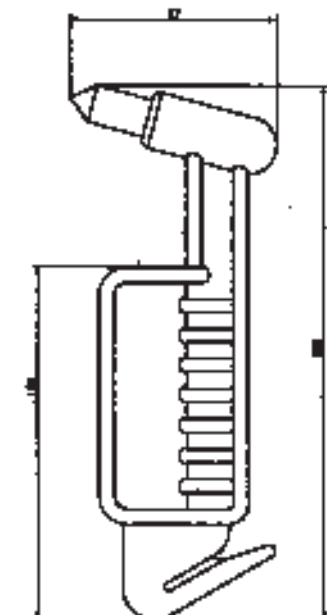

**274 0037
Emergency Hammer**

Red, PP
Steel core: Zinc-plated, yellow passivated
Tip: Toughened metal
180 g/each S.U. 10

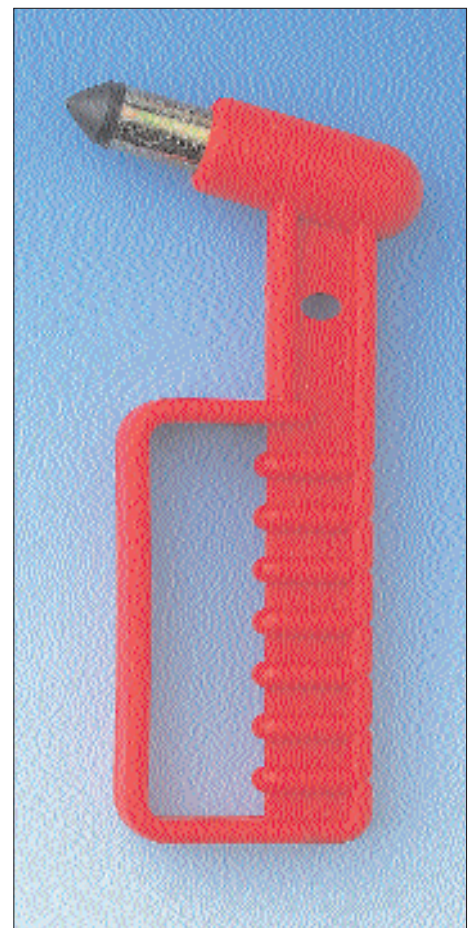

**274 0045
Nothammer mit Vandalismusschutz**

PP, rot
Stahleinlage: verz., gelb passiviert
Spitze: Hartmetall, Schutzkappe aus
elastischem PE-LD-Kunststoff
180 g/St. VE 10 St.

**274 0045
Emergency Hammer with Anti-
Vandalism Feature**

Red, PP
Steel core: Zinc-plated, yellow passivated
Tip: Toughened metal, Protective Capping
made of elastic PE-LD
180 g/each S.U. 10

Nothammer

Emergency Hammer

Auch für den Einsatz im PKW geeignet.
 Also suitable for the use in passenger cars.

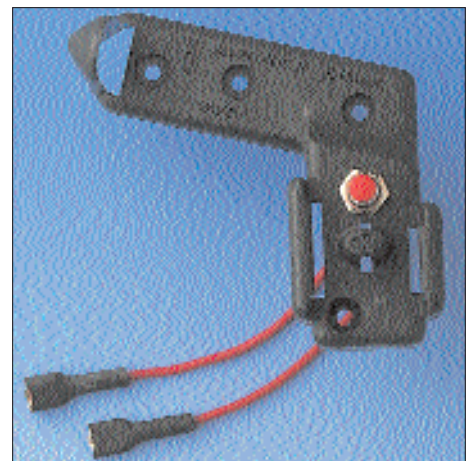
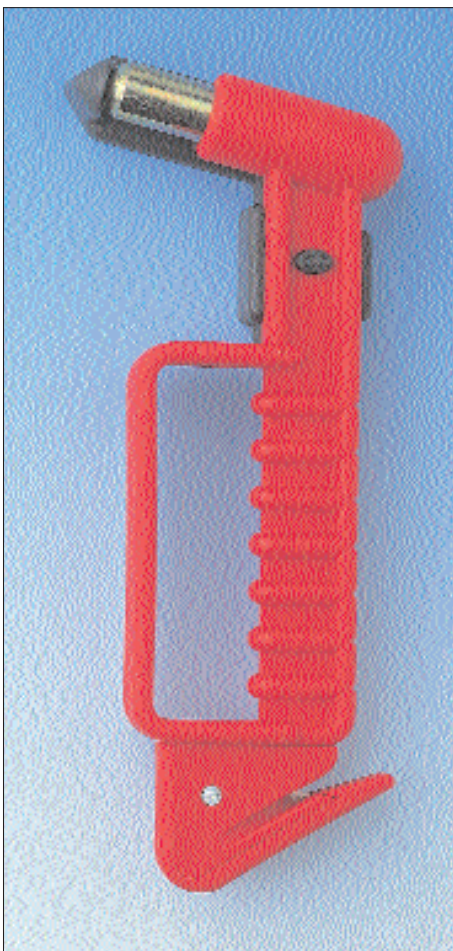

274 0038
Nothammerhalterung
 zu 274 0037 / 0045
 POM, grau
 30 g/St. VE 10 St.

274 0039
Nothammerhalterung
 zu 274 0037 / 0045
mit Drucktaster
 und Kabel zur Signalauslösung
 POM, grau
 40 g/St. VE 10 St.

274 0038
Emergency Hammer Bracket
 for 274 0037 / 0045
 Grey POM
 30 g/each S.U. 10

274 0039
Emergency Hammer Bracket
 for 274 0037 / 0045
with pressure sensor
 and cable to trigger signal
 Grey POM
 40 g/each S.U. 10

274 0043
Nothammer mit Gurtschneider
inkl. Halterung
 PP, rot / POM, grau
 Stahleinlage: verz., gelb passiviert
 Spitze: Hartmetall
 260 g/St. VE 1 St.

274 0043
Emergency Hammer with Seat-Belt
Cutting Blade, incl. Bracket
 Red PP / POM grey
 Steel core: Zinc-plated, yellow passivated
 Tip: Toughened metal
 260 g/each S.U. 1

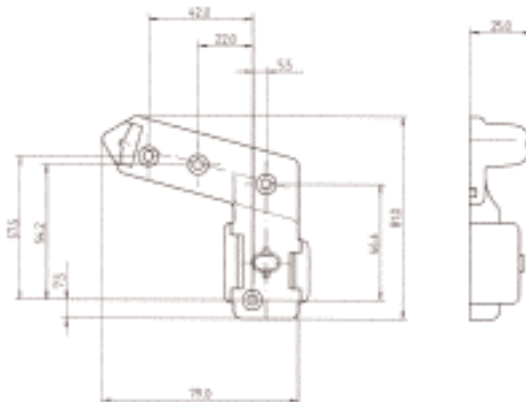

Nothammer mit Diebstahlsicherung

Emergency Hammer with Anti-Theft Feature



Geprüft nach 95/28/EG und DIN 5510
Tested to 95/28/EG and DIN 5510

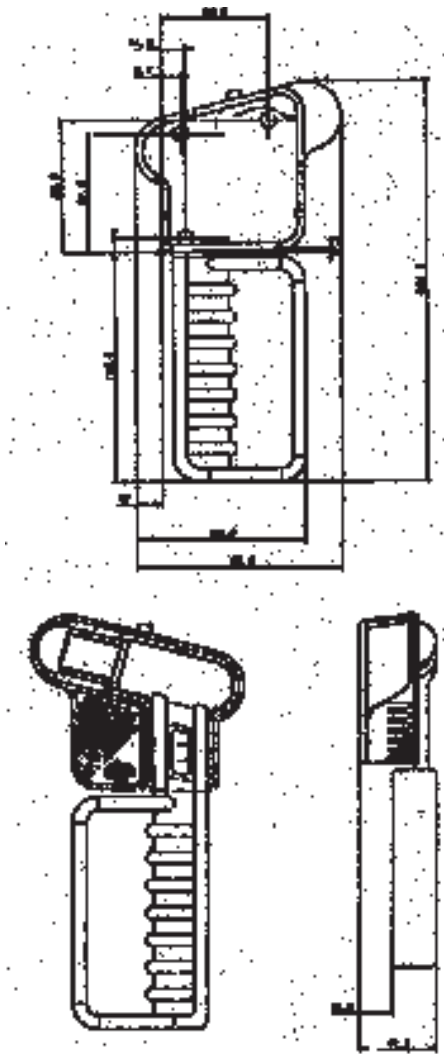

274 0044

Nothammer mit Diebstahlsicherung

PP, rot / POM, grau
Stahleinlage: verz., gelb passiviert
Spitze: Hartmetall
Seillänge: ca. 1500 mm
310 g/St. VE 2 St.

274 0044

Emergency Hammer with Anti-Theft Feature

Red PP / Grey POM
Steel Insert: Zinc-plated, yellow passivated
Tip: Toughened metal
Cable length: approx. 1500 mm
310 g/each S.U. 2

Nothammer mit Diebstahlsicherung

Emergency Hammer with Anti-Theft Feature

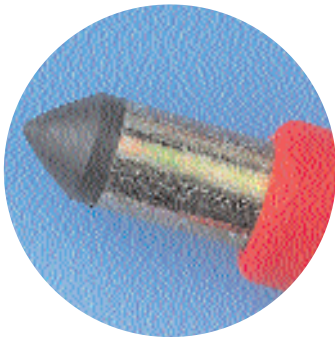

274 0047

Nothammer mit Diebstahlsicherung und Vandalismusschutz

PP, rot / POM, grau
 Stahleinlage: verz., gelb passiviert
 Spitze: Hartmetall, Schutzkappe aus elastischem PE-LD-Kunststoff, Seillänge: ca. 1500 mm
 310 g/St. VE 2 St.

274 0047

Emergency Hammer with Anti-Theft Feature and Anti-Vandalism Feature

Red PP / Grey POM
 Steel Insert: Zinc-plated, yellow passivated
 Tip: Toughened metal, Protective Capping made of elastic PE-LD, Cable length: approx. 1500 mm
 310 g/each S.U. 2



274 0046

Nothammer mit Diebstahlsicherung und Gurtschneider

PP, rot / POM, grau
 Stahleinlage: verz., gelb passiviert
 Spitze: Hartmetall
 Seillänge: ca. 1500 mm
 330 g/St. VE 2 St.

274 0046

Emergency Hammer with Anti-Theft Feature and Seat-Belt Cutting Blade

Red PP / Grey POM
 Steel Insert: Zinc-plated, yellow passivated
 Tip: Toughened metal
 Cable length: approx. 1500 mm
 330 g/each S.U. 2

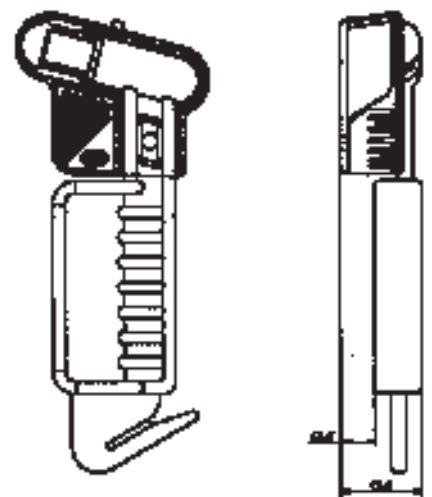
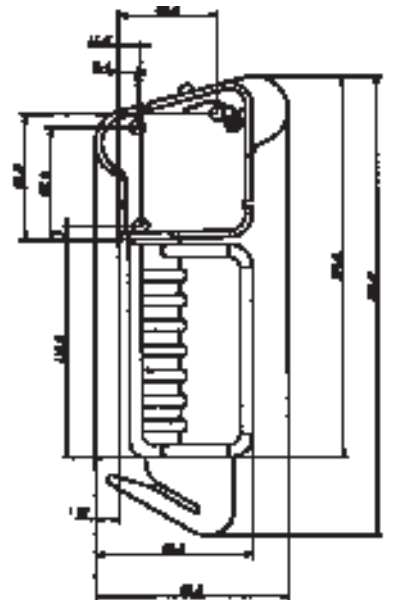

Nothammer mit Diebstahlsicherung
inkl. Drucktaster und Kabel zur Signalauslösung

Emergency Hammer with Anti-Theft Feature
including pressure sensor and cable to actuate signal

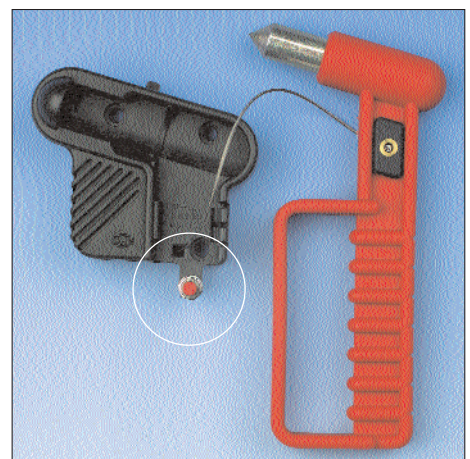
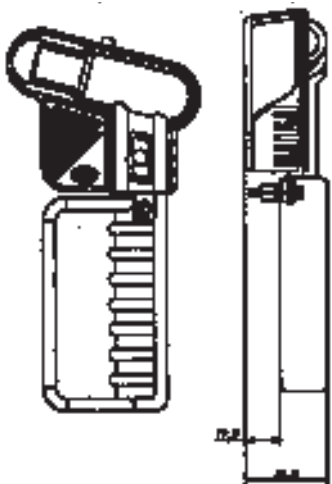
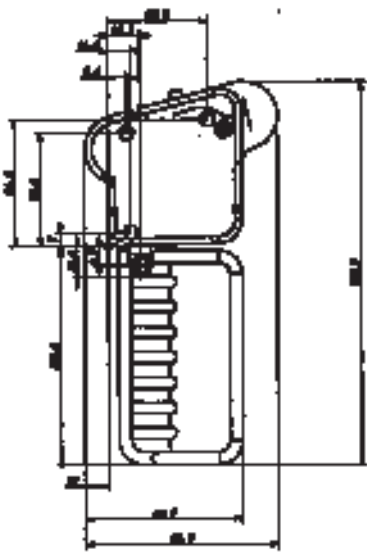

274 0048

Nothammer mit Diebstahlsicherung

inkl. Drucktaster und Kabel zur Signalauslösung,
PP, rot / POM, grau
Stahleinlage: verz., gelb passiviert
Spitze: Hartmetall
Seillänge: ca. 1500 mm
330 g/St. VE 2 St.

274 0048

Emergency Hammer with Anti-Theft Feature

including pressure sensor and cable
to actuate signal, Red PP / Grey POM
Steel Insert: Zinc-plated, yellow passivated
Tip: Toughened metal
Cable length: approx. 1500 mm
330 g/each S.U. 2

Nothammer mit Diebstahlsicherung
inkl. Drucktaster und Kabel zur Signalauslösung

Emergency Hammer with Anti-Theft Feature
including pressure sensor and cable to actuate signal

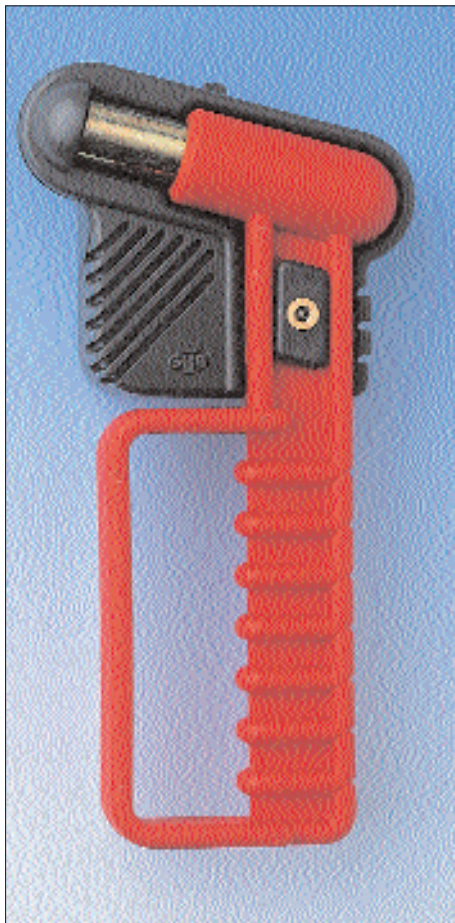
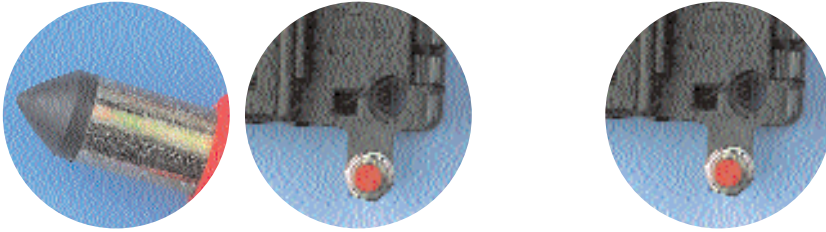

274 0049

Nothammer mit Diebstahlsicherung und Vandalismusschutz

inkl. Drucktaster und Kabel zur Signalauslösung, PP, rot / POM, grau
Stahleinlage: verz., gelb passiviert
Spitze: Hartmetall, Schutzkappe aus elastischem PE-LD-Kunststoff, Seillänge: ca. 1500 mm
330 g/St. VE 2 St.

274 0049

Emergency Hammer with Anti-Theft Feature and Anti-Vandalism Feature

including pressure sensor and cable to actuate signal, Red PP / Grey POM
Steel Insert: Zinc-plated, yellow passivated
Tip: Toughened metal, Protective Capping made of elastic PE-LD, Cable length: approx. 1500 mm
330 g/each S.U. 2



274 0050

Nothammer mit Diebstahlsicherung und Gurtschneider

inkl. Drucktaster und Kabel zur Signalauslösung, PP, rot / POM, grau
Stahleinlage: verz., gelb passiviert
Spitze: Hartmetall, Seillänge: ca. 1500 mm
350 g/St. VE 2 St.

274 0050

Emergency Hammer with Anti-Theft Feature and Seat-Belt Cutting Blade

including pressure sensor and cable to actuate signal, Red PP / Grey POM
Steel Insert: Zinc-plated, yellow passivated
Tip: Toughened metal
Cable length: approx. 1500 mm
350 g/each S.U. 2

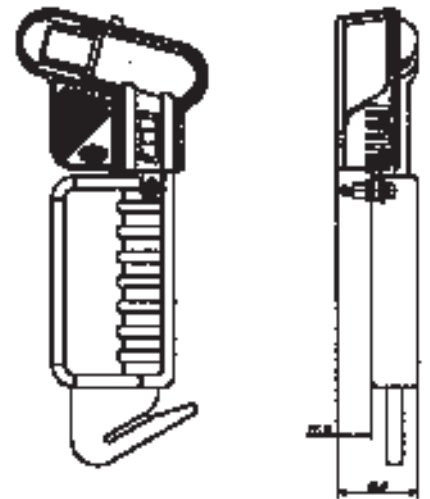
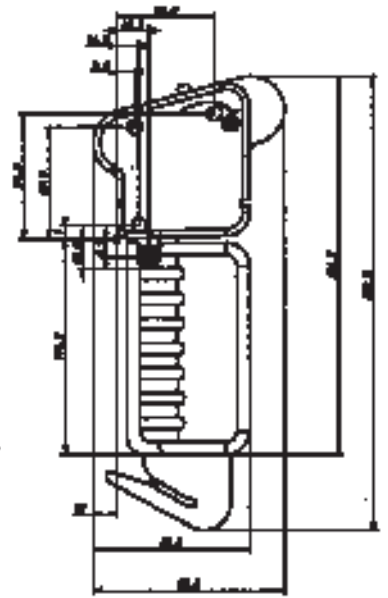

Nothammer

Emergency Hammer



Geprüft nach 95/28/EG und DIN 5510
 Tested to 95/28/EG and DIN 5510

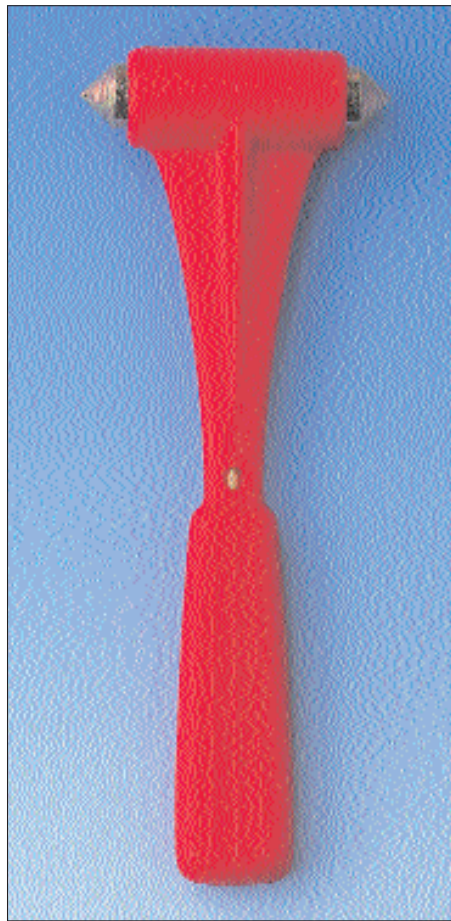
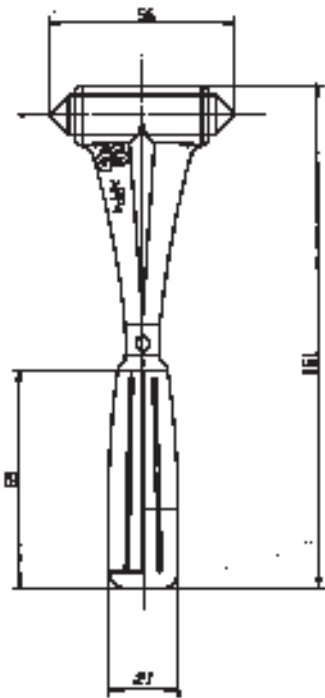

274 0009

Nothammer

PP, rot
 Stahleinlage: verz., gelb passiviert
 Spitze: gehärtet
 72 g/St. VE 10 St.

274 0009

Emergency Hammer

Red PP
 Steel Insert: Zinc-plated, yellow passivated
 Tip: Toughened metal
 72 g/each S.U. 10



274 0010

Nothammerhalterung

zu 274 0009
 PP, grau
 12 g/St. VE 10 St.

274 0010

Emergency Hammer Bracket

for 274 0009
 Grey PP
 12 g/each S.U. 10

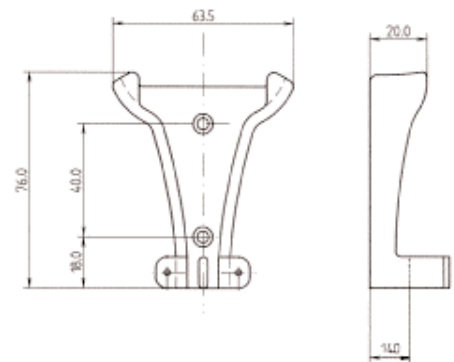

Anwendungsbeispiel

Example of possible Application

Die Montageposition des Nothammers mit Halterung befindet sich in Reisebussen, Bussen und Bahnen des öffentlichen Personenverkehrs an den Säulenverkleidungen der Seitenfenster, die mit dem Hinweis „Notausstieg“ gekennzeichnet sind.

Die Abbildungen zeigen den Happich-Nothammer im Mercedes-Benz Reisebus O 404.

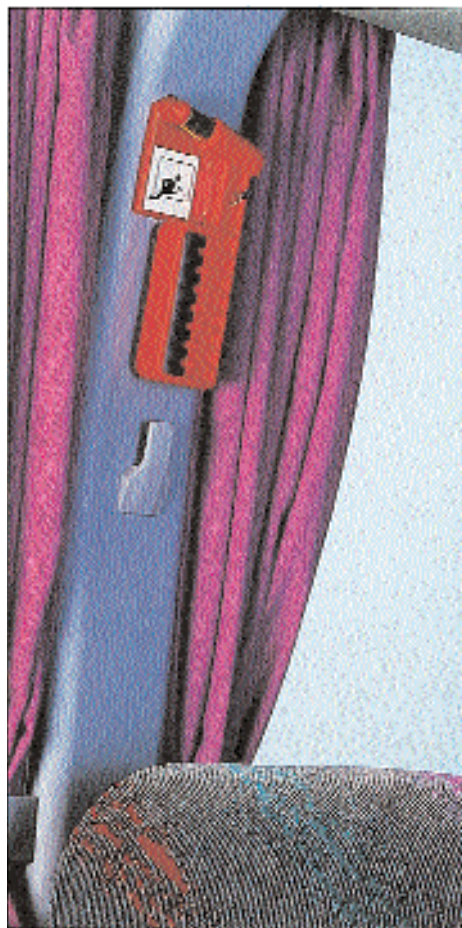

The emergency hammer is situated together with its support bracket in buses and coaches, as well as railway carriages and other public transportation, on the post covers of the side windows marked "Emergency Exit".

The illustrations show the Happich emergency hammer in a Mercedes-Benz O 404 coach.



General Terms and Conditions of Sale with Data Processing License of HAPPICH Fahrzeug- und Industrieteile GmbH

Stand as of 01/01/2002

1. Exclusive validity and acknowledgement of our General Terms and Conditions of Sale:

1.1. All of our offers are based on our General Terms and Conditions of Sale. The acceptance of all purchase orders shall be subject to these terms and conditions. Any other general terms and conditions of the purchaser or regulations by the purchaser, which are not in conformance with our General Terms and Conditions of Sale or agreements, shall only be binding if they have been expressly acknowledged by us in writing.

1.2. Upon placement of the order or acceptance of delivery, the purchaser shall acknowledge the validity of our General Terms and Conditions of Sale, both for the particular transaction in question, as well as for all future transactions.

2. Offers – Subsidiary Agreements – Content of Agreement

2.1. Our offers shall be without obligation, meaning that an agreement shall only come into existence at the time when we accept the purchase order. We may accept the purchase order within a time period of three weeks after receipt of same.

2.2. Subsidiary agreements to our offers and confirmations of orders, as well as agreements entered into with our traveling representatives and agents, must be confirmed by us before they shall become valid.

2.3. In cases of doubt, only our expressed written confirmation of the order shall be binding with regard to the content of the agreement.

3. Prices

3.1. Our prices shall apply for the delivery ex works or warehouse exclusive of freight, packaging, insurance, customs and other fees and excluding value added tax, unless we have expressly indicated that a specified price shall include the value added tax.

3.2. The stipulated prices are based on the applicable wage, material and energy costs at the time the agreement is entered into. Should these costs increase before the time at which the order is actually carried out, we reserve the right to charge a price that has been respectively increased over the stipulated price, based on the percentage share of these costs.

4. Shipping

Unless we receive special shipping stipulations, the products shall be shipped in accordance with the shipping method deemed most appropriate in our estimation. The product shall be shipped to the account and at the risk of purchaser. If products are to be shipped to the purchaser upon the purchaser's request, any risk of incidental destruction or incidental deterioration of the product shall be transferred to the purchaser upon delivery of the product to the company commissioned to handle the shipment, at the latest however upon leaving the plant or warehouse, regardless of whether the shipment is carried out from the place of fulfillment, or whether the supplier carries out the shipment through the services of a vicarious agent and regardless of who is responsible for the transportation costs. If the product is ready for shipment and if the shipment or the acceptance of shipment is delayed for reasons falling outside our area of responsibility, then the risk shall be transferred to the purchaser at the time of receipt of notice that the order is ready for shipment.

5. Delivery dates and deadlines

5.1. Agreed delivery dates and deadlines for our deliveries shall not be construed as a transaction for delivery by a fixed date as specified in § 376 (1) of the German Commercial Code.

5.2. A delivery date or delivery deadline shall be deemed met if the product has left our delivery plant or warehouse upon expiration of the delivery date. In the case of the forwarding option, timely notification of readiness to ship vis-à-vis the purchaser is sufficient.

5.3. In the event of unforeseen obstacles that cannot be avoided despite reasonable effort to comply with the specific conditions at hand – whether they may arise within our operations or at those of one of our suppliers – such as force majeure, intervention by official authorities, energy supply difficulties, strike or lock-out, the delivery date shall be extended accordingly – even within the time period of a delay in delivery. We shall advise the purchaser immediately in the event of any such circumstances. The right to appropriate, as well as timely independent deliveries shall be reserved. Revisions to the delivery agreement, which impact the delivery date, shall affect an appropriate extension of the delivery date. An obstacle that exceeds a period of three months with no specific end in sight shall grant the purchaser and us the right to withdraw from the agreement, if the agreement cannot be honoured by us as a result of the obstacle.

5.4. If we find that there will be a delay in the delivery, the purchaser may withdraw from the agreement, provided he has granted us a suitable grace period in writing of at least four weeks and provided that the product has not left the delivery plant or warehouse at the expiration of this time period. If the forwarding option has been selected, the timely notification of readiness to ship vis-à-vis the purchaser is sufficient.

5.5. We shall only be held liable for damages related to delay or impossibility of performance to the extent to which the damages are the result of a deliberate action or due to gross negligence on the part of our management or one of our employees. Under all other circumstances the purchaser shall have the exclusive right of rescission.

6. Liability for Defect

We shall assume the following warranty:

6.1. The purchaser shall notify us immediately in writing upon discovery of any defects in the delivered products. The notification period for defects that can be detected in the course of a normal business transaction investigation is a maximum of one week and for other defects a maximum of twelve months from receipt of the product by the purchaser. If the purchaser should fail to provide immediate or timely notification of a defect, or if the product is modified after the defect has been detected or could have been detected, the purchaser shall thereby lose all warranty rights.

6.2. A defect of a portion of the delivered products does not entitle the purchaser to reject the entire delivery.

6.3. In cases where a duly reported notification of defect is justified and if requested by us, the purchaser shall return the rejected product at our expense. In this case we shall deliver a replacement product in flawless condition, but only – in the event that we have requested the return of the rejected product – after we have received said returned product. Instead of providing a replacement product, we may also select the option of providing a reworking of the defective product. Should the delivery of a replacement and/or reworked product fail or not be possible or reasonable, then we shall have the option of either withdrawing from the agreement with regard to the defective product or of lowering the purchase price. The purchaser may impose in writing a time period of ten days in which we are to exercise this option, which shall begin at that point in time when we shall receive back the defective product, at the earliest. If we should fail to exercise this option within the designated time period, it shall be transferred to the purchaser.

If the reworked or replacement product should prove unsuccessful, the purchaser may request, at his option, either a reduction of the purchase price or a withdrawal from the agreement. The same shall apply if we should experience a delay in the delivery of the reworked or replacement product and not be able to provide said services within the rescheduled period of an additional four weeks.

6.4. In the event of delivery of rubber profiles, the guidelines as specified in DIN 7716 shall apply for the storage, maintenance and repair and cleaning of the product. We shall not accept responsibility for any damages resulting from non-compliance with this regulation.

6.5. Liability for defects for the delivered products as outlined in the above paragraphs shall be final. Ongoing warranty claims, in particular claims for damages, shall be excluded unless the damage in this case is based on an intentional act or gross negligence of our management or of one of our employees. This shall apply also in the case of a delivery of replacement product or the reworking of a defective product.

6.6. The subject matter of the agreement shall pertain exclusively to the products sold with its respective properties and features, as well as the intended use in accordance with the accompanying product description and/or according to the specifications in our sales brochures. Other or ongoing properties and/or features or an intended use that is over and above that proposed shall only then be deemed approved if expressly confirmed by us in writing.

6.7. Under no circumstances shall we assume responsibility that the product ordered will be suitable for its intended use by purchaser, or that it can be used or processed under the conditions as set forth by the purchaser or his sub-purchaser, but rather it is the purchaser's own responsibility to check this on his own before the respective application or processing. We shall not be responsible for errors which may arise from the documentation submitted by purchaser (drawings, models and the like).

6.8. In the event that the purchase of our products is intended for subsequent sale to third parties, the purchaser shall be obligated to pursue the appropriate advertising for the product. The purchaser shall be aware that any improper advertising with regard to properties of the product could lead to claims for damages. The purchaser agrees to indemnify us against any consequences such advertising may cause and he shall be further obligated to repay any claims for damages against us that may arise as a result of the violation of this obligation.

7. Limitation of liability

In the event of a merely negligent violation of obligation by us or by our agents, our liability shall be limited to the foreseeable damages typical of the contract. In any event our liability according to the product liability law and other claims shall remain unaffected.

8. Invoicing – Payment

8.1. We issue invoices as soon as the ordered products are ready for shipment or ready to be picked up. Delays in shipment or in the collection of the products that are not our responsibility shall not postpone the due date of the invoice.

8.2. Where not otherwise stipulated, our invoices shall be due within 30 days after the date of invoice. If purchaser pays the entire invoice in cash or by check within 8 days after the date of invoice, he shall be entitled to a 2% discount. The discount shall be granted only on the actual value of the product invoice itself and not on the value added tax. A discount reduction will not be granted if the purchaser has outstanding accounts payable that are due to us and that are not fulfilled at the same point in time at the latest.

8.3. If after entering into the agreement circumstances should become known to us which put the purchaser's credit worthiness in question, we may at our option demand either cash in advance or collateral. The same shall apply if the purchaser does not meet an incumbent payment obligation due to us by the due date. If either of these situations should arise, the sum total of our accounts receivable due from the purchaser, even from other business transactions, shall become due immediately. In cases where we may have accepted checks or bills that are not yet due, we shall be able to demand immediate payment upon return of the bill.

8.4. If the purchaser fails to pay by the due date, we may charge interest in the amount of the costs of the current credit of our house bank, up to a maximum of 8 percentage points above the current basic interest rate of the European Central Bank. The purchaser may present evidence, however, that we have not suffered any loss or that our loss is substantially lower than the lump sum amount.

8.5. In cases where we accept checks or bills, this shall always be done for the sake of payment only but not in place of settlement. In these instances we do not need to vouch for timely payment or acts of protest. The costs of discounting, payment for taxes and forfeiture are to be borne by the purchaser, who must repay these amounts immediately upon request.

8.6. The purchaser shall only be entitled to offset rights if his counterclaims are determined to be final and absolute, undisputed or acknowledged by us. The purchaser shall only be entitled to a right of retention insofar as his counterclaim is based on the same contractual relationship.

9. Retention of title

9.1. The products delivered by us shall remain our property until such time as full redemption of all outstanding accounts receivable arising from the contractual relationship with the purchaser, including those in a current invoice status, shall be made. Cash payments, bank transfers and payments by check, which are transacted based on the transmittal of a bill issued by us and accepted by purchaser, shall only be considered as payment in accordance with Item 8.5 Clause 1, when the bill from the purchaser/acceptor has been cashed and when we as issuers are completely released from the liability of the bill.

9.2. Any acquisition of title by the purchaser in the handling or processing of the products delivered by us shall be excluded. Any eventual handling or processing of the reserved property by the purchaser for us shall not incur any type of liability to us as a result. In the event that our reserved property shall be processed with other objects not belonging to us, we shall acquire co-ownership of the new item in proportion to the other processed objects at the time of processing. In the event that the item supplied by us shall be inseparably combined, mixed or blended with other items not belonging to us, then we shall acquire co-ownership of the new item in proportion to the value of the reserved property to the other combined, mixed or blended objects at the time of the combining, mixing or blending. If the combining, mixing or blending shall occur in such a way, that the item of purchaser comes to be viewed as the main item, then it shall be hereby stipulated that the purchaser will transfer co-ownership to us on a proportional basis. The purchaser shall keep the sole ownership or co-ownership property that shall be brought about in this way in custody for us.

9.3. All accounts receivable of the purchaser arising from a further sale of products for which we have ownership or co-ownership, shall be transferred from the purchaser to us already at this time, whereby we thus accept this transfer, regardless of whether the product is sold without or after handling or processing or combining or whether it is sold to one or several sub-purchasers. In those cases where the products sold do not completely belong to us, or where they are sold together with products not belonging to us, the transfer shall include the counterclaim in the amount of the invoiced value of our products only. The purchaser may collect the transferred accounts receivable but may not transfer them, not even in a factoring transaction. We can recall this authority if the purchaser does not fulfill an obligation incumbent upon him on our behalf in a punctual manner, or if circumstances should become known to us which may cause our rights to appear jeopardized. The collection authority of the purchaser shall automatically expire if the purchaser stops payment, is called before the court for disclosure of his financial circumstances, or if legal conciliation or bankruptcy proceedings are initiated with regard to his property, or if he is endeavoring to reach settlement out of court.

At our request the purchaser must report the act of transfer of the transferred accounts receivable to the debtors, notify us of the debtors and of the amounts owed them, and deliver to us the documents required for the enforcement of the transferred accounts receivable.

9.4. The purchaser may only sell, handle, process or combine products of other origin with products that are within our ownership or co-ownership (reserved property) within the scope of normal business operations. Disposition of the product is only permissible by way of sale and only with the provision that the accounts receivable of the purchaser from the disposition transaction, as specified above, be transferred to us. The purchaser shall not be authorized to arrange for other disposals of our products, and may not pledge them nor assign them by way of security. The purchaser must notify us immediately of any impending or already completed access by third parties to the reserved property or transferred accounts receivable. Any costs incurred to us from the intervention shall be borne by purchaser.

9.5. Should the purchaser be in default in the fulfillment of an obligation secured by the retention of title, either in whole or in part, or should we be made aware of circumstances which cause our rights to appear jeopardized, we shall be able to demand the surrender of the products delivered by us, without the need to have previously declared withdrawal from the sales contract according to § 449 (2) BGB (German Civil Code) or to have set a deadline for fulfillment of the payment obligation according to § 323 (1) BGB. The continuance of the sales contract and the obligations of purchaser shall remain unaffected by any such demand and surrender of products. If the conditions of § 323 (1) BGB are given, then we shall have the right to claim damages from the purchaser for non-fulfillment in the amount of 25% of the invoice amount of the products. This shall not rule out the presentation of evidence of damages of a lower amount by purchaser or of a higher amount by us.

9.6. The retention of title is subject to a condition subsequent, so that upon full payment of all of our accounts receivable from the business relation, the ownership of the reserved property shall transfer to the purchaser and the transferred accounts receivable shall fall to him without delay. We shall undertake to release the collateral due (products and receivables) according to the above regulations at our option insofar as their value exceeds the claims being secured by more than 20%.

10. Data Processing License

We shall have the right to process all of the legally protected data pertaining to the purchaser within the scope of the relevant statutory regulations.

11. Place of Performance – Place of Jurisdiction – Applicable Law

11.1. The place of performance for the delivery or service to be provided by us is the principal place of business of our respective plant.

11.2. The exclusive place of jurisdiction for all disputes from and regarding the agreement, as well as for bill and check procedures, shall be Wuppertal (Germany). We also reserve the right, however, to bring an action against purchaser at another place of jurisdiction having validity for purchaser. In cases where the purchaser is not a businessman, a legal entity of public law or a separate estate under public law, but has a general domestic place of jurisdiction, these provisions shall apply in cases where the purchaser transfers his principal place of business or habitual residence from the Federal Republic of Germany, or if his principal place of business or habitual residence is not known at the time the action is brought forward.

11.3. For foreign business transactions the entire contractual relationship shall be subject to the laws of the Federal Republic of Germany, provided it is not mandatory that a different legal system intervenes. The validity of the Uniform Law regarding international purchase of mobile goods and the Uniform Law regarding entering into international sales contracts for mobile goods is excluded.

12. Partial Ineffectiveness

If individual provisions of these General Terms and Conditions of Sale, for whatever reason, are or become ineffective, the effectiveness of the remaining provisions shall remain unaffected. Ineffective clauses shall be replaced by new clauses that come closest to those which are desired by the contractual parties.



► **Produktions- und Vertriebs-
gesellschaften / Production- and
Distribution Companies**

HAPPICH Profile GmbH
Deutschland / Germany

HAPPICH Interiors GmbH
Deutschland / Germany

HAPPICH PLZEN s.r.o.
Tschechische Republik /
Czech Republic

HAPPICH PROFILES Ltd.
Großbritannien / U.K.

HAPPICH-SIRPAUTO S.A.
Frankreich / France

HAPPICH Vehicle and
Industrial Components Ltd.
Großbritannien / U.K.

HAPPICH POLSKA Sp.z o.o.
Polen / Poland

HAPPICH-ROKO Fahrzeug-
und Industrieteile GesmbH
Österreich / Austria

GHE Iberica S.L.
Spanien / Spain

GHE OTOMOTIV SAN. VETIC. A.S.
Türkei / Turkey



Kontakt / Contact

HAPPICH Fahrzeug-
und Industrieteile GmbH
Konsumstraße 45
42285 Wuppertal
Deutschland / Germany

Telefon +49 (0)202.8703-0
Telefax +49 (0)202.8703-599

www.happich.com